

NAME OF CLAIMANT

#36 - Hensley, A. L. & Clinton

Number of Acres: 96

Location: North, south, east and part of the west slopes of a mountain south of Dry Run.

Roads: Five miles of good country road to Elkton.

Soil: Shallow, gravelly loam. Stony to nearly all loose rock.

Improvements: None.

History of Tract and condition of timber: Hard cut and hard burned repeatedly. At least 1/2 was skinned recently, the last cutting being in 1930. Originally oak, chestnut stand with springling of pine and mixed hardwoods. Reproduction is plentiful, consisting mostly of oak sprouts. There is a light cord wood stand upon less than half the area, being not over 2 cords per acre for whole area of tract of which 3/4 is pitch-pine and dead chestnuts. There is a small amount of chestnut oak on the top of ridge, next to the **Improvements:** last cutting. Estimated to cut 2 cords per acre over an area of 96 acres totaling 192 cords. Slopes are moderate to very steep. Most of the wood now standing is on hard ground to log because of steepness and abundance of loose rock.

Acreage and value of types:

Types	Acreage	Value per acre	Total Value
-------	---------	----------------	-------------

Ridge:

Slope:	96	\$3.00	\$288.00
--------	----	--------	----------

Cove:

Grazing Land:

Fields Restocking:

Cultivated Land:

Orchard:

Minerals:

Value of Land: \$ 288.00

Value of Improvements: \$

Value of Orchard: \$

Value of Minerals: \$

Value of Fruit: \$

Value of Timber: \$

Value of Wood: \$

Value per acre for tract: \$3.00

Incidental damages arising from the taking of this tract: \$ NONE.

Geo. N. Pen

CLERK.

REPORT ON THE ACREAGE

of the

A. L. & Clinton Hensley Tract #36.

The deed conveying this land to A. L. and Clinton Hensley gives a very indefinite and general description without bearings and distances, and without giving any acreage; referring to it as the remaining portion of a tract composed of Stephen and Edward Hensley's interest in the estate of their father, William Hensley.

The records do contain descriptions of all of the tracts adjoining tract #36. A computation of the acreage of this tract by the bearings and distances given in the boundaries of adjoining tracts gives 96 acres.

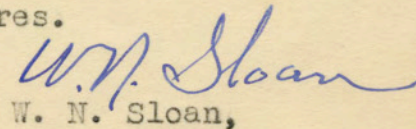
W. N. Sloan,

Chief Engineer, Park Service.

County: Rockingham
District: Stonewall

#36 - Hensley, A. L. & Clinton

Acreage Claimed: Assessed x 112 A. Deed Area in doubt.
Value Claimed: " \$390.00 " Acquired for \$1.00 and other considerations.

Location: North, south, east and part of the west slopes of a mountain south of Dry run.

Incumbrances, counter claims or laps: None known.

Soil: Shallow, gravelly loam. Stony to nearly all loose rock.

Roads: Five miles of good country road to Elkton.

History of tract and condition of timber: Hard cut and hard burned repeatedly. At least one-half was skinned recently, the last cutting being in 1930. Originally oak, chestnut stand with sprinkling of pine and mixed hardwoods. Reproduction is plentiful, consisting mostly of oak sprouts. There is a light cord wood stand upon less than half the area, being not over 2 cords per acre for whole area of tract of which three-fourths is pitch-pine and dead chestnuts. There is a small amount of chestnut oak on the top of ridge, next to the last cutting. Estimated to cut 2 cords per acre over an area of 96 acres totaling 192 cords. This is included in the per acre value. Slopes are moderate to very steep. Most of the wood now standing is on hard ground to log because of steepness and abundance of loose rock.

Improvements: None.

Acreage and value of land by types:

Type	Acreage	Value per A.	Total Value
Slopes	96	3.00	\$288.00

Total value of land - - \$288.00

Total value of tract - \$288.00

Average value per acre \$3.00

xNote: For discrepancy in acreage, refer to abstract of title.

15

County: Rockingham
District: Stonewall

#36- Hensley, A.L. & Clinton

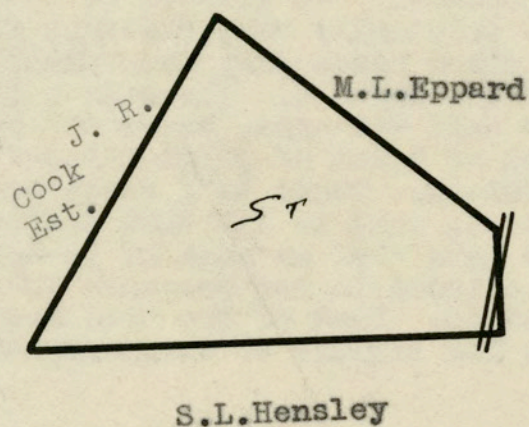
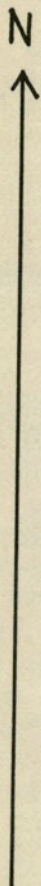

LEGEND:
Slope
Scale - 1" = 20 chains