

NAME OF CLAIMANT

#250 - Shifflett, W. A.

Number of Acres: 15

Location: On Mile Run. This tract is entirely inside the Park area.

Roads: Two miles over county road to Island Ford.

Soil: Slope.

History of Tract and condition of timber: All merchantable timber has been removed.

Improvements: NONE.

Acreage and value of types:

Types	Acreage	Value per acre	Total Value
-------	---------	----------------	-------------

Ridge:

Slope:	15	\$5.00	\$75.00
--------	----	--------	---------

Cove:

Grazing Land:

Fields Restocking:

Cultivated Land:

Orchard:

Minerals:

Value of Land: \$ 75.00

Value of Improvements: \$

108.00
<u>\$183.00</u>

Value of Orchard: \$

Value of Minerals: \$

Value of Fruit: \$

Value of Timber: \$ 108.00

Value of Wood: \$

Value per acre for tract: \$ 12.20

Incidental damages arising from the taking of this tract: \$ NONE.

Geo. N. Linn CLERK.

Claim of W. A. Shifflett
In the Circuit Court of Rockingham County, Virginia, No. _____, At Law.
The State Commission on Conservation and Development of the State of Virginia, Petitioner, vs. _____

more or less, of land in Rockingham County, Virginia, Defendants.
The undersigned, in answer to the petition of the State Commission on Conservation and Development of the State of Virginia, and in response to the notice of condemnation awarded upon the filing of said petition and published in accordance with the order of the Circuit Court of Rockingham County, Virginia, asks leave of the Court to file this as his answer to said petition and to said notice.

My name is W A Shifflett
My post office address is Elkton Va RFD RFD No 4

I claim a right, title, estate or interest in a tract or parcel of land within the area sought to be condemned, containing about 2.0 acres, on which there are the following buildings and improvements: None

This land is located about 2 miles from Island Ford Virginia, in the Stonewall Magisterial District of said County.

I claim the following right, title, estate or interest in the tract or parcel of land described above: (In this space claimant should say whether he is sole owner or joint owner, and if joint owner give names of the joint owners. If claimant is not sole or joint owner, he should set out exactly what right, title, estate or interest he has in or to the tract or parcel of land described above.)
sole owner
by purchase with fee simple title from Jno L Roach

The land owners adjacent to the above described tract or parcel of land are as follows:
North Howard Raines
South M H Harrison
East Jno King
West Geo Dugins

I acquired my right, title, estate or interest to this property about the year 1918 in the following manner:
by deed as aforesaid

I claim that the total value of this tract or parcel of land with the improvements thereon is \$ 500. I claim that the total value of my right, title, estate or interest, in and to this tract or parcel of land with the improvements thereon is \$ 500.

I am the owner of 1.0 acres of land adjoining the above described tract or parcel of land but lying outside the Park area, which I claim will be damaged by the proposed condemnation of lands within the Park area, to the extent of \$ 500.

(In the space below should be set out any additional statements or information as to this claim which claimant desires to make; and if practicable he should also insert here a description of the tract or parcel of land by metes and bounds).

Remarks: My home place is nearby and this land is my only source for my fire wood. I estimate that the tract produces 25 cord of fire wood per acre.

(Continue remarks if necessary on the back).

Witness my signature (or my name and mark attached hereto) this 16th day of Feby 1931, 1930. W. A. Shifflett

STATE OF VIRGINIA, COUNTY OF Rockingham, To-wit:

The undersigned hereby certifies that W. A. Shifflett the above named claimant personally appeared before him and made oath that the matters and things appearing in his above answer are true to the best of his knowledge and belief, this 16th day of Feby 1931, 1930.

[Signature]
Clerk of the Court, or Special Investigator or Notary Public, or Justice of the Peace.

Filed 2/16/31
JTB

Claim of Mrs. W. A. Shiflett
In the Circuit Court of Rockingham County, Virginia, No. _____, At Law.
The State Commission on Conservation and Development of the State of Virginia, Petitioner, vs. Mrs. W. A. Shiflett
10 acres

more or less, of land in Rockingham County, Virginia, Defendants.
The undersigned, in answer to the petition of the State Commission on Conservation and Development of the State of Virginia, and in response to the notice of condemnation awarded upon the filing of said petition and published in accordance with the order of the Circuit Court of Rockingham County, Virginia, asks leave of the Court to file this as his answer to said petition and to said notice.

My name is Mrs. W. A. Shiflett
My post office address is Elkton, Va. R. F. D. 4

I claim a right, title, estate or interest in a tract or parcel of land within the area sought to be condemned, containing about 10 acres, on which there are the following buildings and improvements: None

This land is located about 3 miles from Elkton Virginia, in the Stonewall Magisterial District of said County.

I claim the following right, title, estate or interest in the tract or parcel of land described above: (In this space claimant should say whether he is sole owner or joint owner, and if joint owner give names of the joint owners. If claimant is not sole or joint owner, he should set out exactly what right, title, estate or interest he has in or to the tract or parcel of land described above.)

I am the sole owner

The land owners adjacent to the above described tract or parcel of land are as follows:
North Mrs. W. A. Shiflett
South G. Frank Shiflett
East C. O. Shiflett
West Public Road

I acquired my right, title, estate or interest to this property about the year 1910 in the following manner:
Annie C. Davis, and Florence R. Moubry

I claim that the total value of this tract or parcel of land with the improvements thereon is \$ 400.00. I claim that the total value of my right, title, estate or interest, in and to this tract or parcel of land with the improvements thereon is \$ 400.00.

I am the owner of 50 acres of land adjoining the above described tract or parcel of land but lying outside the Park area, which I claim will be damaged by the proposed condemnation of lands within the Park area, to the extent of \$ 150.00.

(In the space below should be set out any additional statements or information as to this claim which claimant desires to make; and if practicable he should also insert here a description of the tract or parcel of land by metes and bounds).

Remarks: would not be any fire wood for the farm if this tract or parcel of land is taken

(Continue remarks if necessary on the back).

Witness my signature (or my name and mark attached hereto) this 14th day of Aut, 1930. Geo E Shiflett Mrs. W. A. Shiflett
STATE OF VIRGINIA, COUNTY OF Rockingham, To-wit:

The undersigned hereby certifies that Mrs. W. A. Shiflett the above named claimant personally appeared before him and made oath that the matters and things appearing in his above answer are true to the best of his knowledge and belief, this 14th day of Aut, 1930.

M. M. Mancy
Clerk of the Court, or Special Investigator or Notary Public, or Justice of the Peace.

2/14/31

County: Rockingham
District: Stonewall

#250 - W. A. Shifflett

<u>Acreage Claimed:</u> 29 A.	Assessed 15 acres	Deed	(acquired 15 A. 1918)
<u>Value Claimed:</u> \$500.	" \$60.00	"	For \$100.00

Location: On Mile Run. This tract is entirely inside the Park area.

Laps:

Soil: Slope.

Roads: 2 miles over county road to Island Ford.

History: All merchantable timber has been removed.

Improvements: None.

Timber: 144 cds. of fuel wood @ 75¢ per A ----- \$108.00

Value of land by types:

<u>Type</u>	<u>Acreage</u>	<u>Value per acre</u>	<u>Total Value</u>
Slope	24	\$5.00	\$120.00

Total value of land \$120.00

Total value of improvements

Total value of timber 108.00

Total value of tract 228.00

Average value per acre 9.50

#25 Shifflett, W. A.

County: Rockingham
District: Stonewall

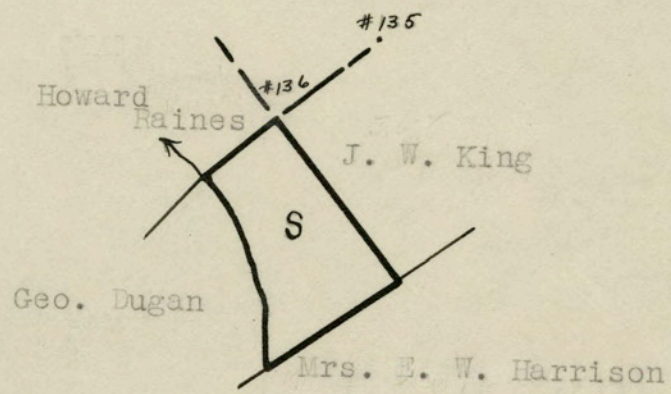

LEGEND

Slope

Scale - 1" = 20 chains