

NAME OF OWNER

#125 - Dearing, Sarah

Number of Acres: 1

Location: On South Naked Creek at Positions 537 to 2, lying in Page and Rockingham Counties, and partly outside Park area.

Roads: Five miles, two and one-half of which are paved to Elkton, nearest shipping point.

Soil: (See reverse side)

History of Tract and condition of timber: Tract has been cut over for farm use for many years. There is good white and red oak to 10" DBH. On 17 acres in Page county the estimate is 85 cords of fuel wood.

Improvements: None.

Acreage and value of types:

Types	Acreage	Value per acre	Total Value
Ridge:			
Slope:			
Cove:	1 @	\$10.00	\$10.00

Grazing Land:

Fields Restocking:

Cultivated Land:

Orchard:

Minerals:

Value of Land: \$ 10.00

Value of Improvements: \$

Value of Orchard: \$

Value of Minerals: \$

Value of Fruit: \$

Value of Timber: \$

Value of Wood: \$

Value per acre for tract: \$ 10.00

Incidental damages arising from the taking of this tract: \$ None.

Geo. H. Pen:

CLERK.

SOIL

.... Sandy loam of good depth and fertility with much loose rock. There is a great deal of large rock along the creek. The fields are poor with small loose rock. The land along the creek is fairly level and the remainder has a gentle slope to the west. The restocking has grown up to pine and oak with a small amount of grass. This includes practically all of the woodland belonging to the farm.

Location:

Notes:

History of tract and condition of timber:

Improvements:

Area and value of types:

Total Area

Value per acre

Area

Types

Value

Notes

Area

Value

Improvements

Value of Restocking

Value of Land

Notes

Value

Value of Land

Value of Improvements

Value of Orchard

Value of Minerals

Value of Pines

Value of Oaks

Value of Grass

Value per acre for tract

Incidental damage arising from the taking of this tract:

46

County: Page
District: Shenandoah Iron Works

County: Rockingham
District: Stonewall

#125 (Rockingham County)
#597 (Page County) Dearing, Sarah

Acreage Claimed: Assessed 46 A. 83 P. Deed Not available

Value Claimed: " \$460.00 (land only) "

Location: On South Naked creek at Positions #537 to #2, lying in Page and Rockingham counties, and partly outside park area.

Incumbrances, counter claims or laps: None known.

Soil: Sandy loam of good depth and fertility with much loose rock. There is a great deal of large rock along the creek. The fields are poor with small loose rock. The land along the creek is fairly level and the remainder has a gentle slope to the west. The restocking has grown up to pine and oak with a small amount of grass. This includes practically all of the woodland belonging to the farm.

Roads: Five miles, two and one-half of which are paved to Elkton, nearest shipping point.

History of tract and condition of timber: Tract has been cut over for farm use for many years. There is good white and red oak to 10" DBH. On 17 acres in Page county the estimate is 85 cords of fuel wood at \$1.00. - - - - - \$85.00

in Page county

Improvements: 12 fruit trees of various sizes/valued at - - - - - 12.00

Acreage and value of land by types: (Page County)

Type	Acreage	Value per A.	Total Value
Cove	9	6.00	54.00
Slope	8	4.00	32.00
Tillable	2	15.00	30.00
Restocking	1	9.00	9.00
	<u>20</u>		<u>125.00</u>

Value of land - - - - \$125.00 (Page County)
 " " improvements 12.00 " " (Orchard)
 " " timber - - - 85.00 " "
 " " tract - - - \$222.00 " "
 Value per acre - - - 11.10 " "

Acreage and value of land by types: (Rockingham County)

Type	Acreage	Value per A.	Total Value
Cove	1	6.00	6.00

Per acre \$6.00 (Rockingham County)

SUMMARY (Page and Rockingham counties)

Total number of acres 21 A.
" value of tract \$228.00
Average value per acre \$10.57.

46

County: Rockingham
District: Stonewall
County: Page
District: Shen.I.Works

#125- (Rockingham Co.) Dearing, Sarah
(#597-Page Co.)

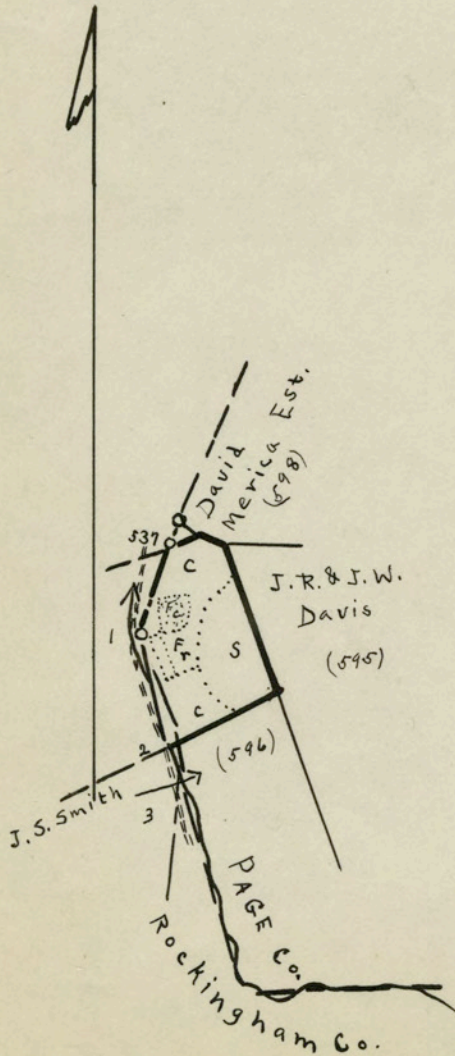

LEGEND: (Rockingham)
Cove
Scale - 1" = 20 chains