

NAME OF ~~CLAIMANT~~ OWNER

#274 - Reed, Kelly

Number of Acres: 20

Location: Deep Run, and entirely within the Park area.

Roads: Four miles via dirt roads to Port Republic, the nearest shipping point.

Soil: Sandy loam, slope type of a fair depth and fertility.

History of Tract and condition of timber: The merchantable saw timber has been removed from this tract. The remaining stand consists of small oaks and short leaf pine. About three cords of fuel wood per acre - 60 cords of wood.

Improvements: None.

Acreage and value of types:

Types	Acreage	Value per acre	Total Value
Ridge:			
Slope:	20 @	\$5.00	\$100.00
Cove:			
Grazing Land:			
Fields Restocking:			
Cultivated Land:			
Orchard:			
Minerals:			
			Total \$100.00

Value of Land: \$ 100.00

Value of Improvements: \$

Value of Orchard: \$

Value of Minerals: \$

Value of Fruit: \$

Value of Timber: \$

Value of Wood: \$

Value per acre for tract: \$ 5.00

Incidental damages arising from the taking of this tract: \$ None.

Geo. N. Peni CLERK

94

County: Rockingham
District: Stonewall

#274 - Reed, Kelly

<u>Acreage Claimed:</u>	Assessed 20	Deed 20
<u>Value Claimed:</u>	" \$40.00	1921 "\$850.00

Location: Deep Run and entirely within the Park area.

Incumbrances, counter claims or laps: None known.

Soil: Sandy loam; slope type of a fair depth and fertility.

Roads: Four miles via dirt roads to Port Republic, the nearest shipping point.

History of tract and condition of timber: The merchantable saw timber has been removed from this tract. The remaining stand consists of small oaks and short leaf pine. About three cords of fuelwood per acre.
60 cords of wood @ 50¢ -- \$30.00.

Improvements: None.

Value of land by types:

<u>Type</u>	<u>Acreage</u>	<u>Value per acre</u>	<u>Total Value</u>
Slope	20	\$3.00	\$60.00

Total value of land	\$60.00
Total value of timber	30.00
Total value of tract	<u>\$90.00</u>
Average value per acre	\$4.50

94

#274 - Reed, Kelly

County: Rockingham
District: Stonewall

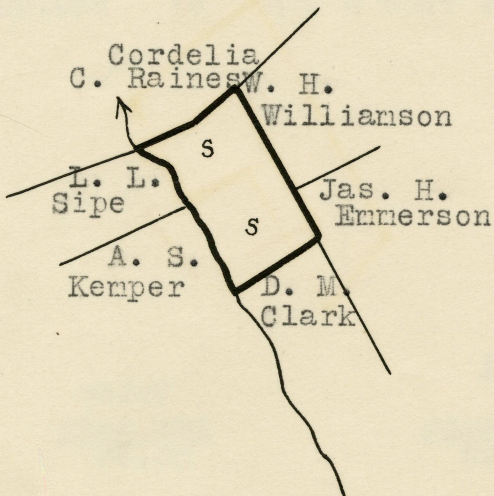

LEGEND

Slope

Scale - 1" = 20 chains