

Rappahannock County

Wakefield District

**NAME OF CLAIMANT**

#2 - North, Luther

**Number of Acres:** 40

**Location:** On top of Blue Ridge about one-half mile south of the State Highway and lying in both Warren and Rappahannock Counties.

**Roads:** About one mile by poor dirt road to the State road, thence six miles to Front Royal, the nearest shipping point.

**Soil:** Sandy loam, fairly level, and without much loose rock. It has been cleared, farmed and impoverished, and is now abandoned and grown up to brush and briars.

**History of Tract and condition of timber:** Reproduction of valuable species has been destroyed by repeated fires.

**Improvements:** None.

**Acreage and value of types:**

<b>Types</b>	<b>Acreage</b>	<b>Value per acre</b>	<b>Total Value</b>
Slope:	40	@ \$3.00	\$120.00

**Cove:**

**Grazing Land:**

**Cultivated Land:**

**Orchard:**

**Minerals:**

**Value of Land:** \$ 120.00

**Value of Improvements:** \$

**Value of Orchard:** \$

**Value of Minerals:** \$

**Value of Timber:** \$

**Value of Wood:** \$

**Value per acre for tract:** \$ 3.00

**Incidental damages arising from the taking of this tract:** \$ NONE

*Geo. H. Peni*

CLERK

#2-North, Luther

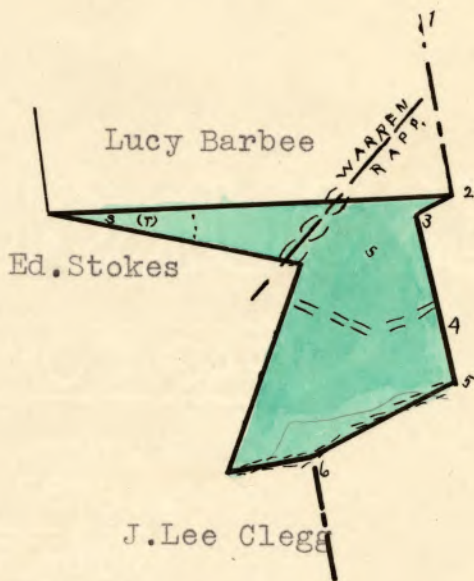
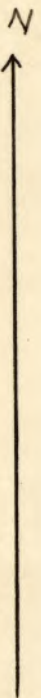

LEGEND

- |       |               |
|-------|---------------|
| Cove  | Orchard Land  |
| Slope | Grazing Land  |
| Ridge | Tillable Land |



2

Claim of Luther North  
In the Circuit Court of Rappahannock County, Virginia, No. 149, At Law.  
The State Commission on Conservation and Development of the State of Virginia, Petitioner, vs. Clifton Apler et al.

more or less, of land in Rappahannock County, Virginia, Defendants.  
The undersigned, in answer to the petition of the State Commission on Conservation and Development of the State of Virginia, and in response to the notice of condemnation awarded upon the filing of said petition and published in accordance with the order of the Circuit Court of Rappahannock County, Virginia, asks leave of the Court to file this as his answer to said petition and to said notice.

My name is Luther North  
My Post Office Address is Huntly, Va

I claim a right, title, estate or interest in a tract or parcel of land within the area sought to be condemned, containing about 38 acres, on which there are the following buildings and improvements: This is part of 46 acres tract bought of Ed. Stokes et al.

This land is located about 14 miles from Washington Virginia, in the Hollifield Magisterial District of said County.

I claim the following right, title, estate or interest in the tract or parcel of land described above: (In this space claimant should say whether he is sole owner or joint owner, and if joint owner give names of the joint owners. If claimant is not sole or joint owner, he should set out exactly what right, title, estate or interest he has in or to the tract or parcel of land described above).

own in fee simple

The land owners adjacent to the above described tract or parcel of land are as follows:

North Lucy Barber  
South Herbert Williams  
East Tom Williams  
West Ed. Stokes & Shyrod

I acquired my right, title, estate or interest to this property about the year 1927 in the following manner:

By deed from Ed. Stokes et al.

I claim that the total value of this tract or parcel of land with the improvements thereon is \$ 600.00. I claim that the total value of my right, title, estate or interest in and to this tract or parcel of land with the improvements thereon is \$ 600.00.

I am the owner of \_\_\_\_\_ acres of land adjoining the above described tract or parcel of land but lying outside the Park area, which I claim will be damaged by proposed condemnation of lands within the Park area, to the extent of \$ \_\_\_\_\_.

(In the space below should be set out any additional statements or information in support of this claim which claimant desires to make; and if practicable he should also include a description of the tract or parcel of land by metes and bounds).

Remarks: The value above is only for 38 acres, more or less supposed to be in Park area, but does not include property outside area, on which I have set an orchard.

(Continue remarks if necessary on the back of this page)

Witness my signature (or my name and mark attached hereto) this 14 day of May, 1930.

STATE OF VIRGINIA, COUNTY OF Rappahannock, To-wit:

The undersigned hereby certifies that Luther North the above named claimant personally appeared before him and made oath that the matters and things appearing in his above answer are true to the best of his knowledge and belief, this 14 day of May, 1930.

Jas. M. Settle  
Clerk of the Court, or ~~Special Investigator~~ or Notary Public, or Justice of the Peace.



2

Claim of Luther North  
In the Circuit Court of Rappahannock County, Virginia, No. 149, At Law.  
The State Commission on Conservation and Development of the State of Virginia, Petitioner, vs. Clifton Apler et al.

more or less, of land in Rappahannock County, Virginia, Defendants.  
The undersigned, in answer to the petition of the State Commission on Conservation and Development of the State of Virginia, and in response to the notice of condemnation awarded upon the filing of said petition and published in accordance with the order of the Circuit Court of Rappahannock County, Virginia, asks leave of the Court to file this as his answer to said petition and to said notice.

My name is Luther North

My Post Office Address is Huntly, Va

I claim a right, title, estate or interest in a tract or parcel of land within the area sought to be condemned, containing about 38 acres, on which there are the following buildings and improvements: This is part of 46 acres tract bought of Ed. Stokes et al.

This land is located about 14 miles from Washington Virginia, in the Hollifield Magisterial District of said County.

I claim the following right, title, estate or interest in the tract or parcel of land described above: (In this space claimant should say whether he is sole owner or joint owner, and if joint owner give names of the joint owners. If claimant is not sole or joint owner, he should set out exactly what right, title, estate or interest he has in or to the tract or parcel of land described above).

own in fee simple

The land owners adjacent to the above described tract or parcel of land are as follows:

North Lucy Barber

South Herbert Williams

East Tom Williams

West Ed. Stokes & Shyrod

I acquired my right, title, estate or interest to this property about the year 1927 in the following manner:

By deed from Ed. Stokes et al.

I claim that the total value of this tract or parcel of land with the improvements thereon is \$ 600.00. I claim that the total value of my right, title, estate or interest in and to this tract or parcel of land with the improvements thereon is \$ 600.00.

I am the owner of \_\_\_\_\_ acres of land adjoining the above described tract or parcel of land but lying outside the Park area, which I claim will be damaged by proposed condemnation of lands within the Park area, to the extent of \$ \_\_\_\_\_.

(In the space below should be set out any additional statements or information in support of this claim which claimant desires to make; and if practicable he should also include a description of the tract or parcel of land by metes and bounds).

Remarks: The value above is only for 38 acres, more or less supposed to be in Park area, but does not include property outside area, on which I have set an orchard.

(Continue remarks if necessary on the back of this page)

Witness my signature (or my name and mark attached hereto) this 14 day of May, 1930.

STATE OF VIRGINIA, COUNTY OF Rappahannock, To-wit:

The undersigned hereby certifies that Luther North the above named claimant personally appeared before him and made oath that the matters and things appearing in his above answer are true to the best of his knowledge and belief, this 14 day of May, 1930.

Jas. M. Settle  
Clerk of the Court, or Special Investigator or Notary Public, or Justice of the Peace.



#2-North, Luther

Acreage in Claim:

Value Claimed:

Examined by: Marsh, Gilliam and Stoneburner

Location: On top of Blue Ridge about one-half mile south of the State Highway and lying in both Warren and Rappahannock Counties.

Incumbrances, counter claims and laps: None so far as known.

Roads: About one mile by poor dirt road to the State road, thence six miles to Front Royal, the nearest shipping point.

Soil: Sandy loam, fairly level, and without much loose rock. It has been cleared, farmed and impoverished, and is now abandoned and grown up to brush and briars.

History of Tract and condition of timber: Reproduction of valuable species has been destroyed by repeated fires.

Improvements: None.

Acreage and value by types:

<u>Types</u>	<u>Acreage</u>	<u>Value Per A.</u>	<u>Total Value</u>
Slope	40	\$3.00	\$120.00

Value per acre: \$3.00