

OWNER

#21- NAME OF CLAIMANT

#21- Dearing, W. T.

Number of Acres: 31

Location: On South Naked Creek, cut by Park line.

Roads: 5 miles poor road to good country road to Elkton.

Soil: Sandy loam, very rocky, medium fertility. Slopes are gentle with exposure to the Northwest.

History of Tract and condition of timber: Tract has been burned in the past and cut very hard. There are scattered saplings running about one cord per acre. It is thought best to cut the

Improvements: None.

Acreage and value of types:

Types	Acreage		Value per acre	Total Value
Ridge:				
Slope: --	30	@	\$4.00	\$120.00
Cove:				
Grazing Land:				
Fields Restocking:				
Cultivated Land: --	1	@	30.00	30.00
Orchard:				\$150.00
Minerals:				

Value of Land: \$ 150.00

Value of Improvements: \$

Value of Orchard: \$

Value of Minerals: \$

Value of Fruit: \$

Value of Timber: \$

Value of Wood: \$

Value per acre for tract: \$ 4.83

Incidental damages arising from the taking of this tract: \$ NONE

Geo. N. Penick CLERK

County: Rockingham
District: Stonewall

#21 - Dearing, W. T.

Acreage Claimed: Assessed 50 A. Deed ^{*}50 A.
Value Claimed: " x \$350.00 " Acquired in 1902
" Consideration unknown.

Location: On South Naked creek, cut by the park line.

Incumbrances, counter claims or laps: None.

Soil: Sandy loam, very rocky, medium fertility. Slopes are gentle with exposure to the Northwest.

Roads: Five miles poor road to good country road to Elkton.

History of tract and condition of timber: Tract has been burned in the past and cut very hard. There are scattered saplings running about one cord per acre. It is thought best to let the per acre value cover the little timber present.

Improvements: None.

Acreage and value of land by types:

<u>Type</u>	<u>Acreage</u>	<u>Value per A.</u>	<u>Total Value</u>
Slope	31	4.00	124.00

Total value of tract - \$124.00

Average value per acre - \$4.00

* Note: This includes buildings and land outside park.

9

County: Rockingham
District: Stonewall

#21 W.T. Dearing

#21- Dearing, W.T.

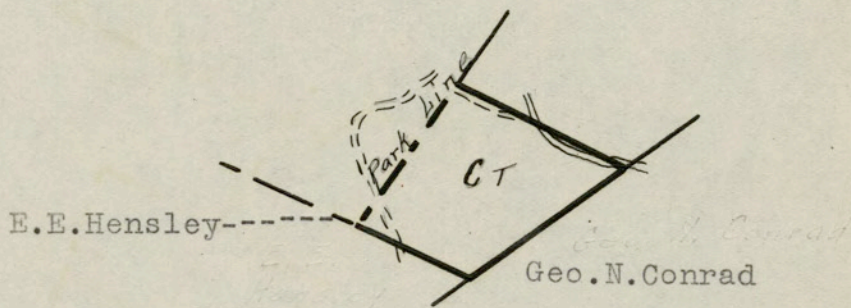
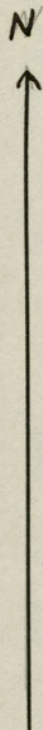

MAXWELL BOND

LEGEND:
Slope
Scale - 1" = 20 chains