

NAME OF CLAIMANT

#169a - Swindler, Mrs. L.F.

Number of Acres: 5

Location: South slope of Oven Top Mountain, near Position #556.

Roads: One mile from Lee Highway, thence 12 miles to Luray, nearest shipping point.

Soil: Sandy clay. Very little loose surface rock. Of fair depth and fertility. South and east exposure.

History of Tract and condition of timber: Cleared several decades ago. Evidently cultivated for several years, then neglected. Now growing up to chestnut and red oak, dogwood, and sassafras, 10' to 15' high.

Improvements: None.

Acreage and value of types:

Types	Acreage	Value per acre	Total Value
-------	---------	----------------	-------------

Slope:

Cove:

Grazing Land:	5	@ \$5.00	\$25.00
---------------	---	----------	---------

Cultivated Land:

Orchard:

Minerals:

Value of Land: \$ 25.00

Value of Improvements: \$

Value of Orchard: \$

Value of Minerals: \$

Value of Timber: \$

Value of Wood: \$

Value per acre for tract: \$ 5.00

Incidental damages arising from the taking of this tract: \$ NONE

Geo. H. Pen CLERK

Set in 29

169-a

Claim of O.B. Swindler
In the Circuit Court of Pappab. County, Virginia, No. 149, At Law.
The State Commission on Conservation and Development of the State of Virginia, Petitioner, vs. Clepton Caylor et al and
37400 acres

more or less, of land in Pappab. County, Virginia, Defendants.
The undersigned, in answer to the petition of the State Commission on Conservation and Development of the State of Virginia, and in response to the notice of condemnation awarded upon the filing of said petition and published in accordance with the order of the Circuit Court of Pappab. County, Virginia, asks leave of the Court to file this as his answer to said petition and to said notice.

My name is O.B. Swindler

My Post Office Address is Sperryville Va.

I claim a right, title, estate or interest in a tract or parcel of land within the area sought to be condemned, containing about 15 acres, on which there are the following buildings and improvements: NONE.

This land is located about 2 miles from Sperryville Virginia, in the Piedmont Magisterial District of said County.

I claim the following right, title, estate or interest in the tract or parcel of land described above: (In this space claimant should say whether he is sole owner or joint owner, and if joint owner give names of the joint owners. If claimant is not sole or joint owner, he should set out exactly what right, title, estate or interest he has in or to the tract or parcel of land described above).
Sole owner.

The land owners adjacent to the above described tract or parcel of land are as follows:

- North Jeremiah Atkins.
- South Other land of O.B. Swindler not in area.
- East John D. Majors.
- West O.B. Swindler.

I acquired my right, title, estate or interest to this property about the year 1925 in the following manner:

By Deed from W.M. Fletcher & W.V. Ford, Comrs. of Ct. Pappab. Co. Va. Part. all. Dark Est.

I claim that the total value of this tract or parcel of land with the improvements thereon is \$ 225⁰⁰. I claim that the total value of my right, title, estate or interest, in and to this tract or parcel of land with the improvements thereon is \$ 225⁰⁰.

I am the owner of _____ acres of land adjoining the above described tract or parcel of land but lying outside the Park area, which I claim will be damaged by the proposed condemnation of lands within the Park area, to the extent of \$_____.

(In the space below should be set out any additional statements or information as to this claim which claimant desires to make; and if practicable he should also insert here a description of the tract or parcel of land by metes and bounds).

Remarks: Timber land.

(Continue remarks if necessary on the back).

Witness my signature (or my name and mark attached hereto) this 25 day of Aug., 1930. O.B. Swindler

STATE OF VIRGINIA, COUNTY OF Pappahannock, To-wit:

The undersigned hereby certifies that O.B. Swindler the above named claimant personally appeared before him and made oath that the matters and things appearing in his above answer are true to the best of his knowledge and belief, this 25 day of Aug., 1930.

Jas. M. Surr
Clerk of the Court, or Special Investigator or Notary Public, or Justice of the Peace.

Claim of _____
In the Circuit Court of _____ County, Virginia, No. _____, At Law.
The State Commission on Conservation and Development of the State of Virginia, Petitioner, vs. _____

more or less of land in _____ County, Virginia, Defendants.
The undersigned, in answer to the petition of the State Commission on Conservation and Development of the State of Virginia, and in response to the notice of condemnation awarded upon the filing of said petition and published in accordance with the order of the Circuit Court of _____ County, Virginia, asks leave of the Court to file this as his answer to said petition and to said notice.

My name is _____
My Post Office Address is _____

I claim a right, title, estate or interest in a tract or parcel of land within the area sought to be condemned, containing _____ acres, on which there are the following buildings and improvements:

This land is located about _____ miles from _____ of said County.

I claim the following _____ state or interest in the tract or parcel of land described above: (In the _____ should say whether he is sole owner or joint owner, and if joint owner give names of the _____ owners. If claimant is not sole or joint owner, he should set out exactly _____ the, estate or interest he has in or to the tract or parcel of land described above.)

The land owners adjacent to the above described tract or parcel of land are as follows:
North _____
South _____
East _____
West _____

I acquired my right, title, estate or interest to this property about the year _____ in the following manner:

I claim that the total value of this tract or parcel of land with the improvements thereon is \$_____. I claim that the total value of my right, title, estate or interest in and to this tract or parcel of land with the improvements thereon is \$_____.

I am the owner of _____ area of land adjoining the above described tract or parcel of land but lying outside the Park area, which I claim will be damaged by the proposed condemnation of lands within the Park area, to the extent of \$_____. (In the space below should be set out any additional statements or information as to this claim which claimant desires to make; and if practicable he should also insert here a description of the tract or parcel of land by metes and bounds.)

Remarks: _____

(Continue remarks if necessary on the back.)

Witness my signature (or my name and mark attached hereto) this _____ day of _____, 1930.

STATE OF VIRGINIA, COUNTY OF _____, To-wit: _____

The undersigned hereby certifies that the above named claimant personally appeared before him and made oath that the matters and things appearing in his above answer are true to the best of his knowledge and belief,

this _____ day of _____, 1930.

Clerk of the Court, or Special Investigator or Notary Public, or Justice of the Peace.

*Claim of
A. B. Swindler.*

**FILED IN
CLERK'S OFFICE
HARRISBURG, PENNSYLVANIA**
Aug. 25 1930
J. M. S. Clerk

County: Rappahannock
District: Piedmont

#169a-Swindler, Mrs. L. F.

Acreage Claimed:

Value Claimed:

Location: South Slope of Oven Top Mountain, near Position
#556.

Incumbrances, counter claims, or laps: None known.

Soil: Sandy clay. Very little loose surface rock.
Of fair depth and fertility. South and East exposure.

Roads: One mile from Lee Highway- Thence 12 miles to
Luray, nearest shipping point.

History of tract and condition of timber: Cleared several decades
ago. Evidently cultivated for several years, then
neglected. Now growing up to chestnut and red
oaks, dogwood, and sassafras, 10' to 15' high.

Improvements: None.

Value of land by types:

<u>Type:</u>	<u>Acreage</u>	<u>Value Per A.</u>	<u>Total Value.</u>
F r	5	\$5.00	\$25.00

Total value of land \$25.00

Total value of tract \$25.00

Average value per acre--\$5.00

County: Rappahannock
District: Piedmont

#169a-Swindler, Mrs. L.F.

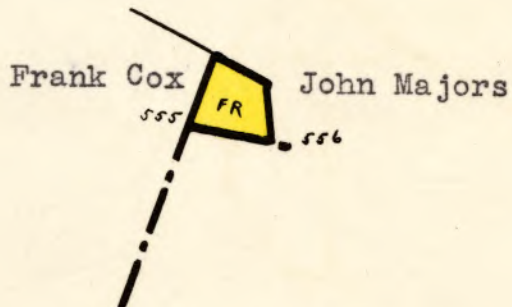

LEGEND:

Cove	Orchard
Slope	Grazing Land
Ridge	Tillable Land
	Fields restocking
Scale - 1" = 20 chains	