

CLAIMANT

NAME OF ~~OWNER~~

#172 - Wyant, George

Number of Acres: 48

Location: Hawksbill Creek and is entirely within the Park area.

Roads: 8 miles to Elkton over 4 miles of county road and 4 miles over Spotswood Trail.

Soil: Sandy clay loam of good depth and fertility.

History of Tract and condition of timber: There is an estimated amount of 10,000 bd. feet of saw timber on the woodland, and 30 cords of fuelwood.

Improvements: DWELLING: Frame, 16x30'- 8 rooms, porch 6x19', metal roof, brick flues, 2 story, ceiled, fair condition, occupied by tenant. Spring water supply, solid foundation, cellar, 14x14'.  
BARN Log 22x50x12', shingle roof, poor condition. HEN HOUSE: Frame, 8x12x8', shingle roof, poor condition. SHED: Frame, 12x14x10' shingle roof, poor condition.-- COW SHED: Frame, 8x12x8', shingle roof, poor condition.-- DWELLING: 12x16', shingle roof, 3 rooms, stone flues, 1½ story, poor condition, vacant. Pillar foundation.  
OLD LOG HOUSE: Log, 16x20x12', shingle roof, poor condition.

Acreage and value of types:

Types	Acreage		Value per acre	Total Value
Ridge:				
Slope: --	5	@	\$5.00	\$25.00
Cove:				
Grazing Land:				
Fields Restocking: --	25	@	15.00	375.00
Cultivated Land: --	18	@	35.00	630.00
Orchard:				\$1030.00
Minerals:				
Value of Land:	\$ 1030.00			
Value of Improvements:	\$ 1610.00			1610.00
Value of Orchard:	\$			
Value of Minerals:	\$			
Value of Fruit:	\$ 150.00			150.00
Value of Timber:	\$ 30.00			30.00
Value of Wood:	\$ 50.00			& 50.00
Value per acre for tract:	\$ 59.79			\$2870.00

Incidental damages arising from the taking of this tract: \$ None.

*Geo. W. Pen.*

CLERK



Claim of George H. Wyant  
In the Circuit Court of Rockingham County, Virginia, No. \_\_\_\_\_, At Law.  
The State Commission on Conservation and Development of the State of Virginia, Petitioner, vs. \_\_\_\_\_  
Containing 47 A. 3 R. and 7 P.

more or less, of land in Rockingham County, Virginia, Defendants.  
The undersigned, in answer to the petition of the State Commission on Conservation and Development of the State of Virginia, and in response to the notice of condemnation awarded upon the filing of said petition and published in accordance with the order of the Circuit Court of Rockingham County, Virginia, asks leave of the Court to file this as his answer to said petition and to said notice.

My name is George H. Wyant

My post office address is Elkton, Virginia.

I claim a right, title, estate or interest in a tract or parcel of land within the area sought to be condemned, containing about 47 A. 3 R. & acres, on which there are the following buildings and improvements: Good eight room dwelling house; chickenhouse, small dwelling house, 3 acres in orchard, and small out houses.

This land is located about 2 miles from Beldor Virginia, in the Stonewall Magisterial District of said County.

I claim the following right, title, estate or interest in the tract or parcel of land described above: (In this space claimant should say whether he is sole owner or joint owner, and if joint owner give names of the joint owners. If claimant is not sole or joint owner, he should set out exactly what right, title, estate or interest he has in or to the tract or parcel of land described above.)

The land owners adjacent to the above described tract or parcel of land are as follows:

North J. R. Herring

South Robert Burke

East D. C. Davis

West Lydia A. Eaton and William Sellers

I acquired my right, title, estate or interest to this property about the year \_\_\_\_\_ in the following manner:

46 1/2 A. (inherited one half from father John H. Wyant, 1890. Other half from William H. Wyatt, in 4-6-1914; 1/2 A. Thoas Eaton, Dec. 3, 1897. 1 A. Jesse Wyant, Mar. 17, 1893 and 6 P. Nathaniel Davis, March 23, 1893.

I claim that the total value of this tract or parcel of land with the improvements thereon is \$ 3000.00. I claim that the total value of my right, title, estate or interest, in and to this tract or parcel of land with the improvements thereon is \$ 3000.00.

I am the owner of 47A.3 R.7 P. acres of land adjoining the above described tract or parcel of land but lying outside the Park area, which I claim will be damaged by the proposed condemnation of lands within the Park area, to the extent of \$ NONE.

(In the space below should be set out any additional statements or information as to this claim which claimant desires to make; and if practicable he should also insert here a description of the tract or parcel of land by metes and bounds).

Remarks: Cannot put metes and bounds in this space.

(Continue remarks if necessary on the back).

Witness my signature (or my name and mark attached hereto) this 3rd day of February, 1931, 1930x

George H. Wyant

STATE OF VIRGINIA, COUNTY OF \_\_\_\_\_, To-wit:

The undersigned hereby certifies that George H. Wyant the above named claimant personally appeared before him and made oath that the matters and things appearing in his above answer are true to the best of his knowledge and belief, this 3rd day of February, 1931, 1930.

J. M. [Signature]  
Clerk of the Court, or Special Investigator or Notary Public, or Justice of the Peace.



County: Rockingham  
 District: Stonewall

#172 - Wyant, George H.

Acreage Claimed: 47 A-3 R-7 P. Assessed 48 A. Deed 48 A.

Value Claimed: \$3000.00 " \$530.00 " Mostly inherited  
 Area: 48 A.

Location: Hawksbill creek and is entirely within the Park area.

Incumbrances, counter claims or laps:

Soil: Sandy clay loam of good depth and fertility.

Roads: Eight miles to Elkton over four miles of county road and four miles over Spotswood Trail.

History of tract and condition of timber: There is an estimated amount of 10,000 bd. ft. of saw timber on the woodland.

Timber: 10,000 bd. ft. saw timber @ \$3.00 per M.	--	\$30.00
Fuelwood -- 30 cords @ 50¢	-----	15.00
		<u>\$45.00</u>

Improvements: Dwelling: Frame 16x30', 8 rooms, porch 6x19', metal roof, brick flues, 2 story, ceiled, fair condition, occupied by tenant, spring, solid foundation, cellar 14x14', -- \$1200.00  
 Barn: Log 22x50x12', shingle roof, poor condition -- 30.00  
 Hen house: Frame 8x12x8', shingle roof, poor " -- 5.00  
 Shed: Frame 12x14x10', shingle roof, poor condition -- 10.00  
 Cow shed: Frame 8x12x8', shingle roof, poor " -- 10.00  
 Dwelling: Size 12x16', 3 rooms, shingle roof, stone flues, 1 1/2 story, poor condition, vacant spring, pillar foundation ----- 100.00  
 Old log house: Log 16x20x12', shingle roof, poor condition ----- 25.00  
\$1380.00

Value of land by types:

<u>Type</u>	<u>Acreage</u>	<u>Value per acre</u>	<u>Total Value</u>
Slope	5	\$4.00	\$20.00
Fc	18	25.00	450.00
Fr	25	10.00	250.00
	<u>48</u>		<u>\$720.00</u>

Total value of fruit trees	---	\$83.00
Total value of land	---	720.00
Total value of improvements	---	1380.00
Total value of timber	---	45.00
Total value of tract		<u>\$2228.00</u>
Average value per acre		46.42



#172 - Wyant, George H.

County: Rockingham  
District: Stonewall

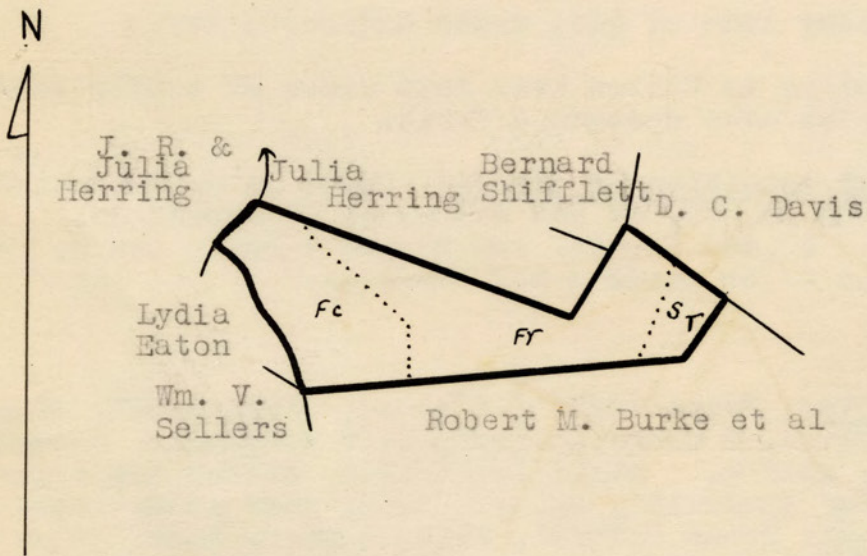

LEGEND

Slope - Tillable

Restocking

Scale - 1" = 20 chains