

NAME OF CLAIMANT

#314 - Via, Hulda

Number of Acres: 11

Location: Madison Run. Part outside the Park area. U. S. Positions 228 and 229.

Roads: Two and one-half miles via dirt road to Port Republic, the nearest shipping point.

Soil: Sandy loam, cove type of a fair depth and fertility, some scattering loose rock over the entire area.

History of Tract and condition of timber: --

Improvements:

None.

Acreage and value of types:

Types	Acreage		Value per acre	Total Value
Ridge:				
Slope:				
Cove:	5	@	\$10.00	\$50.00
Grazing Land:				
Fields Restocking:	4	@	10.00	40.00
Cultivated Land:	2	@	40.00	80.00
				<u>\$170.00</u>
Orchard:				

Minerals:

Value of Land: \$ 170.00

Value of Improvements: \$

Value of Orchard: \$

27.00
\$197.00

Value of Minerals: \$

Value of Fruit: \$

Value of Timber: \$ 27.00

Value of Wood: \$

Value per acre for tract: \$ 18.00

Incidental damages arising from the taking of this tract: \$ NONE.

Geo. B. Penick CLERK. 19

#314 - Hulda Via.

County: Rockingham
District: Stonewall

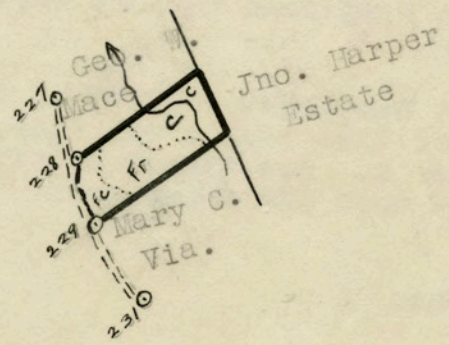
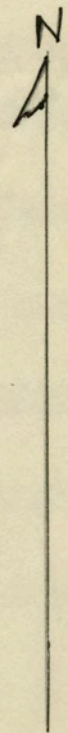

LEGEND

Cove
Tillable - Restocking
Scale - 1" = 20 chains