

NAME OF CLAIMANT

#209 - Weaver, W. P. R.

Number of Acres: 73

Location: One mile east of Island Ford and is partly inside and partly outside the Park area.

Roads: One mile to Island Ford over county road.

Soil: Sandy clay loam of medium depth and fertility.

History of Tract and condition of timber: This tract is entirely a wooded area and is estimated to cut 73,000 bd. ft. Fuelwood - 511 cords.

Improvements: None.

Acreage and value of types:

Types	Acreage		Value per acre	Total Value
Ridge:				
Slope:	73	⊙	\$5.00	\$365.00
Cove:				

Grazing Land:

Fields Restocking:

Cultivated Land:

Orchard:

Minerals:

Value of Land: \$365.00 255.50

Value of Improvements: \$ 255.50

Value of Orchard: \$ \$876.00

Value of Minerals: \$

Value of Fruit: \$

Value of Timber: \$ 255.50

Value of Wood: \$ 255.50

Value per acre for tract: \$ 11.98

Incidental damages arising from the taking of this tract: \$ None.

Geo. N. Penn CLERK 10

Claim of Fannie M. Weaver
In the Circuit Court of Forsyth County, Virginia, No. _____, At Law.
The State Commission on Conservation and Development of the State of Virginia, Petitioner, vs: _____

more or less, of land in Forsyth County, Virginia, Defendants.
The undersigned, in answer to the petition of the State Commission on Conservation and Development of the State of Virginia, and in response to the notice of condemnation awarded upon the filing of said petition and published in accordance with the order of the Circuit Court of Forsyth County, Virginia, asks leave of the Court to file this as his answer to said petition and to said notice.

My name is Fannie M. Weaver
My post office address is 7 R. M. Weaver, Regard Bldg, Winston-Salem, N. C.

I claim a right, title, estate or interest in a tract or parcel of land within the area sought to be condemned, containing about 10.0 acres, on which there are the following buildings and improvements: None

This land is located about 1 miles from Island Ford Virginia, in the Sturtevant Magisterial District of said County.

I claim the following right, title, estate or interest in the tract or parcel of land described above: (In this space claimant should say whether he is sole owner or joint owner, and if joint owner give names of the joint owners. If claimant is not sole or joint owner, he should set out exactly what right, title, estate or interest he has in or to the tract or parcel of land described above.)

a life estate in an undivided one-third interest (dower)

The land owners adjacent to the above described tract or parcel of land are as follows:

- North _____
- South J. J. Carrickhoff
- East Harriet H. H. H. H.
- West O. D. Sellers

I acquired my right, title, estate or interest to this property about the year 1928 in the following manner:

dower interest as surviving widow of W. P. R. Weaver, dec'd.

I claim that the total value of this tract or parcel of land with the improvements thereon is \$ 5000.00. I claim that the total value of my right, title, estate or interest, in and to this tract or parcel of land with the improvements thereon is \$ life estate in 1/3 interest.

I am the owner of dower in 1/3 acres of land adjoining the above described tract or parcel of land but lying outside the Park area, which I claim will be damaged by the proposed condemnation of lands within the Park area, to the extent of \$ 5000.00.

(In the space below should be set out any additional statements or information as to this claim which claimant desires to make; and if practicable he should also insert here a description of the tract or parcel of land by metes and bounds).

Remarks: _____

(Continue remarks if necessary on the back).

Witness my signature (or my name and mark attached hereto) this 9th day of February, 1930.

STATE OF VIRGINIA, COUNTY OF Forsyth, To-wit:

The undersigned hereby certifies that Fannie M. Weaver the above named claimant personally appeared before him and made oath that the matters and things appearing in his above answer are true to the best of his knowledge and belief, this 9th day of February, 1930.

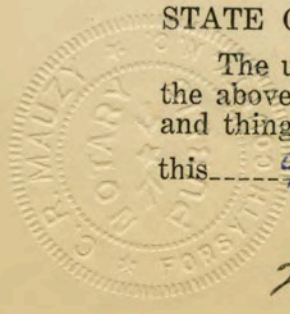

C. R. Mangy
Clerk of the Court, or Special Investigator or Notary Public, or Justice of the Peace.

2/12/31

My Commission Expires May 25, 1931

Claim of James M. Weaver
In the Circuit Court of Ratcliff County, Virginia, No. _____, At Law.
The State Commission on Conservation and Development of the State of Virginia, Petitioner, vs. _____

more or less, of land in Ratcliff County, Virginia, Defendants.
The undersigned, in answer to the petition of the State Commission on Conservation and Development of the State of Virginia, and in response to the notice of condemnation awarded upon the filing of said petition and published in accordance with the order of the Circuit Court of Ratcliff County, Virginia, asks leave of the Court to file this as his answer to said petition and to said notice.

My name is James M. Weaver
My post office address is J. M. Weaver, Reynolds Bldg, Winston-Salem, N.C.

I claim a right, title, estate or interest in a tract or parcel of land within the area sought to be condemned, containing about 100 acres, on which there are the following buildings and improvements: None

This land is located about 1 miles from Island Ford Virginia, in the Harwood Magisterial District of said County.

I claim the following right, title, estate or interest in the tract or parcel of land described above: (In this space claimant should say whether he is sole owner or joint owner, and if joint owner give names of the joint owners. If claimant is not sole or joint owner, he should set out exactly what right, title, estate or interest he has in or to the tract or parcel of land described above.)

Joint owner with Russell M. Weaver, subject to dower interest of Fannie M. Weaver

The land owners adjacent to the above described tract or parcel of land are as follows:
North _____
South J. J. Corriethoff
East Harrison & Hedrick
West A. D. Sellers

I acquired my right, title, estate or interest to this property about the year 1928 in the following manner:
By inheritance from W. P. R. Weaver, dec'd.

I claim that the total value of this tract or parcel of land with the improvements thereon is \$ 5000.00. I claim that the total value of my right, title, estate or interest in and to this tract or parcel of land with the improvements thereon is \$ 2500.00 subject to dower of Fannie M. Weaver.

I am the owner of 100 acres of land adjoining the above described tract or parcel of land but lying outside the Park area, which I claim will be damaged by the proposed condemnation of lands within the Park area, to the extent of \$ 5000.00.

(In the space below should be set out any additional statements or information as to this claim which claimant desires to make; and if practicable he should also insert here a description of the tract or parcel of land by metes and bounds).

Remarks: _____

(Continue remarks if necessary on the back).

Witness my signature (or my name and mark attached hereto) this 9th day of February, 1930.

STATE OF VIRGINIA, COUNTY OF NORTH CAROLINA, To-wit:

The undersigned hereby certifies that James M. Weaver the above named claimant personally appeared before him and made oath that the matters and things appearing in his above answer are true to the best of his knowledge and belief, this 9th day of February, 1930.

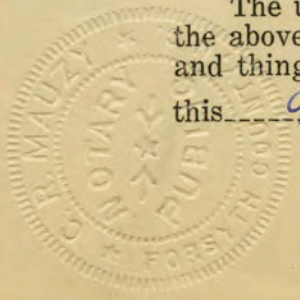

C. R. Haughey
Clerk of the Court, or Special Investigator or Notary Public, or Justice of the Peace.

2/12/31

Claim of Russell M. Weaver
In the Circuit Court of Rockingham County, Virginia, No. _____, At Law.
The State Commission on Conservation and Development of the State of Virginia, Petitioner, vs. _____

more or less, of land in Rockingham County, Virginia, Defendants.
The undersigned, in answer to the petition of the State Commission on Conservation and Development of the State of Virginia, and in response to the notice of condemnation awarded upon the filing of said petition and published in accordance with the order of the Circuit Court of Rockingham County, Virginia, asks leave of the Court to file this as his answer to said petition and to said notice.

My name is Russell M. Weaver
My post office address is Reynolds Bldg, Winston-Salem, N.C.

I claim a right, title, estate or interest in a tract or parcel of land within the area sought to be condemned, containing about 100 acres, on which there are the following buildings and improvements: none

This land is located about one miles from Island Ford Virginia, in the Barwell Magisterial District of said County.

I claim the following right, title, estate or interest in the tract or parcel of land described above: (In this space claimant should say whether he is sole owner or joint owner, and if joint owner give names of the joint owners. If claimant is not sole or joint owner, he should set out exactly what right, title, estate or interest he has in or to the tract or parcel of land described above.)

Joint owner with James M. Weaver, subject to dower of Fannie M. Weaver

The land owners adjacent to the above described tract or parcel of land are as follows:

North _____
South J. E. Carriehoff
East Harrison Hedrick
West O. D. Sellers

I acquired my right, title, estate or interest to this property about the year 1928 in the following manner:

By inheritance from W. P. P. Weaver, dec'd

I claim that the total value of this tract or parcel of land with the improvements thereon is \$ 5,000.00. I claim that the total value of my right, title, estate or interest, in and to this tract or parcel of land with the improvements thereon is \$ 2,500.00 subject to dower right of Fannie M. Weaver

I am the owner of 150 acres of land adjoining the above described tract or parcel of land but lying outside the Park area, which I claim will be damaged by the proposed condemnation of lands within the Park area, to the extent of \$ 5,000.00.

(In the space below should be set out any additional statements or information as to this claim which claimant desires to make; and if practicable he should also insert here a description of the tract or parcel of land by metes and bounds).

Remarks: _____

(Continue remarks if necessary on the back).

Witness my signature (or my name and mark attached hereto) this 11th day of Feb 1930.
STATE OF North Carolina COUNTY OF Rockingham, To-wit:

The undersigned hereby certifies that Russell M. Weaver the above named claimant personally appeared before him and made oath that the matters and things appearing in his above answer are true to the best of his knowledge and belief, this 11th day of February, 1930.

Mary J. [Signature]
Clerk of the Court, or Special Investigator or Notary Public, or Justice of the Peace.

My Commission Expires July 9, 1932

7/12/31

#209 - Weaver, W. P. R.

County: Rockingham
District: Stonewall

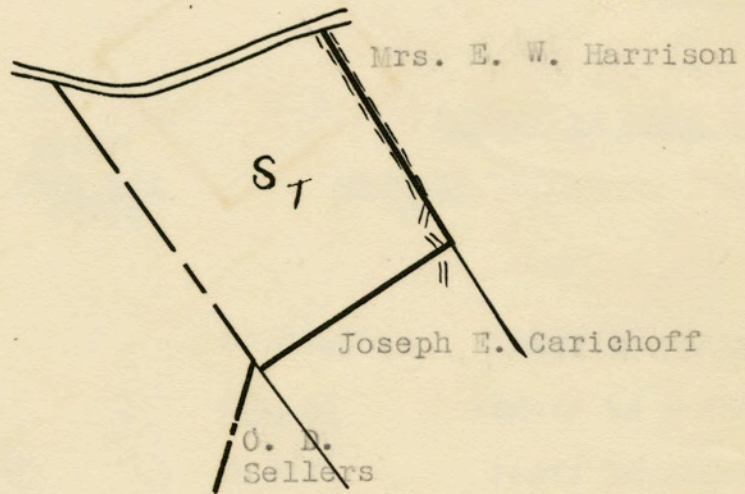
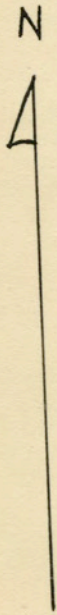

LEGEND

Slope

Scale - 1" = 20 chains