

NAME OF CLAIMANT

#294 - Shuler, C. H.

Number of Acres: 10

Location: U. S. Position 212. Part outside the Park area.

Roads: Two and one-half miles via dirt road to Port Republic, the nearest shipping point.

Soil: Sand and clay loam. Moderate slopes, cove and slope type of a fair depth and fertility.

History of Tract and condition of timber:

There is about 30 M. bd. ft. of merchantable saw timber on this tract consisting of white, red and a small amount of chestnut oak on the cove type and about 3 cords of fuelwood per acre.
30 M. bd. ft. saw timber - 30 cords fuelwood.

Improvements:

None.

Acreage and value of types:

Types	Acreage		Value per acre	Total Value
Ridge:				
Slope:	2	@	\$5.00	\$10.00
Cove:	8	@	10.00	<u>80.00</u>
Grazing Land:				\$90.00
Fields Restocking:				
Cultivated Land:				
Orchard:				120.00
Minerals:				
Value of Land:	\$ 90.00			<u>20.00</u>
Value of Improvements:	\$			\$250.00
Value of Orchard:	\$			
Value of Minerals:	\$			
Value of Fruit:	\$			
Value of Timber:	\$ 120.00			
Value of Wood:	\$ 20.00			
Value per acre for tract:	\$ 25.00			

Incidental damages arising from the taking of this tract: \$ None.

Geo. N. Pen CLERK.

Claim of Chas. H. Shuler
In the Circuit Court of Rockingham County, Virginia, No. 1829, At Law.
The State Commission on Conservation and Development of the State of Virginia, Petitioner, vs. Cassandra L. Astenis & others
52, 561 acres

more or less, of land in Rockingham County, Virginia, Defendants.
The undersigned, in answer to the petition of the State Commission on Conservation and Development of the State of Virginia, and in response to the notice of condemnation awarded upon the filing of said petition and published in accordance with the order of the Circuit Court of Rockingham County, Virginia, asks leave of the Court to file this as his answer to said petition and to said notice.

My name is Chas. H. Shuler
My post office address is Port Republic Va

I claim a right, title, estate or interest in a tract or parcel of land within the area sought to be condemned, containing about 16 acres, on which there are the following buildings and improvements: wood land

This land is located about 1 1/2 miles from Port Republic Virginia, in the Stewart Magisterial District of said County.

I claim the following right, title, estate or interest in the tract or parcel of land described above: (In this space claimant should say whether he is sole owner or joint owner, and if joint owner give names of the joint owners. If claimant is not sole or joint owner, he should set out exactly what right, title, estate or interest he has in or to the tract or parcel of land described above.)
Sole owner

The land owners adjacent to the above described tract or parcel of land are as follows:
North _____
South J. E. Shuler &
East Nora V. Haddock
West Wagner & Stevens

I acquired my right, title, estate or interest to this property about the year 1924 in the following manner:
By deed from D.P. Shuler his

I claim that the total value of this tract or parcel of land with the improvements thereon is \$ 480.⁰⁰. I claim that the total value of my right, title, estate or interest, in and to this tract or parcel of land with the improvements thereon is \$ 480.⁰⁰

I am the owner of 90 acres of land adjoining the above described tract or parcel of land but lying outside the Park area, which I claim will be damaged by the proposed condemnation of lands within the Park area, to the extent of \$ _____.

(In the space below should be set out any additional statements or information as to this claim which claimant desires to make; and if practicable he should also insert here a description of the tract or parcel of land by metes and bounds).

Remarks: This

(Continue remarks if necessary on the back).

Witness my signature (or my name and mark attached hereto) this 14th day of Feb., 1930.

STATE OF VIRGINIA, COUNTY OF Rockingham, To-wit:

The undersigned hereby certifies that C. H. Shuler the above named claimant personally appeared before him and made oath that the matters and things appearing in his above answer are true to the best of his knowledge and belief, this 14 day of Feb., 1930.

J. F. Blackburn CC
Clerk of the Court, or Special Investigator or Notary Public, or Justice of the Peace.

2/14/31

County: Rockingham
District: Stonewall

294 C. H. Shuler

<u>Acreage Claimed:</u> 16 A.	Assessed 18.94	Deed 18.94
<u>Value Claimed:</u> \$480.00	" 20.00	" 13,937.75 for this and lot # I of D. H Shuler lands

Location: U. S. Position 212. Part outside AREA: 10 A.
the Park area

Laps: None known

Soil: Sand and clay loam. Moderate slopes, cove and slope type of a fair depth and fertility.

Roads: 2 1/2 miles via dirt road to Port Republic, the nearest shipping point.

History: There is about 30M bd.ft. of merchantable saw timber on this tract, consisting of white, red and a small amount of chestnut oak on the cove type and about 3 cords of fuel wood per acre.

30M bd.ft. saw timber @ \$4.00 per M.	\$ 120.00
30 cords fuel wood @ 50¢ per cd.	15.00
	<u>135.00</u>

Improvements: None

Value of land by types:

<u>Type</u>	<u>Acreage</u>	<u>Value per acre</u>	<u>Total value</u>
cove	8	\$ 5.00	\$ 40.00
slope	2	3.00	6.00
	<u>10</u>		<u>46.00</u>

Total value of land	\$ 46.00
" " timber	<u>135.00</u>
" " tract	<u>181.00</u>
Average value per acre	18.10

#294 - C. H. Shuler.

County: Rockingham
District: Stonewall

MAXWELL BOND

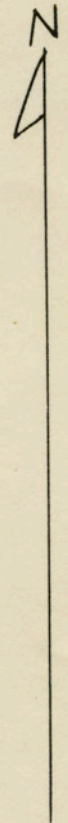
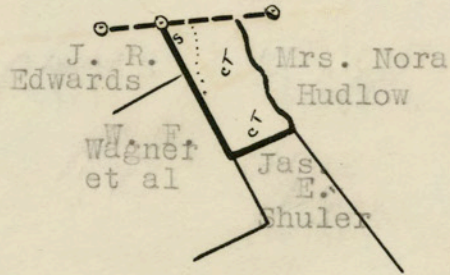

LEGEND

Cove - Slope
Scale - 1" = 20 chains

MAXWELL BOND