

ROCKINGHAM COUNTY

NAME OF CLAIMANT

#343 - Morris, J. H.

Number of Acres: 7

Location: Deep Run. Entirely within the Park area.

Roads: Three miles via dirt road to Port Republic, the nearest shipping point.

Soil: Slope types. Sandy loam of a fair depth and fertility.

History of Tract and condition of timber: All the merchantable saw timber has been removed from this tract. The remaining stand consists of small oaks and some small scrubby short leaf pine.

Improvements: None.

Acreage and value of types:

Types	Acreage	Value per acre	Total Value
-------	---------	----------------	-------------

Ridge:

Slope:	7	\$5.00	\$35.00
--------	---	--------	---------

Cove:

Grazing Land:

Fields Restocking:

Cultivated Land:

Orchard:

50.00
<hr/>
\$85.00

Minerals:

Value of Land: \$ 35.00

Value of Improvements: \$

Value of Orchard: \$

Value of Minerals: \$

Value of Fruit: \$

Value of Timber: \$

Value of Wood: \$ 50.00

Value per acre for tract: \$ 12.14

Incidental damages arising from the taking of this tract: \$ NONE.

Geo. H. Peni. CLERK. 49

County: Rockingham
District: Stonewall

#343 John H. Morris

Acreage Claimed: 1 $\frac{1}{2}$ Assessed 6.12 0-2-22 Deed 10.24 1914
less 3.00 1927
7.24
Value Claimed: \$150.00 " 150.00 " No field sheet

Location: Deep Run. Entirely within the Park area

Laps: None known

Roads: 3 miles via dirt road to Port Republic, the nearest shipping point.

Soil: Slope types. Sandy loam of a fair depth and fertility.

History: All the merchantable saw timber has been removed from this tract. The remaining stand consists of small oaks and some small scrubby short leaf pine. About 6 cords fuel wood per acre. 42 cds. fuel wood @ 50¢ per cord = 21.00

Improvements: None

Value of land by types:

Type	Acreage	Value per acre	Total Value
Slope	7	\$3.00	21.00
Value of land		\$21.00	
" " timber		21.00	
" " tract		42.00	
Average per acre		6.00	

#343 - Morris, John H. - Estate

County: Rockingham
District: Stonewall

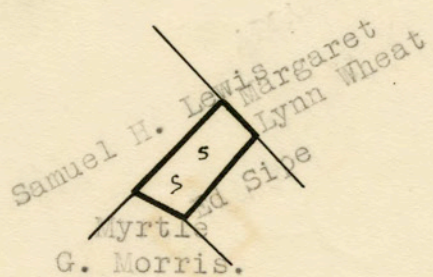
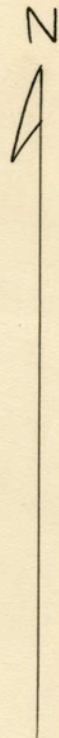

LEGEND

Slope

Scale - 1" = 20 chains