

NAME OF CLAIMANT

#111- Davis, Julia

Number of Acres: 14

Location: Swift Run. Entirely within the park area.

Roads: Spotswood Trail, hard surface, $2\frac{1}{2}$ miles to Elkton, nearest shipping point.

Soil: Sandy loam, slope type, N.E. exposure. The Fc. on this tract has a fair depth of fertility and is fairly well sodded.

History of Tract and condition of timber: All the saw timber has been removed from this tract.

IMPROVEMENTS---- DWELLING-----Frame, 15x22', 4 rooms, porch- roof, metal-- $1\frac{1}{2}$ story, occupied by owner, condition poor. 3 Springs.
 STABLE-----Frame, 10x16x9', paper roof, condition fair.-----HEN HOUSE: Log, 6x10x8', shingle roof, condition poor. GARAGE--- Frame, 8x12x8',
 Improvements: paper roof, condition fair. SHED-----Log, 8x12x8', slab roof, condition poor.

Acreage and value of types:

Types	Acreage		Value per acre	Total Value
Ridge:				
Slope: --	10	@	\$5.00	\$50.00
Cove:				
Grazing Land: --	2	@	40.00	80.00
Fields Restocking:				
Cultivated Land: --	2	@	40.00	80.00
	14			\$210.00

Orchard:

Minerals:

Value of Land: \$ 210.00	420.00
Value of Improvements: \$ 420.00	
Value of Orchard: \$ 50.00	50.00
Value of Minerals: \$	
Value of Fruit: \$	25.00
Value of Timber: \$	
Value of Wood: \$ 25.00	
Value per acre for tract: \$ 50.35	
	\$705.00

Incidental damages arising from the taking of this tract: \$ NONE

Geo. N. Pen. CLERK

In the Circuit Court of Rockingham County, Virginia, No. 1829, At Law.
The State Commission on Conservation and Development of the State of Virginia, Petitioner, vs. Cassandra Atkins and others

My name is A. E. Wyant

My post office address is-----Beldor, Virginia.

I claim a right, title, estate or interest in a tract or parcel of land within the area sought to be condemned, containing about 43 acres, on which there are the following buildings and improvements: Dwelling and out buildings

This land is located about 4 miles from Elkton, Virginia, in the Stonewall Magisterial District of said County.

I claim the following right, title, estate or interest in the tract or parcel of land described above: (In this space claimant should say whether he is sole owner or joint owner, and if joint owner give names of the joint owners. If claimant is not sole or joint owner, he should set out exactly what right, title, estate or interest he has in or to the tract or parcel of land described above.) A lien creditor of Julia Ann Davis by virtue of a deed of trust executed by Julia Ann Davis to H. W. Wyant, Trustee, Nov. 10, 1926, to secure note in the sum of \$200.00, payable to Reine Wyant, and assigned to me, together with interest from date.

The land owners adjacent to the above described tract or parcel of land are as follows:

North.

South.

East.

West

I acquired my right, title, estate or interest to this property about the year 1926 in the following manner:

See deed of trust duly recorded in the Clerk's Office of Rockingham
County, in Deed Book No. 136, at page 479.

I claim that the total value of this tract or parcel of land with the improvements thereon is \$_____. I claim that the total value of my right, title, estate or interest, in and to this tract or parcel of land with the improvements thereon is \$_____.

I am the owner of _____ acres of land adjoining the above described tract or parcel of land but lying outside the Park area, which I claim will be damaged by the proposed condemnation of lands within the Park area, to the extent of \$_____.

(In the space below should be set out any additional statements or information as to this claim which claimant desires to make; and if practicable he should also insert here a description of the tract or parcel of land by metes and bounds).

Remarks:

(Continue remarks if necessary on the back).

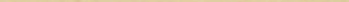
Witness my signature (or my name and mark attached hereto) this 16 day of February, 1931 ~~1932~~ 1930 

STATE OF VIRGINIA, COUNTY OF Rockingham, To-wit:

The undersigned hereby certifies that A. E. Wyant
the above named claimant personally appeared before him and made oath that the matters
and things appearing in his above answer are true to the best of his knowledge and belief,
this 16 day of February, 1931 ~~1930~~.

Clerk of the Court, or Special Investigator or
Notary Public, or Justice of the Peace.

COMMISSIONER inChancery for the

Circuit Court of Rockingham County, Virginia

FEB 17 1931

Clerk

Claim of Julia A. Davis
 In the Circuit Court of Rockingham County, Virginia, No. 1822, At Law.
 The State Commission on Conservation and Development of the State of Virginia, Petitioner, vs. Cassandra Atkins and others for the condemnation of 52.621 acres
 more or less, of land in Rockingham County, Virginia, Defendants.
 The undersigned, in answer to the petition of the State Commission on Conservation and Development of the State of Virginia, and in response to the notice of condemnation awarded upon the filing of said petition and published in accordance with the order of the Circuit Court of Rockingham County, Virginia, asks leave of the Court to file this as his answer to said petition and to said notice.

My name is Julia A. Davis

My post office address is Swift Run, Virginia

I claim a right, title, estate or interest in a tract or parcel of land within the area sought to be condemned, containing about 30 acres, on which there are the following buildings and improvements: small house only
The land consists of orchards, saw timber, extract, pulp wood, and grazing
 This land is located about 8 miles from Elkton Virginia, in the Stonewall Magisterial District of said County.

I claim the following right, title, estate or interest in the tract or parcel of land described above: (In this space claimant should say whether he is sole owner or joint owner, and if joint owner give names of the joint owners. If claimant is not sole or joint owner, he should set out exactly what right, title, estate or interest he has in or to the tract or parcel of land described above.)

I am the sole owner

The land owners adjacent to the above described tract or parcel of land are as follows:

North H. A. & H. B. Shufflett

South B. P. Gandy

East A. E. Grant

West Mrs. Mary E. Grant

I acquired my right, title, estate or interest to this property about the year 1912 in the following manner:

By inheritance and sole heir of Sarah Davis

I claim that the total value of this tract or parcel of land with the improvements thereon is \$ 1200.00. I claim that the total value of my right, title, estate or interest, in and to this tract or parcel of land with the improvements thereon is \$ 1200.00.

I am the owner of no acres of land adjoining the above described tract or parcel of land but lying outside the Park area, which I claim will be damaged by the proposed condemnation of lands within the Park area, to the extent of \$ _____.

(In the space below should be set out any additional statements or information as to this claim which claimant desires to make; and if practicable he should also insert here a description of the tract or parcel of land by metes and bounds).

Remarks: _____

(Continue remarks if necessary on the back).

Witness my signature (or my name and mark attached hereto) this _____ day of _____, 1930. Julia A. Davis

STATE OF VIRGINIA, COUNTY OF Rockingham, To-wit:

The undersigned hereby certifies that Julia A. Davis the above named claimant personally appeared before him and made oath that the matters and things appearing in his above answer are true to the best of his knowledge and belief, this 7 day of February, 1930.

A. E. Grant N.P.
 Clerk of the Court, or Special Investigator or Notary Public, or Justice of the Peace.

Claim of Julia A. Davis
In the Circuit Court of Rockingham County, Virginia, No. 1829, At Law.
The State Commission on Conservation and Development of the State of Virginia, Petitioner, vs. Cassandra Atkins & others for the
Condemnation 52.561 Acres

more or less, of land in Rockingham County, Virginia, Defendants.
The undersigned, in answer to the petition of the State Commission on Conservation and Development of the State of Virginia, and in response to the notice of condemnation awarded upon the filing of said petition and published in accordance with the order of the Circuit Court of Rockingham County, Virginia, asks leave of the Court to file this as his answer to said petition and to said notice.

My name is Julia A. Davis

My post office address is Swift Run Virginia

I claim a right, title, estate or interest in a tract or parcel of land within the area sought to be condemned, containing about 17 acres, on which there are the following buildings and improvements: Swelling house, poultry house, stable, smokehouse, Garage, Chopper, and granary

This land is located about 2 1/4 miles from Elberta Virginia, in the Stonewall Magisterial District of said County.

I claim the following right, title, estate or interest in the tract or parcel of land described above: (In this space claimant should say whether he is sole owner or joint owner, and if joint owner give names of the joint owners. If claimant is not sole or joint owner, he should set out exactly what right, title, estate or interest he has in or to the tract or parcel of land described above.)

I am sole owner

The land owners adjacent to the above described tract or parcel of land are as follows:

North E. J. Davis

South David S. Davis

East State Highway No 17 "Spottswood Trail"

West Ella & Laura Baugher land

I acquired my right, title, estate or interest to this property about the year _____ in the following manner:

By a general warranty deed from John
Knighton & wife

I claim that the total value of this tract or parcel of land with the improvements thereon is \$1500.00. I claim that the total value of my right, title, estate or interest, in and to this tract or parcel of land with the improvements thereon is \$1500.00

I am the owner of no acres of land adjoining the above described tract or parcel of land but lying outside the Park area, which I claim will be damaged by the proposed condemnation of lands within the Park area, to the extent of \$ X

(In the space below should be set out any additional statements or information as to this claim which claimant desires to make; and if practicable he should also insert here a description of the tract or parcel of land by metes and bounds).

Remarks: The above tract of land has two good gardens,
fruit trees, firewood and a never failing spring.
Also good woven wire fence

(Continue remarks if necessary on the back).

Witness my signature (or my name and mark attached hereto) this 1 day of February, 1930. Julia Davis

STATE OF VIRGINIA, COUNTY OF Rockingham, To-wit:

The undersigned hereby certifies that Julia A. Davis
the above named claimant personally appeared before him and made oath that the matters and things appearing in his above answer are true to the best of his knowledge and belief, this 7 day of February, 1930.

A. E. Hunt N.P.
Clerk of the Court, or Special Investigator or
Notary Public, or Justice of the Peace.

County: Rockingham
District: Stonewall

#111 - Mrs. Julis Davis

Acreage Claimed: 17 Assessed 13.¹⁵⁹/₁₆₀ Deed 13.¹⁵⁹/₁₆₀
Value Claimed: \$1500.00 " \$110.00 " (1910) \$5.00 cash
and other good and
valuable considerations

Location: Swift Run. Entirely within the Park area.

Laps: None known.

Soil: Sandy loam, slope type, N. E. exposure, the Fe, on this tract
has a fair depth of fertility. The Fe. is fairly well sodded.

Roads: Spotswood Trail, hard surface, 2½ miles to Elkton, nearest
shipping point.

History: All the saw timber has been removed from this tract, about
½ cd. of fuel wood per A. on 10 acres @ \$1.00 per cd. \$5.00

Improvements: Dwelling, frame 15x22, rooms 4, porch, roof, metal
1½ story, occupied by owner, condition poor,
3 springs. ----- \$225.00
Stable, Frame 10x16x9, roof, paper, cond.
~~fair.~~ ----- 25.00
Hen house, log 6x10x8, shingle roof,
condition poor. ----- 15.00
Garage, Frame 8x12x8, paper roof, cond.
fair. ----- 20.00
Shed, log 8x12x8, Slab roof, cond. poor 10.00
\$ 295.00

Value of land by types:

Type	Acreage	Value per acre	Total Value
Slope	2 10	\$8.00	\$80.00
Grazing	2	\$50.00	\$100.00
Tillable	2	50.00	100.00

Total value of land \$280.00

Total value of improvements 295.00

Total value of timber 5.00

Total value of tract 580.00

Average value per acre 41.43

#111 - Davis, Mrs. Julia

County: Rockingham
District: Stonewall

Anna Laura
Baughner

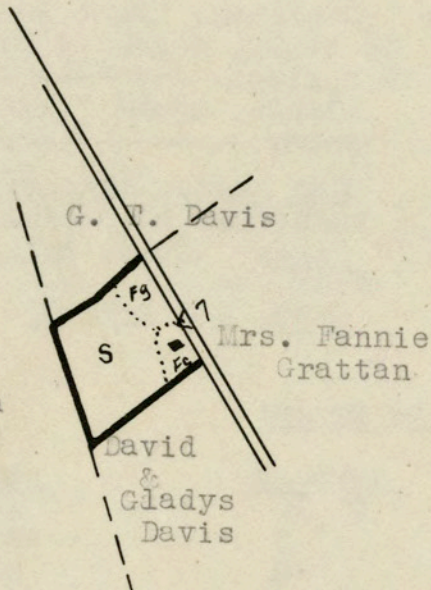

LEGEND

Slope - grazing

Tillable

Scale - 1" = 20 chains