

ROCKINGHAM COUNTY

NAME OF CLAIMANT

#208 - Harrison, Mrs. E. W.

Number of Acres: 73

Location: Two Mile Run. This tract is entirely within the Park area.

Roads: One mile over county road to Island Ford.

Soil: Slope.

History of Tract and condition of timber: The cultivated field on this tract is rather thin gravelly loam, but the soil of the wood seems to be fertile. The timber on this tract is above the average for this particular locality.

Improvements: NONE.

Acreage and value of types:

Types	Acreage		Value per acre	Total Value
Ridge:				
Slope:	43	@	\$5.00	\$215.00
Cove:	18	@	10.00	180.00
Grazing Land:				
Fields Restocking:				
Cultivated Land:	12	@	20.00	240.00
Orchard:	73			\$635.00

Minerals:

Value of Land: \$ 635.00

Value of Improvements: \$

Value of Orchard: \$

620.00

Value of Minerals: \$

Value of Fruit: \$

Value of Timber: \$ 620.00

Value of Wood: \$ 185.00

185.00  
\$1440.00

Value per acre for tract: \$ 19.72

Incidental damages arising from the taking of this tract: \$ NONE.

*Geo. N. Penz* CLERK.



## NAME OF CLAIMANT

#208-a - - Harrison, Mrs. E. W.

Number of Acres: 131 $\frac{1}{2}$ 

Location: Mile Run. This tract is entirely within the Park area.

Roads: 2 miles over county road to Island Ford.

Soil: Slope

History of Tract and condition of timber: The middle portion of this tract has been severely burned over. The remainder has approximately 250 cords of fuelwood.

Improvements: None.

## Acreage and value of types:

Types	Acreage		Value per acre	Total Value
Ridge:				
Slope: -	131 $\frac{1}{2}$	@	\$3.00	\$394.50

Cove:

Grazing Land:

Fields Restocking:

Cultivated Land:

Orchard:

Minerals:

Value of Land: \$ 394.50

Value of Improvements: \$

Value of Orchard: \$

Value of Minerals: \$

Value of Fruit: \$

Value of Timber: \$

Value of Wood: \$ 200.00

Value per acre for tract: \$ 5.28

200.00
<hr/> \$694.50

Incidental damages arising from the taking of this tract: \$ None.

Geo. N. Penz: CLERK



County: Rockingham  
District: Stonewall

#208 Mrs. E. W. Harrison

Acreage Claimed: Assessed 307 acres Deed (inherited 30 acres 1921)  
Value Claimed: " \$3670.00 " acquired 101½ A. 1921 -- \$1.00 etc.

Location: Two mile Run, this tract is entirely within the Park area.

Laps:

Soil: Slope

Roads: One mile over county road to Island Ford.

History: The cultivated field on this tract is rather thin gravelly loam, but the soil of the wood seems to be fertile. The timber on this tract is above the average for this particular locality.

Improvements: None.

Timber: 124,000 Bd. ft. @ \$5.00 per ft. \$620.00

Value of land by types:

<u>Type</u>	<u>Acreage</u>	<u>Value per acre</u>	<u>Total Value</u>
Fc.	12	\$20.00	\$240.00
Slope	43	5.00	215.00
Cove	18	7.00	126.00
	<u>73</u>		<u>\$581.00</u>

Total value of land \$581.00

Total value of improvements

Total value of timber 620.00

Total value of tract \$1201.00

Average value per acre 16.45



County: Rockingham  
District: Stonewall

#208-a - Mrs. E. W. Harrison

Acreage Claimed:

Assessed: 307 A.

Deed:

Value Claimed:

Assessed: \$3670.00

Acquired 101 $\frac{1}{2}$   
A. (1921) for  
\$1.00 etc.  
Inherited  
30 A. (1921)

Area:

30 A. (1921)

Location: Mile Run. This tract is entirely within the Park area.

Incumbrances, counter claims or laps:

Soil: Slope.

Roads: Two miles over county road to Island Ford.

History of tract and condition of timber: The middle portion of this tract has been severely burned over. The remainder has approximately 250 cords of fuelwood.

Improvements: None.

Timber: 250 cords of fuelwood @ 75¢ per cord -- \$187.50.

Value of land by types:

Type	Acreage	Value per acre	Total Value
Slope (unburned)	83	\$5.00	\$415.00
Slope (burned)	50	1.50	75.00
	133		\$490.00

Total value of land ..... \$490.00

Total value of timber ..... 187.50

Total value of tract ..... \$677.50

Average value per acre ..... \$5.09



#208- Harrison, Mrs. E. W.

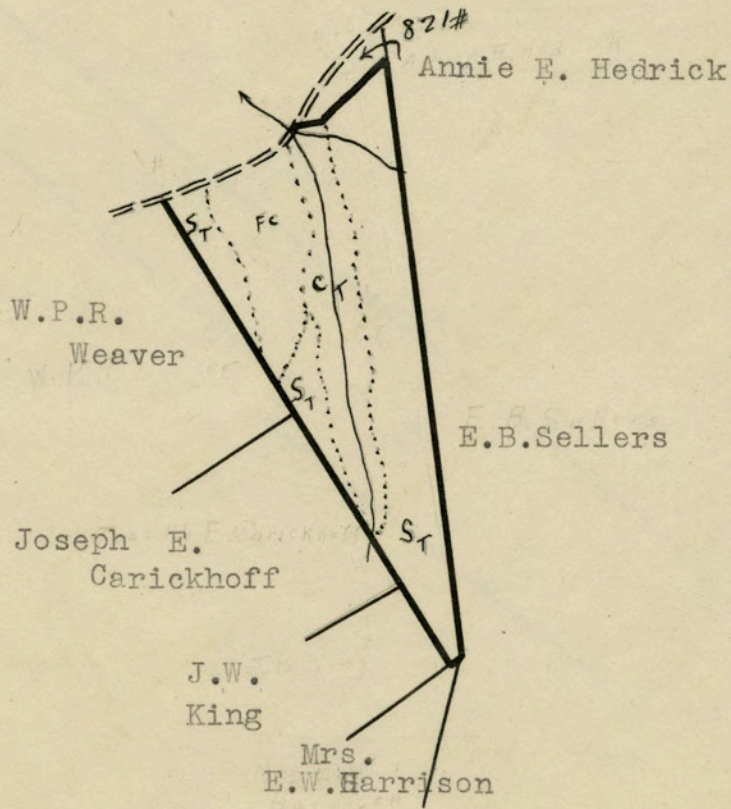
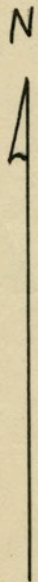

LEGEND:  
 Slope      Cove  
 Fields Restocking  
 Scale - 1" = 20 chains



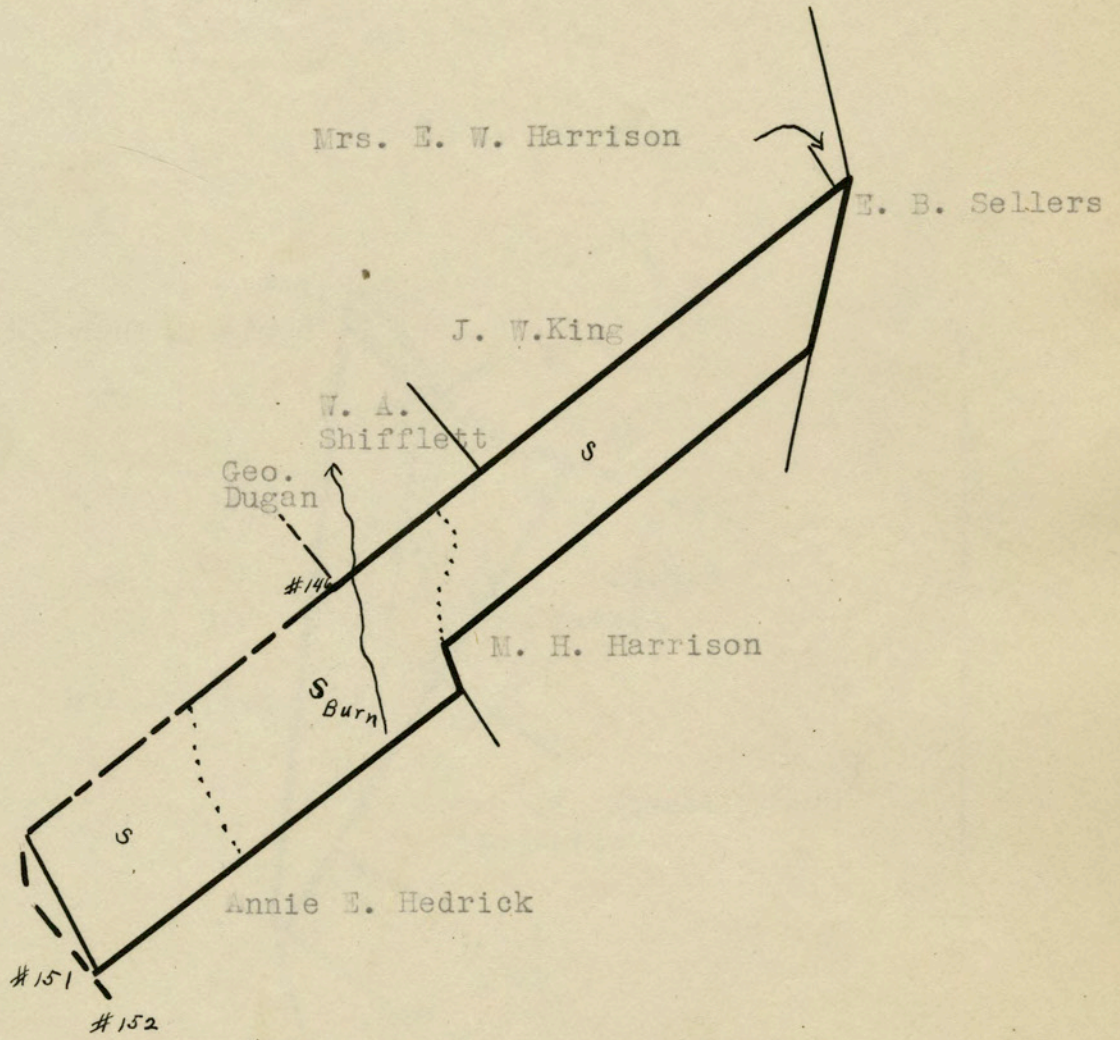
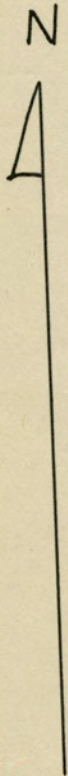

LEGEND  
 Slope  
 Scale - 1" = 20 chains



IN THE CIRCUIT COURT OF ROCKINGHAM COUNTY, VIRGINIA

State Commission on Conservation and  
Development of the State of Virginia.

Filed in the Clerk's Office  
Rockingham County, Va.

vs.

OCT / 1932

Cassandra Lawson Atkins and others, and  
52,501 acres of land in Rockingham County, Virginia

*Robert S. Sutter* Clerk

Motion to set aside and disapprove the report of the Board of  
Appraisal Commissioners.

Comes now the claimant, Mrs. E. W. Harrison, and asks and requests the Court to set aside, decline to accept and disapprove the report of the Board of Appraisal Commissioners filed in this cause with reference to this defendant in Tracts Nos. 208 and 208A, which said tracts contain 73 acres and 131 1/2 acres, respectively, and are situate near Island Ford, in Stonewall District, Rockingham County, Virginia; for the following reasons:

(1) Because the value placed upon said land and timber by the Board of Appraisal Commissioners is grossly inadequate.

(2) Because the said Board of Appraisal Commissioners made no allowance for damage to the remaining land of movant.

(3) Because the finding or findings in question are so manifestly inadequate when considered together with the evidence before the Court, as to justify a finding that in making such finding or findings the Board of Appraisal Commissioners or some of them were affected or influenced by some mistake of law as to the nature and effect of the evidence, with reference to which such finding or findings were made.

Wherefore, the said Mrs. E. W. Harrison prays the Court that an order may be entered setting aside, declining to accept, and disapproving the report of the Board of Appraisal Commissioners in so far as it relates to or affects the said lands owned and claimed by the said Mrs. E. W. Harrison.



Said Mrs. E. W. Harrison further moves the Court to exclude her said lands from the Park area and to release her said lands from the said condemnation proceedings.

Your movant herewith files affidavits as to the value of the said land.

MRS. E. W. HARRISON

By counsel

Ralph H Bader  
Counsel



IN THE CIRCUIT COURT OF ROCKINGHAM COUNTY, VIRGINIA

State Commission on Conservation and  
Development of the State of Virginia

vs.

Cassandra Lawson Atkins and others, and  
52,501 acres of land in Rockingham County, Virginia.

Affidavit to be read in connection with motion of Mrs. E. W.  
Harrison to have the finding of the Board of Appraisal Commissioners  
disapproved in connection with its findings Nos. 208 and 208A.

State of Virginia,

County of Rockingham, to-wit:

This day personally appeared before me P B F Good  
a Notary Public in and for the County of Rockingham, in the State  
of Virginia, J W Shifflet, who being duly sworn  
deposes and says as follows:

That he is well acquainted with the tracts of land belonging  
to Mrs. E. W. Harrison, situate near Island Ford, in Stonewall  
District, Rockingham County, Virginia, known as Tracts Nos. 208 and  
208A, in the report of the Board of Appraisal Commissioners,  
containing 73 acres and 131 1/2 acres, respectively; that the  
condemnation of the said tracts of land will largely deprive the  
remaining tract belonging to Mrs. Harrison of wood and lumber which  
will seriously depreciate the value of the same; that the amount  
allowed by said Commissioners for said land is grossly inadequate  
and that he appraises the value of said tracts of land and residual  
damage as follows:

Tract No. 208, 73 acres at \$30.00 per acre	\$2,190.00
Tract No. 208A, 131 1/2 acres at \$16.50 per a.	2,169.75
Residual damage	600.00
	<hr/>
	\$4,959.75

J W Shifflet

Subscribed and sworn to before me this 27 day of September, 1932.

P B F Good

Notary Public



IN THE CIRCUIT COURT OF ROCKINGHAM COUNTY, VIRGINIA

State Commission on Conservation and  
Development of the State of Virginia

vs.

Cassandra Lawson Atkins and others, and  
52,501 acres of land in Rockingham County, Virginia.

Affidavit to be read in connection with motion of Mrs. E. W.  
Harrison to have the finding of the Board of Appraisal Commissioners  
disapproved in connection with its findings Nos. 208 and 208A.

State of Virginia,

County of Rockingham, to-wit:

This day personally appeared before me P.B.F. Good  
a Notary Public in and for the County of Rockingham, in the State  
of Virginia, O.D. Sellers, who being duly sworn  
deposes and says as follows:

That he is well acquainted with the tracts of land belonging  
to Mrs. E. W. Harrison, situate near Island Ford, in Stonewall  
District, Rockingham County, Virginia, known as Tracts Nos. 208 and  
208A, in the report of the Board of Appraisal Commissioners,  
containing 73 acres and 131 1/2 acres, respectively; that the  
condemnation of the said tracts of land will largely deprive the  
remaining tract belonging to Mrs. Harrison of wood and lumber which  
will seriously depreciate the value of the same; that the amount  
allowed by said Commissioners for said land is grossly inadequate  
and that he appraises the value of said tracts of land and residual  
damage as follows:

Tract No. 208, 73 acres at \$30.00 per acre	\$2,190.00
Tract No. 208A, 131 1/2 acres at \$16.50 per a.	2,169.75
Residual damage	600.00
	<hr/>
	\$4,959.75

O. D. Sellers

Subscribed and sworn to before me this 30 day of September, 1932.

P.B.F. Good

Notary Public



IN THE CIRCUIT COURT OF ROCKINGHAM COUNTY, VIRGINIA

The State Commission on Conservation  
and Development of the State of Virginia

vs.

Cassandra Lawson Atkins and others, and  
52,561 acres, more or less, of land in  
Rockingham County, Virginia

Filed in the Clerk's Office  
Rockingham County, Va.

NOV 5 1932

*J. Robert Skutumpah* Clerk

In compliance with the order entered in the above entitled case on the 25th day of October, 1932, and in response thereto, your defendant respectfully states that the tracts or parcels of land within the area sought to be condemned, ownership of which are claimed by her, and with reference to which she has filed her objections, are the same tracts or parcels which were found by the Appraisal Commissioners to be land owned by her; being Tracts Nos. 208 and 208A, as shown and delineated on the map filed with the report and exhibit sheets thereto attached, made by said Commissioners.

MRS. E. W. HARRISON

By Counsel

*Ralph H. Bader*  
Counsel