

County: Madison
District: Roberson

Claimant #225-Aylor, Sarah E.

Acreage Found: 53 Assessed: 161 A. Deed: 142 A.

Location: Rose River; U. S. Positions 156-157-158 & 159. Part outside Park Area.

Incumbrances, counter claims or laps: None known.

Soil: Sandy loam of a fair depth and fertility. Slopes are moderate to steep.

Roads: Three miles via dirt road to Criglersville, 18 miles hard surface road to Culpeper, the nearest shipping point.

History of tract and condition of timber: There has been no saw timber removed from this tract except on F. R. It is estimated to cut 100 M. saw timber, 72 tons tanbark and 300 locust stakes. Timber is mostly chestnut oak.

100 M. saw timber @ \$3.50 per M.	\$350.00
72 tons tanbark @ \$2.00 per ton.	\$144.00
300 locust stakes @ 2 $\frac{1}{2}$ ¢ per stake.	\$ 7.50
	<hr/>
	\$501.50.

Improvements: None.

Acreage and value of land by types:

<u>Type</u>	<u>Acreage</u>	<u>Value per acre</u>	<u>Total Value</u>
Slope & Fr	53	\$5.00	\$265.00

Summary:

Total value of land.	\$265.00
Total value of timber.	\$501.50
Total value of tract.	<hr/>
	\$766.50.

Note: Commission is advised Sarah E. Aylor is an incompetent.

L. H. Farmer, Sec.

#225-Aylor, Sarah E.

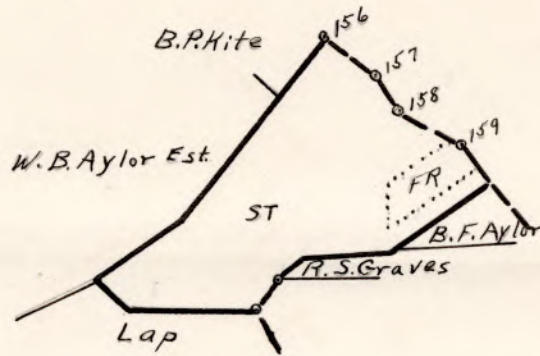

LEGEND:
Slope Fields restocking
Scale - 1" = 20 chains

County: Madison
 District: Robertson

#225-Aylor, Sarah E.

Acreage Claimed: 30 A. Assessed: 161 A. Deed: 142 A.
Value Claimed: \$450.00 Assessed: \$1827.00 Deed: Inherited.
 (Two Claims)

AREA: 53 A. (By Survey)

Location: Rose River; U. S. Positions 156-157-158 & 159.
 Part outside Park Area.

Incumbrances, counter claims or laps: None known.

Soil: Sandy loam of a fair depth and fertility. Slopes are moderate to steep.

Roads: Three miles via dirt road to Criglersville, 18 miles hard surface road to Gulpeper, the nearest shipping point.

History of tract and condition of timber: There has been no saw timber removed from this tract except on F.R. It is estimated to cut 100 M. saw timber, 72 tons tanbark and 300 locust stakes. Timber is mostly chestnut oak.

100 M. saw timber @ $\$2.50$ per M.	\$250.00
72 tons tanbark @ $\$1.50$ per ton	108.00
300 locust stakes @ $2\frac{1}{2}$ ¢ per stake	4.50
	<u>\$362.50</u>

\$350
\$950.00
144
7.50
\$501.50

Improvements: None.

Acreage and value of land by types:

<u>Types:</u>	<u>Area:</u>	<u>Value Per A.</u>	<u>Total Value</u>
Slope	49	\$2.50	\$122.50
Fields restocking	4	4.00	16.00
	<u>53</u>		<u>\$138.50</u>

Total value of land: \$138.50
 Total value of timber: 362.50
 Total value of tract: \$501.00

Average value per acre: \$9.45

Virginia: In the circuit court of Madison County:

The State Commission on Conservation and
Development of the State of Virginia - - - - - Petitioner

Vs(Answer of N. G. Payne, guardian ad litem)

D. F. Anderson and others, and fifty five
Thousand(55,000) acres, more or less of land
in Madison county, Virginia - - - - - Defendants -

The answer of N. G. Payne, guardian ad litem for Sarah E. Aylor,
incompetent, appointed by the circuit court of Madison
county, Virginia, to represent and defend the interests of said Sarah E.
Aylor, incompetent, in the above styled proceedings:

This respondent, for answer to the said petition says:

That the said Sarah E. Aylor, incompetent, is the owner of, or
has an interest in a tract of approximately Fifty Three
acres of land in Madison county, Virginia, which tract of land is
sought to be condemned in the above styled proceeding.

That the interest of the said above named Sarah E. Aylor
in said land is supposed to be a fee simple interest
therein. Testimony has been taken with reference to the value of the
said land proposed to be taken and submitted to the Board of Appraisal
Commissioners. This respondent requests that said testimony so taken be
considered in support of the interests of the above named incompetent,
and your respondent prays that no order be entered to the detriment of
the said incompetent, and that such interest may have the care and
protection of the court.

And now having fully answered, he prays to be hence dismissed, etc.

N. G. Payne Guardian ad
Litem for Sarah E. Aylor, Incompetent -

State of Virginia,

County of Madison, to-wit:

In the clerk's office of said county:

Subscribed and sworn to before me A. H. Cave, clerk of the circuit
court for Madison county, Virginia, by N. G. Payne, guardian ad litem,
this the 20th day of January, 1932 -

A. H. Cave Clerk of the circuit

Court for Madison county, Virginia -

Claim of Sarah Ellen Aylor
In the Circuit Court of Madison County, Virginia, No. _____, At Law.
The State Commission on Conservation and Development of the State of Virginia, Petitioner, vs. W. D. Anderson and others -
thirty acres of land, more or less

more or less, of land in Madison County, Virginia, Defendants.
The undersigned, in answer to the petition of the State Commission on Conservation and Development of the State of Virginia, and in response to the notice of condemnation awarded upon the filing of said petition and published in accordance with the order of the Circuit Court of Madison County, Virginia, asks leave of the Court to file this as his answer to said petition and to said notice.

My name is Sarah Ellen Aylor

My Post Office Address is Syria, Va.

I claim a right, title, estate or interest in a tract or parcel of land within the area sought to be condemned, containing about 30 acres, on which there are the following buildings and improvements:

Mostly timber

This land is located about one miles from Syria Virginia, in the Robertson Magisterial District of said County.

I claim the following right, title, estate or interest in the tract or parcel of land described above: (In this space claimant should say whether he is sole owner or joint owner, and if joint owner give names of the joint owners. If claimant is not sole or joint owner, he should set out exactly what right, title, estate or interest he has in or to the tract or parcel of land described above).

A fee simple interest therein

The land owners adjacent to the above described tract or parcel of land are as follows:
North B. P. Kite, and others
South B. F. Aylor
East Sarah E. Aylor
West Big Survey -

I acquired my right, title, estate or interest to this property about the year _____ in the following manner:

By will of W. B. Aylor recorded in Madison county clerk's office in Will Book 3, page 33 -

I claim that the total value of this tract or parcel of land with the improvements thereon is \$ 450.00. I claim that the total value of my right, title, estate or interest, in and to this tract or parcel of land with the improvements thereon is \$ 450.00.

I am the owner of 113 acres of land adjoining the above described tract or parcel of land but lying outside the Park area, which I claim will be damaged by the proposed condemnation of lands within the Park area, to the extent of \$ 200.00.

(In the space below should be set out any additional statements or information as to this claim which claimant desires to make; and if practicable he should also insert here a description of the tract or parcel of land by metes and bounds).

Remarks: _____

(Continue remarks if necessary on the back).

Witness my signature (or my name and mark attached hereto) this 25th day of July, 1930.

STATE OF VIRGINIA, COUNTY OF _____ To-wit: Sarah Ellen Aylor

The undersigned hereby certifies that H. G. Payne the above named claimant personally appeared before him and made oath that the matters and things appearing in his above answer are true to the best of his knowledge and belief, this 25 day of July, 1930.

A. H. Care
Clerk of the Court, or Special Investigator or Notary Public, or Justice of the Peace.

Handwritten notes on the left margin:
Paying
\$100
to
Sarah
Ellen
Aylor
July
25
1930

Claim of Sarah Ellen Aylor
in the Circuit Court of Madison County, Virginia, No. At Law
The State Commission on Conservation and Development of the State of Virginia, Petitioner, vs. W. D. Anderson and others -
Twenty acres of land, more or less

more or less of land in Madison County, Virginia, Defendants.
The undersigned, in answer to the petition of the State Commission on Conservation and Development of the State of Virginia, and in response to the notice of condemnation awarded upon the filing of said petition and published in accordance with the order of the Circuit Court of Madison County, Virginia, asks leave of the Court to file this
as his answer to said petition and to said notice.
Sarah Ellen Aylor
My name is
My Post Office Address is Syria, Va.

I claim a right, title, estate or interest in a tract or parcel of land within the area sought to be condemned, containing about 20 acres, on which there are the following buildings and improvements:

The tract is located about one mile from Syria, Madison County, Virginia, in the Madison Magisterial District of said County.
I claim the following right, title, estate or interest in the tract or parcel of land described above: (In this space claimant should say whether he is sole owner or joint owner, and if joint owner give names of the joint owners. If claimant is not sole or joint owner, he should set out exactly what right, title, estate or interest he has in or to the tract or parcel described above.)
A large interest therein

The owners adjacent to the above described tract or parcel of land are as follows:
North E. P. Rice, and others
South W. D. Aylor
East Sarah E. Aylor
West Big Runway

I acquired my right, title, estate or interest in this property about the year 1930 in the following manner:
By will of W. D. Aylor recorded in Madison County Clerk's office in Will Book 7, page 33 -

I claim that the total value of this tract or parcel of land with the improvements thereon is \$450.00. I claim that the total value of my right, title, estate or interest in and to this tract or parcel of land with the improvements thereon is \$450.00.
I am the owner of 1.13 acres of land adjoining the above described tract or parcel of land but lying outside the Park area, which I claim will be damaged by the proposed condemnation of lands within the Park area, to the extent of \$200.00.
(In the space below should be set out any additional statements or information as to this claim which claimant desires to make; and if practicable he should also insert here a description of the tract or parcel of land by metes and bounds.)

Remarks:

(Continue remarks if necessary on the back.)
Witness my signature (or my name and mark attached hereto) this 25th day of July, 1930.
STATE OF VIRGINIA, COUNTY OF
The undersigned hereby certifies that the above named claimant personally appeared before him and made oath that the matters and things appearing in his above answer are true to the best of his knowledge and belief.
this 25th day of July, 1930.
Clerk of the Court, or Special Investigator or Notary Public, or Justice of the Peace.

Sarah Ellen Aylor
Filed July 25, 1930
W. D. Aylor
Clerk