

County: Madison
District: Rapidan

MADISON TIMBER CORPORATION

Timber Rights on

#267a - CAVE & PAYNE.

Area: 67 A. Timber Right
67 A. Total Area of Tract.

Location: On East Slope, Garth Run Area.

Expiration date: July 3, 1937 with option to extend time
limit five years.

History of tract and condition of timber: Poplar and oak
culled closely over entire tract. In Cove, good
stand of merchantable 2nd growth Poplar. Land
restocking with poplar, locust, hickory, maple
and oak, with poplar occurring in pure stand
in Cove. Land not burned recently. It is
estimated to cut as follows:

114 M. bd. feet (other than chestnut)	@ \$3.50.	\$399.00
25 M. feet Chestnut	@ \$1.00	25.00
5 Cds Locust	@ \$5.00	25.00
15 " Pulpwood	@ \$1.00.	15.00
		<u>\$464.00.</u>

Summary:

Total value of timber \$464.00.

L. W. Farmer & Co.

Claimant #267-a - Cave & Payne.

Acreeage Found: 67 Assessed 66.25 A. Deed 66.25 A.

Location: West side of Garth Run; wholly in Park Area.

Incumbrances, counter claims or laps: Timber Rights on tract held by Madison Timber Company to be reported separately.

Soil: Sandy loam of moderate depth and fertility. Slopes steep and rocky.

Roads: Twenty-three miles to Somerset, nearest R. R., 6 miles County Road, 17 miles State Highway.

History of tract and condition of timber: Timber cut off. Best merchant-able timber is second growth poplar in cove. On upper slope is heavy stand of dead chestnut. Land not burned recently. Restocking to poplar in cove; poplar, hickory and oaks on slopes.

Improvements: Dwelling: Frame, 15x24', 3 rooms, shingle roof, 1 $\frac{1}{2}$ story, celled, spring water supply, sindows out--fair condition, abandoned.

Meat House: Frame, 8x10', shingle roof, fair condition.

Hen house: Frame, 8x10', shingle roof.

House: Log, 8x12', shingle roof, poor condition.

Total value of improvements -- \$100.00.

Ten apple trees, 35 yrs. @ \$1.00 -- \$10.00.

Acreeage and value of land by types:

Type	Acreeage	Value per acre	Total Value
Slope	50	\$2.50	\$125.00
Cove	7	\$5.00	\$35.00
Fr	10	\$6.00	\$60.00
	<u>67</u>		<u>\$220.00</u>

Summary:

Total value of land. \$220.00
Total value of improvements. \$100.00
Total value of fruit trees. \$10.00
Total value of tract. \$330.00.

L. W. Farmer, Sec.

County: Madison
District: Rapidan

Claimant #267-b- Cave, A. H. & Payne, N. G.

Acreage Found: 160 Assessed Deed 160 A.

Location: German Ridge near Ruth, Virginia, and is entirely within the Park Area.

Incumbrances, counter claims or laps:

Soil: Sandy, clay loam of medium depth and fertility.

Roads: Seven miles over county road to Madison; thence sixteen miles over State Highway to Culpeper.

History of tract and condition of timber: All the merchantable saw timber was removed from this tract about three years ago. There is a small amount of grazing land on this tract. Locust posts are being removed.

Improvements: None.

Value of land by types:

Type	Acreage	Value per acre	Total Value
Slope	136	\$3.00	\$408.00
Fg	14	\$15.00	\$210.00
Fr	10	5.00	50.00
	<u>160</u>		<u>\$668.00</u>

Summary:

Total value of land. \$668.00
Total value of tract. \$668.00

L. M. Farmer, Sec.

#267- Cave, A.H., & Payne, N.G.

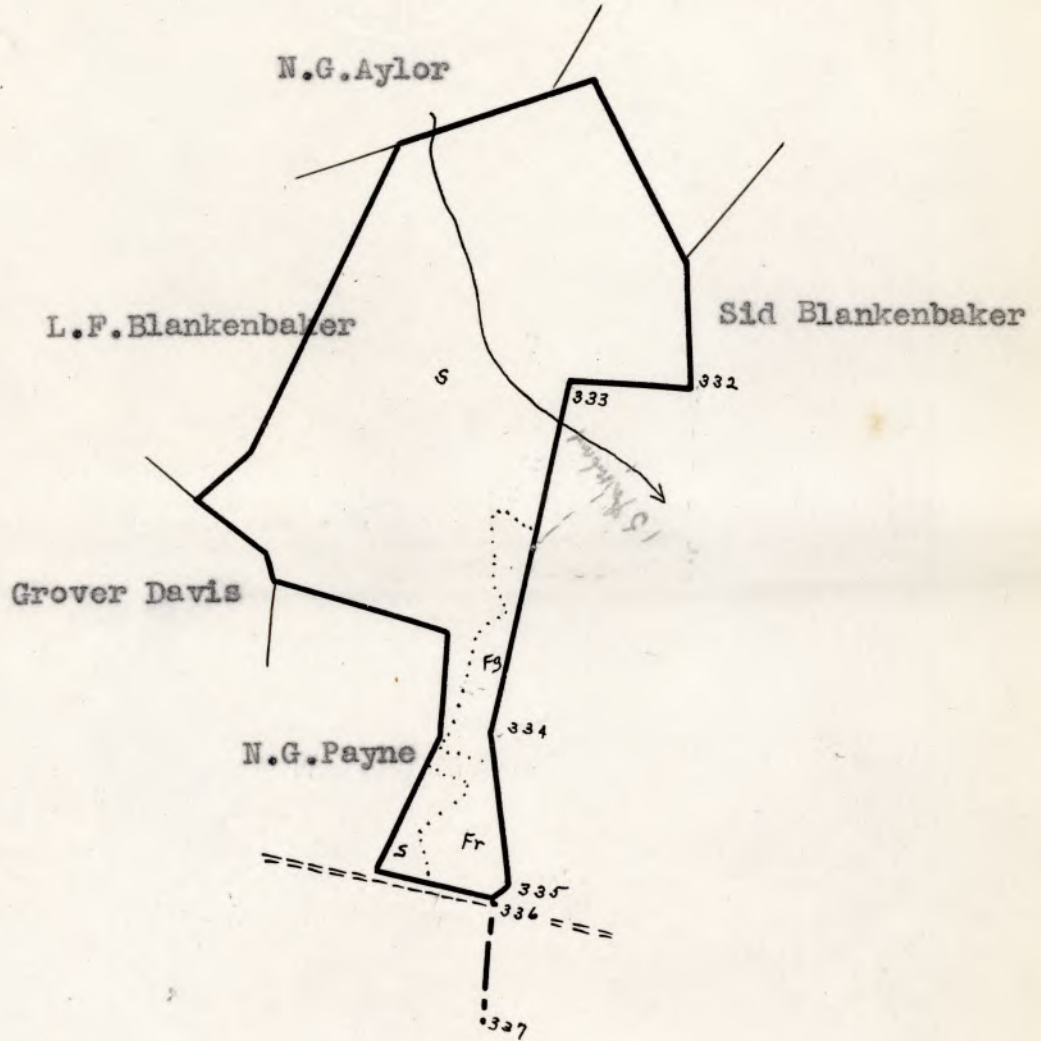

LEGEND:

Slope Grazing
Fields restocking
Scale - 1" = 20 chains

County: Madison
District: Rapidan

#267a- Cave & Payne

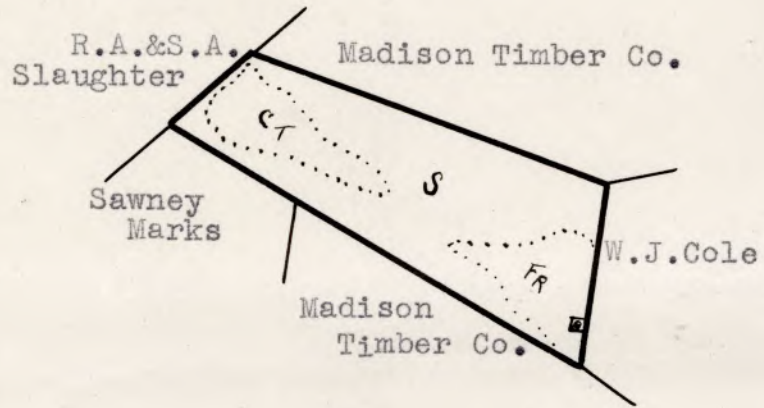

LEGEND:

Slope Cove
Restocking

Scale - 1" = 20 chains

County: Madison
District: Rapidan

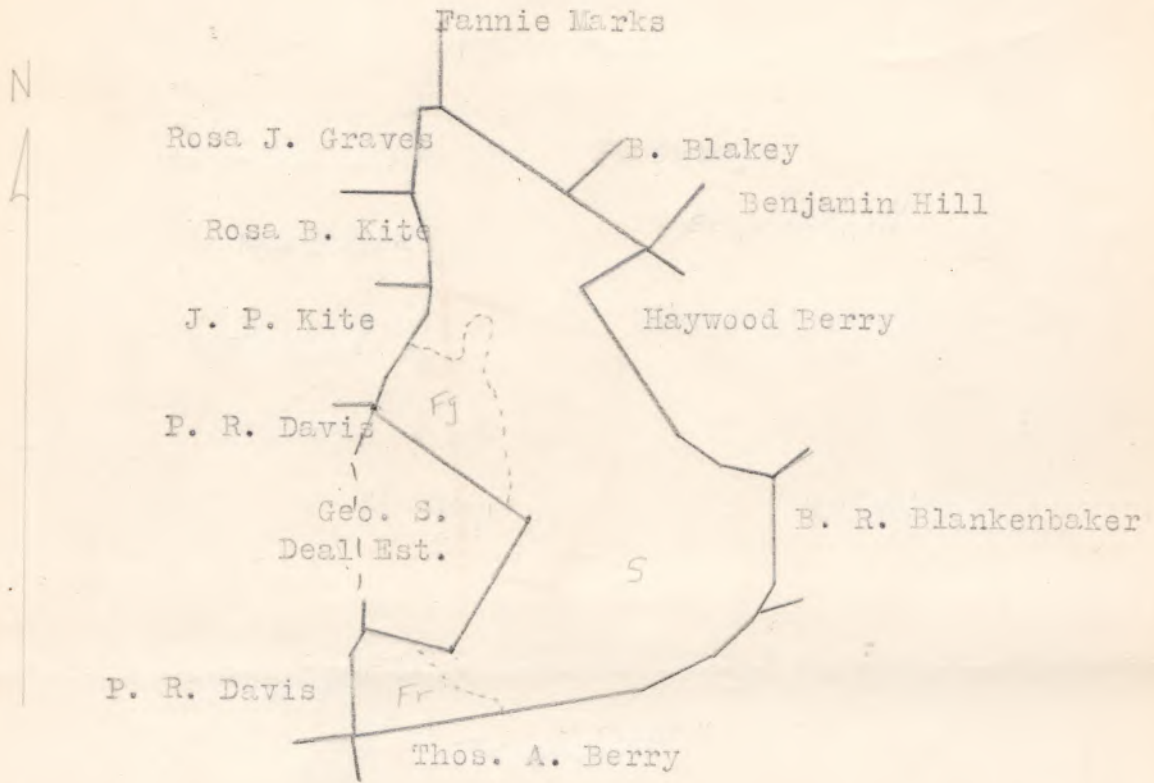

LEGEND
Slope

Grazing - Restocking
Scale - 1" = 20 chains

County: Madison
District: Rapidan

#267 - A. H. Cave & N. G. Payne

Acreage Claimed: 100 Assessed 200 Deed 100
Value Claimed: \$3,000.00 " \$1100 " -
Location: Pole Cat Branch near Ruth, Virginia, and is (partly) *entirely* within the Park area. Area: 185 A.

Incumbrances, counter claims or laps: None known.

Soil: Sandy clay loam of medium depth and fertility.

Roads: Six miles over county road to Madison; thence sixteen miles over state highway to Culpeper.

History of tract and condition of timber: All the merchantable saw timber was removed from this tract about four years ago.

Improvements: Dwelling: Frame, 14x20', 4 rooms, shingle roof, 1 1/2 story, fair condition, abandoned, spring water supply, pillar foundation ---- (\$60.00)
(This building has neither windows nor doors)
*Saw mill shanty
2 Non Houses*

Total Value Imp + \$110.++

Value of land by types:

Type	Acreage	Value per acre	Total Value
Slope	165	\$4.00	\$660.00
Fg	10	12.00	120.00
Fr	10	6.00	60.00
	<u>185</u>		<u>\$840.00</u>

Total value of land \$840.00
Total value of improvements 60.00
Total value of tract \$900.00
Average value per acre \$4.85

Claim of A. H. Carr
In the Circuit Court of Madison County, Virginia, No. 82, At Law.
The State Commission on Conservation and Development of the State of Virginia, Petitioner, vs. W. D. Anderson et als

100 acres of land
more or less, of land in Madison County, Virginia, Defendants.
The undersigned, in answer to the petition of the State Commission on Conservation and Development of the State of Virginia, and in response to the notice of condemnation awarded upon the filing of said petition and published in accordance with the order of the Circuit Court of Madison County, Virginia, asks leave of the Court to file this as his answer to said petition and to said notice.

My name is A. H. Carr
My Post Office Address is Madison

I claim a right, title, estate or interest in a tract or parcel of land within the area sought to be condemned, containing about 100 acres, on which there are the following buildings and improvements: Dwelling house

This land is located about 1/4 miles from Rich Virginia, in the Rapidan Magisterial District of said County.

I claim the following right, title, estate or interest in the tract or parcel of land described above: (In this space claimant should say whether he is sole owner or joint owner, and if joint owner give names of the joint owners. If claimant is not sole or joint owner, he should set out exactly what right, title, estate or interest he has in or to the tract or parcel of land described above).

1/2 interest

The land owners adjacent to the above described tract or parcel of land are as follows:
North Boyer + Cole
South Quint Road
East Eagan Marshall
West H. B. Boyer + others

I acquired my right, title, estate or interest to this property about the year 1929 in the following manner: By deed from H. B. Boyer Justice

I claim that the total value of this tract or parcel of land with the improvements thereon is \$ 1500.00. I claim that the total value of my right, title, estate or interest, in and to this tract or parcel of land with the improvements thereon is \$ 750.00

I am the owner of _____ acres of land adjoining the above described tract or parcel of land but lying outside the Park area, which I claim will be damaged by the proposed condemnation of lands within the Park area, to the extent of \$ _____.

(In the space below should be set out any additional statements or information as to this claim which claimant desires to make; and if practicable he should also insert here a description of the tract or parcel of land by metes and bounds).

Remarks: _____

(Continue remarks if necessary on the back).

Witness my signature (or my name and mark attached hereto) this 22 day of July, 1930.

STATE OF VIRGINIA, COUNTY OF Madison, To-wit:

The undersigned hereby certifies that A. H. Carr the above named claimant personally appeared before him and made oath that the matters and things appearing in his above answer are true to the best of his knowledge and belief, this 27 day of July, 1930.

Bonita M. Patten, Deputy
Clerk of the Court, or Special Investigator or Notary Public, or Justice of the Peace

Claim of W. S. Gentry
in the Circuit Court of Madison County, Virginia, No. 85, At Law
The State Commission on Conservation and Development of the State of Virginia, Petitioner, vs.

100 acres of land
more or less of land in Madison County, Virginia, Defendants.
The undersigned, in answer to the petition of the State Commission on Conservation and Development of the State of Virginia, and in response to the notice of condemnation awarded upon the filing of said petition and published in accordance with the order of the Circuit Court of Madison County, Virginia, asks leave of the Court to file this as his answer to said petition and to said notice.

My name is W. S. Gentry
My Post Office Address is Madison

I claim a right, title, estate or interest in a tract or parcel of land within the area sought to be condemned, containing about 100 acres, on which there are the following buildings and improvements:

This tract is located about 1/2 miles from Park in Madison District of said County, Virginia, in

I claim the following right, title, estate or interest in the tract or parcel of land described above: (In this space claimant should say whether he is sole owner or joint owner, and if joint owner give names of the joint owners. If claimant is not sole or joint owner, he should set out exactly what right, title, estate or interest he has in or to the tract or parcel of land described above.)
1/2 interest

The land owners adjacent to the above described tract or parcel of land are as follows:
North B. E. Gentry
South W. S. Gentry
East B. E. Gentry
West W. S. Gentry

I acquired my right, title, estate or interest to this property about the year 1923 in the following manner:
acquired from B. E. Gentry

I claim that the total value of this tract or parcel of land with the improvements thereon is \$ 10000. I claim that the total value of my right, title, estate or interest in and to this tract or parcel of land with the improvements thereon is \$ 7500. I am the owner of 1/2 acres of land adjoining the above described tract or parcel of land but lying outside the Park area, which I claim will be damaged by the proposed condemnation of lands within the Park area, to the extent of \$ 2500. (In the space below should be set out any additional statements or information as to this claim which claimant desires to make; and if practicable he should also insert here a description of the tract or parcel of land by metes and bounds.)

Remarks:

(Continue remarks if necessary on the back.)
Witness my signature (or my name and mark attached hereto) this 22 day

W. S. Gentry
of July, 1930.
STATE OF VIRGINIA, COUNTY OF Madison, To-wit:

The undersigned hereby certifies that the above named claimant personally appeared before him and made oath that the matters and things appearing in his above answer are true to the best of his knowledge and belief, this 22 day of July, 1930.

Arthur H. Baker
Clerk of the Court or Special Investigator or Notary Public or Justice of the Peace

Filed July 22, 1930
A. H. Lane, Clerk

A. H. Lane

Claim of A. H. Care
In the Circuit Court of Madison County, Virginia, No. 82, At Law.
The State Commission on Conservation and Development of the State of Virginia, Petitioner, vs. W. D. Anderson et al
100 acres of land

more or less, of land in Madison County, Virginia, Defendants.
The undersigned, in answer to the petition of the State Commission on Conservation and Development of the State of Virginia, and in response to the notice of condemnation awarded upon the filing of said petition and published in accordance with the order of the Circuit Court of Madison County, Virginia, asks leave of the Court to file this as his answer to said petition and to said notice.

My name is A. H. Care
My Post Office Address is Madison

I claim a right, title, estate or interest in a tract or parcel of land within the area sought to be condemned, containing about 100 acres, on which there are the following buildings and improvements: none

This land is located about 1/2 miles from Rath Virginia, in the Popidon Magisterial District of said County.

I claim the following right, title, estate or interest in the tract or parcel of land described above: (In this space claimant should say whether he is sole owner or joint owner, and if joint owner give names of the joint owners. If claimant is not sole or joint owner, he should set out exactly what right, title, estate or interest he has in or to the tract or parcel of land described above).
1/2 interest none

The land owners adjacent to the above described tract or parcel of land are as follows:
North B. R. Blankenship et al
South James & Rev. E. Marshall
East B. R. Blankenship
West L. F. Blankenship et al.

I acquired my right, title, estate or interest to this property about the year 1923 in the following manner:
by deed from J. E. Marshall
attorney in fact

I claim that the total value of this tract or parcel of land with the improvements thereon is \$ 1600.00. I claim that the total value of my right, title, estate or interest, in and to this tract or parcel of land with the improvements thereon is \$ 750.00.

I am the owner of _____ acres of land adjoining the above described tract or parcel of land but lying outside the Park area, which I claim will be damaged by the proposed condemnation of lands within the Park area, to the extent of \$ _____.
(In the space below should be set out any additional statements or information as to this claim which claimant desires to make; and if practicable he should also insert here a description of the tract or parcel of land by metes and bounds).

Remarks: _____

(Continue remarks if necessary on the back).

Witness my signature (or my name and mark attached hereto) this 22 day of July, 1930.

STATE OF VIRGINIA, COUNTY OF Madison, To-wit:
The undersigned hereby certifies that A. H. Care
the above named claimant personally appeared before him and made oath that the matters and things appearing in his above answer are true to the best of his knowledge and belief, this 22 day of July, 1930.

Bertha H. Patten Deputy
Clerk of the Court, or Special Investigator or
Notary Public, or Justice of the Peace

Claim of _____
In the Circuit Court of _____ County, Virginia, No. _____
The State Commission on Conservation and Development of the State of Virginia, Petitioner, vs. _____
more or less of land in _____ County, Virginia, Defendants.
The undersigned, in answer to the petition of the State Commission on Conservation and Development of the State of Virginia, and in response to the notice of condemnation awarded upon the filing of said petition and published in accordance with the order of the Circuit Court of _____ County, Virginia, asks leave of the Court to file this as his answer to said petition and to said notice.

My name is _____
My Post Office Address is _____
I claim a right, title, estate or interest in a tract or parcel of land within the area sought to be condemned, containing about _____ acres, on which there are the following buildings and improvements: _____

This tract is located about _____ miles from _____ in _____ Virginia, in _____
I claim the following right, title, estate or interest in the tract or parcel of land described above: (In this space claimant should say whether he is sole owner or joint owner, and if joint owner give names of the joint owners. If claimant is not sole or joint owner, he should set out exactly what right, title, estate or interest he has in or to the tract or parcel of land described above.)

The land owner adjacent to the above described tract or parcel of land are as follows:
North _____
South _____
East _____
West _____

I acquired my right, title, estate or interest to this property about the year _____ in the following manner: _____

I claim that the total value of this tract or parcel of land with the improvements thereon is \$ _____ I claim that the total value of my right, title, estate or interest in and to this tract or parcel of land with the improvements thereon is \$ _____
I am the owner of _____ acres of land adjoining the above described tract or parcel of land but lying outside the Park area, which I claim will be damaged by the proposed condemnation of lands within the Park area, to the extent of \$ _____
(In the space below should be set out any additional statements or information as to this claim which claimant desires to make; and if practicable he should also insert here a description of the tract or parcel of land by metes and bounds.)
Remarks: _____

(Continue remarks if necessary on the back.)
Witness my signature (or my name and mark attached hereto) this _____ day of _____ 1930.
To-wit: _____

The undersigned hereby certifies that _____ the above named claimant personally appeared before him and made oath that the matters and things appearing in his above answer are true to the best of his knowledge and belief, this _____ day of _____ 1930.
Clerk of the Court or Special Investigator or Notary Public or Justice of the Peace

Filed July 22, 1930.

A. H. Carr

Filed July 22, 1930.

#267

Claim of N. G. Payne

In the Circuit Court of Madison County, Virginia, No. _____, At Law.
The State Commission on Conservation and Development of the State of Virginia, Petitioner, vs. W. D. Anderson and others

One hundred acres of land

more or less, of land in Madison County, Virginia, Defendants.

The undersigned, in answer to the petition of the State Commission on Conservation and Development of the State of Virginia, and in response to the notice of condemnation awarded upon the filing of said petition and published in accordance with the order of the Circuit Court of Madison County, Virginia, asks leave of the Court to file this as his answer to said petition and to said notice.

My name is N. G. Payne

My Post Office Address is Madison, Va.

I claim a right, title, estate or interest in a tract or parcel of land within the area sought to be condemned, containing about 100 acres, on which there are the following buildings and improvements:

This land is located about 1/2 miles from Ruth Virginia, in the Rapidan Magisterial District of said County.

I claim the following right, title, estate or interest in the tract or parcel of land described above: (In this space claimant should say whether he is sole owner or joint owner, and if joint owner give names of the joint owners. If claimant is not sole or joint owner, he should set out exactly what right, title, estate or interest he has in or to the tract or parcel of land described above).

A one-half undivided interest in said land

The land owners adjacent to the above described tract or parcel of land are as follows:

North B. R. Blankenbaker and others

South Payne and Cave and Edgar Marshall

East B. R. Blankenbaker

West L. F. Blankenbaker's estate et al -

I acquired my right, title, estate or interest to this property about the year 1923 in the following manner:
By deed from T. E. Marshall, Attorney in fact -

I claim that the total value of this tract or parcel of land with the improvements thereon is \$ 1500.00. I claim that the total value of my right, title, estate or interest, in and to this tract or parcel of land with the improvements thereon is \$ 750.00.

I am the owner of _____ acres of land adjoining the above described tract or parcel of land but lying outside the Park area, which I claim will be damaged by the proposed condemnation of lands within the Park area, to the extent of \$ _____.

(In the space below should be set out any additional statements or information as to this claim which claimant desires to make; and if practicable he should also insert here a description of the tract or parcel of land by metes and bounds).

Remarks: _____

(Continue remarks if necessary on the back).

Witness my signature (or my name and mark attached hereto) this 12th day of July, 1930.

STATE OF VIRGINIA, COUNTY OF Madison, To-wit:

The undersigned hereby certifies that N. G. Payne the above named claimant personally appeared before him and made oath that the matters and things appearing in his above answer are true to the best of his knowledge and belief, this 22 day of July, 1930.

[Signature]
Clerk of the Court, or Special Investigator or Notary Public, or Justice of the Peace.

Claim of _____
 In the Circuit Court of _____
 The State Commission on Conservation and Development of the State of Virginia, Petitioner, vs. _____

One hundred acres of land
 more or less of land in _____
 The undersigned, in answer to the petition of the State Commission on Conservation and Development of the State of Virginia, and in response to the notice of condemnation awarded upon the filing of said petition and published in accordance with the order of the Circuit Court of _____
 My name is _____
 My Post Office Address is _____

I claim a right, title, estate or interest in a tract or parcel of land within the area sought condemned, containing about _____ acres, on which there are the following things and improvements:

_____ located about _____ miles from _____
 Magisterial District of said County.
 I claim the following right, title, estate or interest in the tract or parcel of land described above: (In this space claimant should say whether he is sole owner or joint owner, and if joint owner give names of the joint owners. If claimant is not sole or joint owner, he should set out exactly what right, title, estate or interest he has in or to the tract or parcel of land described above.)

 the land adjacent to the above described tract or parcel of land are as follows:

North _____
 South _____
 East _____
 West _____

I acquired my right, title, estate or interest in this property about the year _____ in the following manner:

I claim that the total value of this tract or parcel of land with the improvements thereon is \$ _____
 I claim that the total value of my right, title, estate or interest in and to this tract or parcel of land with the improvements thereon is \$ _____
 I am the owner of _____ acres of land adjoining the above described tract or parcel of land but lying outside the Park area, which I claim will be damaged by the proposed condemnation of lands within the Park area, to the extent of \$ _____
 (In the space below should be set out any additional statements or information as to this claim which claimant desires to make; and if practicable he should also insert here a description of the tract or parcel of land by metes and bounds.)

Remarks:

(Continue remarks if necessary on the back.)
 Witness my signature (or my name and mark attached hereto) this _____ day of _____ 1930.
 STATE OF VIRGINIA, COUNTY OF _____
 The undersigned hereby certifies that _____
 the above named claimant personally appeared before him and made oath that the matters and things appearing in his above answer are true to the best of his knowledge and belief, and things appearing in his above answer are true to the best of his knowledge and belief.
 this _____ day of _____ 1930.
 Clerk of the Court or Special Investigator or _____

Filed July 22, 1930

A. H. Carr
 Clerk

N. A. Payne

#267

Claim of N. G. Payne
In the Circuit Court of Madison County, Virginia, No. _____, At Law.
The State Commission on Conservation and Development of the State of Virginia, Petitioner, vs. W. D. Anderson and others -

One hundred acres of land,
more or less, of land in Madison County, Virginia, Defendants.
The undersigned, in answer to the petition of the State Commission on Conservation and Development of the State of Virginia, and in response to the notice of condemnation awarded upon the filing of said petition and published in accordance with the order of the Circuit Court of Madison County, Virginia, asks leave of the Court to file this as his answer to said petition and to said notice.

My name is N. G. Payne
My Post Office Address is Madison, Va.

I claim a right, title, estate or interest in a tract or parcel of land within the area sought to be condemned, containing about 100 acres, on which there are the following buildings and improvements: Dwelling house

This land is located about 1/4 miles from Ruth Virginia, in the Rapidan Magisterial District of said County.

I claim the following right, title, estate or interest in the tract or parcel of land described above: (In this space claimant should say whether he is sole owner or joint owner, and if joint owner give names of the joint owners. If claimant is not sole or joint owner, he should set out exactly what right, title, estate or interest he has in or to the tract or parcel of land described above).

One-half interest therein

The land owners adjacent to the above described tract or parcel of land are as follows:

- North Payne and Cave -
- South County road
- East h. Edgar Marshall
- West N. G. Payne and others -

I acquired my right, title, estate or interest to this property about the year 1929 in the following manner:

By deed from A. H. Cave and wife, dated November, 1929 -

I claim that the total value of this tract or parcel of land with the improvements thereon is \$ 1500.00. I claim that the total value of my right, title, estate or interest, in and to this tract or parcel of land with the improvements thereon is \$ 750.00 -

I am the owner of _____ acres of land adjoining the above described tract or parcel of land but lying outside the Park area, which I claim will be damaged by the proposed condemnation of lands within the Park area, to the extent of \$ _____.

(In the space below should be set out any additional statements or information as to this claim which claimant desires to make; and if practicable he should also insert here a description of the tract or parcel of land by metes and bounds).

Remarks: _____

(Continue remarks if necessary on the back).

Witness my signature (or my name and mark attached hereto) this 12th day of July, 1930.

STATE OF VIRGINIA, COUNTY OF Madison, To-wit:

The undersigned hereby certifies that N. G. Payne the above named claimant personally appeared before him and made oath that the matters and things appearing in his above answer are true to the best of his knowledge and belief, this 22 day of July, 1930.

[Signature]
Clerk of the Court, or Special Investigator or Notary Public, or Justice of the Peace.

Claim of _____
 In the Circuit Court of _____
 The State Commission on Conservation and Development of the State of Virginia, Petitioner, vs. _____
 One hundred acres of land
 more or less of land in _____
 The undersigned, in answer to the petition of the State Commission on Conservation and Development of the State of Virginia, and in response to the notice of condemnation awarded upon the filing of said petition and published in accordance with the order of the Circuit Court of _____
 as his answer to said petition and to said notice.
 My name is _____
 My Post Office Address is _____

I claim a right, title, estate or interest in a tract or parcel of land within the area sought to be condemned, containing about _____ acres, on which there are the following things and improvements: _____
 is located about _____ miles from _____
 Masterial District of said County.
 I claim the following right, title, estate or interest in the tract or parcel of land described above: (In this space claimant should say whether he is sole owner, joint owner, or if joint owner give names of the joint owners. If claimant is not sole owner, he should set out exactly what right, title, estate or interest he has in or to the tract or parcel of land described above.)
 The lands adjacent to the above described tract or parcel of land are as follows:
 North _____
 South _____
 East _____
 West _____
 I acquired my right, title, estate or interest to this property about the year _____ in the following manner:

I claim that the total value of this tract or parcel of land with the improvements thereon is \$ _____
 I claim that the total value of my right, title, estate or interest in and to this tract or parcel of land with the improvements thereon is \$ _____
 I am the owner of _____
 parcel of land but lying outside the Park area, which I claim will be damaged by the proposed condemnation of lands within the Park area, to the extent of \$ _____
 (In the space below should be set out any additional statements or information as to this claim which claimant desires to make; and if practicable he should also insert here a description of the tract or parcel of land by metes and bounds.)
 Remarks: _____

(Continue remarks if necessary on the back).
 Witness my signature (or my name and mark attached hereto) this _____ day of _____, 1930.
 STATE OF VIRGINIA, COUNTY OF _____
 The undersigned hereby certifies that _____
 the above named claimant personally appeared before him and made oath that the matters and things appearing in his above answer are true to the best of his knowledge and belief.
 this _____ day of _____, 1930.
 Clerk of the Court or Special Investigator or
 Notary Public or Justice of the Peace

copied
Rafidan Nlick

Filed July 22, 1930.
W. G. Payne
A. H. Carr
clerk

W. G. Payne

Claim of A. H. Care
In the Circuit Court of Madison County, Virginia, No. 82, At Law.
The State Commission on Conservation and Development of the State of Virginia, Petitioner, vs W. S. Anderson et al
66 1/4 acres of land

more or less, of land in Madison County, Virginia, Defendants.
The undersigned, in answer to the petition of the State Commission on Conservation and Development of the State of Virginia, and in response to the notice of condemnation awarded upon the filing of said petition and published in accordance with the order of the Circuit Court of Madison County, Virginia, asks leave of the Court to file this as his answer to said petition and to said notice.

My name is A. H. Care
My Post Office Address is Madison

I claim a right, title, estate or interest in a tract or parcel of land within the area sought to be condemned, containing about _____ acres, on which there are the following buildings and improvements: Shedding

This land is located about 5 miles from Walston Virginia, in the Popson Magisterial District of said County.

I claim the following right, title, estate or interest in the tract or parcel of land described above: (In this space claimant should say whether he is sole owner or joint owner, and if joint owner give names of the joint owners. If claimant is not sole or joint owner, he should set out exactly what right, title, estate or interest he has in or to the tract or parcel of land described above).

1/2 undivided interest

The land owners adjacent to the above described tract or parcel of land are as follows:
North Gale & others
South Madison Timber Corp
East Rose et al
West J. W. Mauck

I acquired my right, title, estate or interest to this property about the year 1925 in the following manner: by deed from J. L. Frie low

I claim that the total value of this tract or parcel of land with the improvements thereon is \$ 662.50. I claim that the total value of my right, title, estate or interest, in and to this tract or parcel of land with the improvements thereon is \$ 331.25

I am the owner of _____ acres of land adjoining the above described tract or parcel of land but lying outside the Park area, which I claim will be damaged by the proposed condemnation of lands within the Park area, to the extent of \$ _____.

(In the space below should be set out any additional statements or information as to this claim which claimant desires to make; and if practicable he should also insert here a description of the tract or parcel of land by metes and bounds).

Remarks: _____

(Continue remarks if necessary on the back).

Witness my signature (or my name and mark attached hereto) this 22 day of _____, 1930.

STATE OF VIRGINIA, COUNTY OF Madison, To-wit:

The undersigned hereby certifies that A. H. Care the above named claimant personally appeared before him and made oath that the matters and things appearing in his above answer are true to the best of his knowledge and belief, this 22 day of July, 1930.

Betha N. Patten, Deputy
Clerk of the Court, or Special Investigator or Notary Public, or Justice of the Peace.

Claim of *W. H. Garrison*
In the Circuit Court of *Rockingham* County, Virginia, No. *8*, At Law.
The State Commission on Conservation and Development of the State of Virginia, Petitioner, vs. *W. H. Garrison*

more or less of land in *Rockingham* County, Virginia, Defendants.
The undersigned, in answer to the petition of the State Commission on Conservation and Development of the State of Virginia, and in response to the notice of condemnation awarded upon the filing of said petition and published in accordance with the order of the Circuit Court of *Rockingham* County, Virginia, asks leave of the Court to file this as his answer to said petition and to said notice.

My name is *W. H. Garrison*
My Post Office Address is *Rockingham*

I claim a right, title, estate or interest in a tract or parcel of land within the area sought to be condemned, containing about *5* acres, on which there are the following buildings and improvements: *Shed*

The land is located about *5* miles from *Wolfpen*, Virginia, in the *Rockingham* Magisterial District of said County.

I claim the following right, title, estate or interest in the tract or parcel of land described above: (In this space claimant should say whether he is sole owner or joint owner, and if joint owner give names of the joint owners. If claimant is not sole or joint owner, he should set out exactly what right, title, estate or interest he has in or to the tract or parcel and described above.)
1/2 undivided interest

The land owners adjacent to the above described tract or parcel of land are as follows:
North *W. H. Garrison*
South *W. H. Garrison*
East *W. H. Garrison*
West *W. H. Garrison*

I acquired my right, title, estate or interest to this property about the year *1912* in the following manner: *By deed from W. H. Garrison*

I claim that the total value of this tract or parcel of land with the improvements thereon is \$ *50.00*. I claim that the total value of my right, title, estate or interest in and to this tract or parcel of land with the improvements thereon is \$ *23.21*.
I am the owner of *5* acres of land adjoining the above described tract or parcel of land but lying outside the Park area, which I claim will be damaged by the proposed condemnation of lands within the Park area to the extent of \$ *200.00*.
(In the space below should be set out any additional statements or information as to this claim which claimant desires to make; and if practicable he should also insert here a description of the tract or parcel of land by metes and bounds.)

Remarks:

(Continue remarks if necessary on the back).
Witness my signature (or my name and mark attached hereto) this *22* day of *July*, 1930.

STATE OF VIRGINIA, COUNTY OF *Rockingham*.
To-wit: *W. H. Garrison*

The undersigned hereby certifies that *W. H. Garrison* the above named claimant personally appeared before him and made oath that the matters and things appearing in his above answer are true to the best of his knowledge and belief, this *22* day of *July*, 1930.

Notary Public or Justice of the Peace
Clerk of the Court or Special Investigator
W. H. Garrison

A. H. Case

Filed July 22, 1930

Rockingham
W. H. Garrison

Claim of N. G. Payne
In the Circuit Court of Madison County, Virginia, No. _____, At Law.
The State Commission on Conservation and Development of the State of Virginia, Petitioner, vs. W. D. Anderson and others -
66 1/4 acres of land,

more or less, of land in Madison County, Virginia, Defendants.
The undersigned, in answer to the petition of the State Commission on Conservation and Development of the State of Virginia, and in response to the notice of condemnation awarded upon the filing of said petition and published in accordance with the order of the Circuit Court of Madison County, Virginia, asks leave of the Court to file this as his answer to said petition and to said notice.

My name is N. G. Payne
My Post Office Address is Madison, Va.

I claim a right, title, estate or interest in a tract or parcel of land within the area sought to be condemned, containing about 66 1/4 acres, on which there are the following buildings and improvements: Dwelling -

This land is located about 5 miles from Walftown Virginia, in the Madison Magisterial District of said County.

I claim the following right, title, estate or interest in the tract or parcel of land described above: (In this space claimant should say whether he is sole owner or joint owner, and if joint owner give names of the joint owners. If claimant is not sole or joint owner, he should set out exactly what right, title, estate or interest he has in or to the tract or parcel of land described above).

A one-half undivided interest in said land -

The land owners adjacent to the above described tract or parcel of land are as follows:

- North Cole and others
- South Ward Rue Lumber Co.
- East Rose and others -
- West F. W. Mauck

I acquired my right, title, estate or interest to this property about the year _____ in the following manner:

By deed from J. L. Fincham and wife, dated August 26th 1925, and recorded in deed book 47, page 244 -

I claim that the total value of this tract or parcel of land with the improvements thereon is \$ 662.50. I claim that the total value of my right, title, estate or interest, in and to this tract or parcel of land with the improvements thereon is \$ 331.25

I am the owner of _____ acres of land adjoining the above described tract or parcel of land but lying outside the Park area, which I claim will be damaged by the proposed condemnation of lands within the Park area, to the extent of \$ _____

(In the space below should be set out any additional statements or information as to this claim which claimant desires to make; and if practicable he should also insert here a description of the tract or parcel of land by metes and bounds).

Remarks: _____

(Continue remarks if necessary on the back).

Witness my signature (or my name and mark attached hereto) this 22nd day of July, 1930.

STATE OF VIRGINIA, COUNTY OF Madison, To-wit:

The undersigned hereby certifies that N. G. Payne the above named claimant personally appeared before him and made oath that the matters and things appearing in his above answer are true to the best of his knowledge and belief, this 22 day of July, 1930.

Att. Cave
Clerk of the Court, or Special Investigator or Notary Public, or Justice of the Peace.

Claim of _____
in the Circuit Court of _____
The State Commission on Conservation and Development of the State of Virginia, Petitioner, vs. _____ and others -

more or less of land in _____
The undersigned, in answer to the petition of the State Commission on Conservation and Development of the State of Virginia, and in response to the notice of condemnation awarded upon the filing of said petition and published in accordance with the order of the Circuit Court of _____
as his answer to said petition and to said notice.

My name is _____
My Post Office Address is _____

I claim a right, title, estate or interest in a tract or parcel of land within the area sought to be condemned, containing about _____ acres, on which there are the following things and improvements:

The land owners adjacent to the above described tract or parcel of land are as follows:
North _____
South _____
East _____
West _____

I acquired my right, title, estate or interest to this property about the year _____ in the following manner:
By deed from J. J. Vinson and wife, dated August 28th 1928, and recorded in deed book 47, page 244 -

I claim that the total value of this tract or parcel of land with the improvements thereon is \$ _____
I claim that the total value of my right, title, estate or interest in and to this tract or parcel of land with the improvements thereon is \$ _____
I am the owner of _____ acres of land adjoining the above described tract or parcel of land but lying outside the Park area, which I claim will be damaged by the proposed condemnation of lands within the Park area, to the extent of \$ _____
(In the space below should be set out any additional statements or information as to this claim which claimant desires to make; and if practicable he should also insert here a description of the tract or parcel of land by metes and bounds.)

Remarks: _____

(Continue remarks if necessary on the back.)
Witness my signature (or my name and mark attached hereto) this _____ day _____

STATE OF VIRGINIA, COUNTY OF _____
The undersigned hereby certifies that _____
the above named claimant personally appeared before him and made oath that the matters and things appearing in his above answer are true to the best of his knowledge and belief.
this _____ day of _____, 1930.

Notary Public or Justice of the Peace
Clerk of the Court or Special Investigator or

Filed July 22, 1930.
W. H. Payne
Clk

W. H. Payne

Claim of A. H. Carr
In the Circuit Court of Madison County, Virginia, No. 82, At Law.
The State Commission on Conservation and Development of the State of Virginia, Petitioner, vs. W. D. Anderson et al.
160 acres of land

more or less, of land in Madison County, Virginia, Defendants.
The undersigned, in answer to the petition of the State Commission on Conservation and Development of the State of Virginia, and in response to the notice of condemnation awarded upon the filing of said petition and published in accordance with the order of the Circuit Court of Madison County, Virginia, asks leave of the Court to file this as his answer to said petition and to said notice.

My name is A. H. Carr
My Post Office Address is Madison

I claim a right, title, estate or interest in a tract or parcel of land within the area sought to be condemned, containing about 160 acres, on which there are the following buildings and improvements: none

This land is located about 2 miles from Paul Virginia, in the Rapids Magisterial District of said County.

I claim the following right, title, estate or interest in the tract or parcel of land described above: (In this space claimant should say whether he is sole owner or joint owner, and if joint owner give names of the joint owners. If claimant is not sole or joint owner, he should set out exactly what right, title, estate or interest he has in or to the tract or parcel of land described above).
1/2 interest

The land owners adjacent to the above described tract or parcel of land are as follows:
North J. A. Jarrill
South Bowd Blaker
East Legal Greenway
West None or other

I acquired my right, title, estate or interest to this property about the year 1930 in the following manner:
By deed from N. B. Payne

I claim that the total value of this tract or parcel of land with the improvements thereon is \$ 1920.00 I claim that the total value of my right, title, estate or interest, in and to this tract or parcel of land with the improvements thereon is \$ 960.00

I am the owner of _____ acres of land adjoining the above described tract or parcel of land but lying outside the Park area, which I claim will be damaged by the proposed condemnation of lands within the Park area, to the extent of \$ _____

(In the space below should be set out any additional statements or information as to this claim which claimant desires to make; and if practicable he should also insert here a description of the tract or parcel of land by metes and bounds).

Remarks: _____

(Continue remarks if necessary on the back).

Witness my signature (or my name and mark attached hereto) this 22 day of July, 1930.

STATE OF VIRGINIA, COUNTY OF Madison, To-wit:

The undersigned hereby certifies that A. H. Carr the above named claimant personally appeared before him and made oath that the matters and things appearing in his above answer are true to the best of his knowledge and belief, this 22 day of July, 1930.

Bertha N. Patten
Clerk of the Court, or Special Investigator or Notary Public, or Justice of the Peace.

Claim of
In the Circuit Court of the State of Virginia, County of Madison,
The State Commission on Conservation and Development of the State of Virginia, Petitioner,
vs.
W. B. Cunningham et al.

more or less of land in Madison County, Virginia, Defendants.
The undersigned, in answer to the petition of the State Commission on Conservation and Development of the State of Virginia, and in response to the notice of condemnation awarded upon the filing of said petition and published in accordance with the order of the Circuit Court of Madison County, Virginia, asks leave of the Court to file this as his answer to said petition and to said notice.

My name is W. B. Cunningham
My Post Office Address is Madison

I claim a right title, estate or interest in a tract or parcel of land within the area sought to be condemned, containing about 100 acres, on which there are the following buildings and improvements:

The tract is located about 5 miles from Paris in Madison District of said County, Virginia, in

I claim the following right title, estate or interest in the tract of parcel of land described above: (In this space claimant should say whether he is sole owner or joint owner, and if joint owner give names of the joint owners. If claimant is not sole or joint owner, he should set out exactly what right title, estate or interest he has in or to the tract or parcel of land described above.)
1/2 interest

The land owners adjacent to the above described tract or parcel of land are as follows:
North
South
East
West

I acquired my right, title, estate or interest to this property about the year 1920 in the following manner:
From W. B. Cunningham

I claim that the total value of this tract or parcel of land with the improvements thereon is \$ 19300. I claim that the total value of my right, title, estate or interest in and to this tract or parcel of land with the improvements thereon is \$ 2000.
I am the owner of 100 acres of land adjoining the above described tract or parcel of land but lying outside the Park area, which I claim will be damaged by the proposed condemnation of lands within the Park area to the extent of \$ 2000.
(In the space below should be set out any additional statements or information as to this claim which claimant desires to make; and if practicable he should also insert here a description of the tract or parcel of land by metes and bounds.)

Remarks:

(Continue remarks if necessary on the back.)

Witness my signature (or my name and mark attached hereto) this 12 day of July, 1930.

The undersigned hereby certifies that the above named claimant personally appeared before him and made oath that the matters and things appearing in his above answer are true to the best of his knowledge and belief, and things appearing in his above answer are true to the best of his knowledge and belief, this 12 day of July, 1930.

Clerk of the Court or Special Investigator or Notary Public or Justice of the Peace
W. B. Cunningham

Filed July 22, 1930.
T. H. H. H. H.
Arthur H. Wallis, Jr.

A. H. Case -

Claim of N. G. Payne
In the Circuit Court of Madison County, Virginia, No. _____, At Law.
The State Commission on Conservation and Development of the State of Virginia, Petitioner, vs. W. D. Anderson and others

more or less, of land in Madison County, Virginia, Defendants.
The undersigned, in answer to the petition of the State Commission on Conservation and Development of the State of Virginia, and in response to the notice of condemnation awarded upon the filing of said petition and published in accordance with the order of the Circuit Court of Madison County, Virginia, asks leave of the Court to file this as his answer to said petition and to said notice.

My name is N. G. Payne
My Post Office Address is Madison, Va.

I claim a right, title, estate or interest in a tract or parcel of land within the area sought to be condemned, containing about 160 acres, on which there are the following buildings and improvements:

This land is located about two miles from Ruth Virginia, in the Rapidan Magisterial District of said County.

I claim the following right, title, estate or interest in the tract or parcel of land described above: (In this space claimant should say whether he is sole owner or joint owner, and if joint owner give names of the joint owners. If claimant is not sole or joint owner, he should set out exactly what right, title, estate or interest he has in or to the tract or parcel of land described above).

A one-half undivided interest in said land

The land owners adjacent to the above described tract or parcel of land are as follows:
North T. A. Jarrell
South Rawl Blakey
East Deal, Gallehugh et al -
West Kite and others -

I acquired my right, title, estate or interest to this property about the year 1930 in the following manner:
BY deed from A. H. Cave, dated March _____, 1930 -

I claim that the total value of this tract or parcel of land with the improvements thereon is \$ 1920.00. I claim that the total value of my right, title, estate or interest, in and to this tract or parcel of land with the improvements thereon is \$ 960.00

I am the owner of _____ acres of land adjoining the above described tract or parcel of land but lying outside the Park area, which I claim will be damaged by the proposed condemnation of lands within the Park area, to the extent of \$ _____.

(In the space below should be set out any additional statements or information as to this claim which claimant desires to make; and if practicable he should also insert here a description of the tract or parcel of land by metes and bounds).

Remarks: _____

(Continue remarks if necessary on the back).

Witness my signature (or my name and mark attached hereto) this 22nd day of July, 1930.

STATE OF VIRGINIA, COUNTY OF Madison, To-wit:

The undersigned hereby certifies that N. G. Payne the above named claimant personally appeared before him and made oath that the matters and things appearing in his above answer are true to the best of his knowledge and belief, this 22 day of July, 1930.

W. D. Anderson
Clerk of the Court, or Special Investigator or Notary Public, or Justice of the Peace

Claim of _____
in the Circuit Court of _____
The State Commission on Conservation and Development of the State of Virginia, Petitioner, vs _____

more or less of land in _____
The undersigned, in answer to the petition of the State Commission on Conservation and Development of the State of Virginia, and in response to the notice of condemnation awarded upon the filing of said petition and published in accordance with the order of the Circuit Court of _____
County, Virginia, asks leave of the Court to file this as his answer to said petition and to said notice.

My name is _____
My Post Office Address is _____

I claim a right, title, estate or interest in a tract or parcel of land within the area sought to be condemned, containing about _____ acres, on which there are the following things and improvements:

The land is located about _____ miles from _____
Magisterial District of said County.

I claim the following right, title, estate or interest in the tract or parcel of land described above: (In this space claimant should say whether he is sole owner or joint owner, and if joint owner give names of the joint owners. If claimant is not sole or joint owner, he should say exactly what right, title, estate or interest he has in or to the tract or parcel of land described above.)

The land is adjacent to the above described tract or parcel of land as follows:

North _____
South _____
East _____
West _____

I acquired my right, title, estate or interest in this property about the year _____ in the following manner: _____

I claim that the total value of this tract or parcel of land with the improvements thereon is \$ _____
I claim that the total value of my right, title, estate or interest in and to this tract or parcel of land with the improvements thereon is \$ _____

I am the owner of _____
acres of land adjoining the above described tract or parcel of land but lying outside the Park area, which I claim will be damaged by the proposed condemnation of lands within the Park area to the extent of \$ _____

(In the space below should be set out any additional statements or information as to this claim which claimant desires to make; and if practicable he should also insert here a description of the tract or parcel of land by metes and bounds.)

Remarks: _____

(Continue remarks if necessary on the back.)
Witness my signature (or my name and mark attached hereto) this _____ day of _____ 1930.

The undersigned hereby certifies that _____
the above named claimant personally appeared before him and made oath that the matters and things appearing in his above answer are true to the best of his knowledge and belief.
this _____ day of _____ 1930.

Clerk of the Court or Special Investigator or
Notary Public, in Justice of the Peace

Filed July 23, 1930.

John A. Clark

W. H. Parker