

County: Madison
District: Roberson

Claimant #217 - Chapman, Mary B.

Acreage Found: 68 Assessed 178 Deed 185.7

Location: East of Hoover Road. Partly inside Park Area.

Incumbrances, counter claims or laps: None known.

Soil: Shallow sandy loam on slopes, rich loam on cove. Slopes are steep and rocky.

Roads: Three miles to Criglersville; thence seventeen miles via improved highway to Culpeper, nearest railroad.

History of tract and condition of timber: Mature poplar, red oak and chestnut oak on east slope. Ridge timber stunted and defective. Land not burned recently.

61 M. ft. poplar
24 " " red oak
20 " " chestnut oak
18 " " miscellaneous sp.
123 M. ft. @ \$4.00 -- \$492.00.

Value of land by types:

<u>Type</u>	<u>Acreage</u>	<u>Value per acre -</u>	<u>Total Value</u>
Slope & Cove	68	\$5.00	\$340.00

Summary:

Total value of land.	\$340.00
Total value of timber.	\$492.00
Total value of tract.	<u>\$832.00.</u>

L. W. Farmer, Sec.

County: Madison
District: Roberson

#217- Chapman, Mary B.

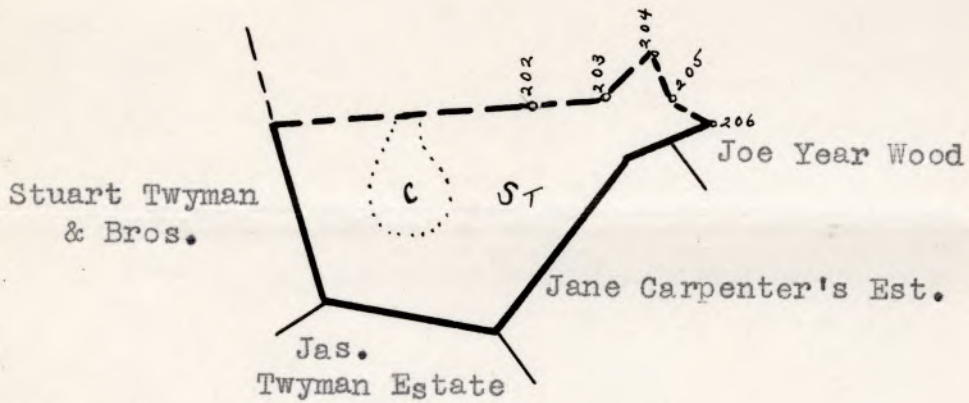

LEGEND:

Slope Cove
Scale - 1" = 20 chains

Claim of M. B. Chapman
In the Circuit Court of Madison County, Virginia, No. _____, At Law.
The State Commission on Conservation and Development of the State of Virginia, Petitioner, vs. M. B. Chapman

more or less, of land in Madison County, Virginia, Defendants.
The undersigned, in answer to the petition of the State Commission on Conservation and Development of the State of Virginia, and in response to the notice of condemnation awarded upon the filing of said petition and published in accordance with the order of the Circuit Court of Madison County, Virginia, asks leave of the Court to file this as his answer to said petition and to said notice.

My name is M. B. Chapman
My Post Office Address is 701 Locust Ave. Charlottesville Va.

I claim a right, title, estate or interest in a tract or parcel of land within the area sought to be condemned, containing about 1.86 acres, on which there are the following buildings and improvements: House, stable and other out houses.

This land is located about 3 miles from Crighdenville Virginia, in the Robertson Magisterial District of said County.

I claim the following right, title, estate or interest in the tract or parcel of land described above: (In this space claimant should say whether he is sole owner or joint owner, and if joint owner give names of the joint owners. If claimant is not sole or joint owner, he should set out exactly what right, title, estate or interest he has in or to the tract or parcel of land described above).

M. B. Chapman, C. A. Chapman and Mrs. C. B. Parrott.

The land owners adjacent to the above described tract or parcel of land are as follows:
North H. T. Seal and B. S. Uty
South A. W. Berry and Yeaswood
East B. S. Uty and T. L. Chapman
West Stewart Tugman and H. T. Seal

I acquired my right, title, estate or interest to this property about the year 1911 in the following manner: Bought from B. S. Chapman

I claim that the total value of this tract or parcel of land with the improvements thereon is \$ 3,500. I claim that the total value of my right, title, estate or interest, in and to this tract or parcel of land with the improvements thereon is \$ 1,166.66 2/3

I am the owner of _____ acres of land adjoining the above described tract or parcel of land but lying outside the Park area, which I claim will be damaged by the proposed condemnation of lands within the Park area, to the extent of \$ _____.
(In the space below should be set out any additional statements or information as to this claim which claimant desires to make; and if practicable he should also insert here a description of the tract or parcel of land by metes and bounds).

Remarks: _____

(Continue remarks if necessary on the back).

Witness my signature (or my name and mark attached hereto) this 25 day of July, 1930. M. B. Chapman

STATE OF VIRGINIA, COUNTY OF Charlottesville, To-wit:

The undersigned hereby certifies that M. B. Chapman the above named claimant personally appeared before him and made oath that the matters and things appearing in his above answer are true to the best of his knowledge and belief, this 25 day of July, 1930.

J. Nat. Bramley, Jr.
Clerk of the Court, or Special Investigator or Notary Public, or Justice of the Peace.

M. B. Chapman
1930

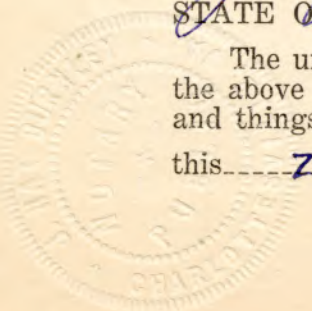

Claim of M. B. Chapman
in the Circuit Court of Mecklenburg County, Virginia, No. ...
The State Commission on Conservation and Development of the State of Virginia, Petitioner, vs. M. B. Chapman

more or less of land in Mecklenburg County, Virginia, Defendants.
The undersigned, in answer to the petition of the State Commission on Conservation and Development of the State of Virginia, and in response to the notice of condemnation awarded upon the filing of said petition and published in accordance with the order of the Circuit Court of Mecklenburg County, Virginia, asks leave of the Court to file this as his answer to said petition and to said notice.

My name is M. B. Chapman
My Post Office Address is 701 ...

I claim a right, title, estate or interest in a tract or parcel of land within the area sought to be condemned, containing about 1.85 acres, on which there are the following buildings and improvements:

This land is located about 3 miles from ...
the ... District of said County.

I claim the following right, title, estate or interest in the tract or parcel of land described above: In this space claimant should say whether he is sole owner or joint owner, and if joint owner give names of the joint owners. If claimant is not sole or joint owner, he should set out exactly what right, title, estate or interest he has in or to the tract or parcel of land described above.

M. B. Chapman, ...
Mrs. C. B. ...

The land owners adjacent to the above described tract or parcel of land are as follows:

North ...
South ...
East ...
West ...

I acquired my right, title, estate or interest to this property about the year 1911 in the following manner:

Bought from ...

I claim that the total value of this tract or parcel of land with the improvements thereon is \$3,200. I claim that the total value of my right, title, estate or interest and to this tract or parcel of land with the improvements thereon is \$11,500.00.

I am the owner of ... acres of land adjoining the above described tract or parcel of land but lying outside the Park area, which I claim will be damaged by the proposed condemnation of lands within the Park area, to the extent of \$...

(In the space below should be set out any additional statements or information as to this claim which claimant desires to make; and if practicable he should also insert here a description of the tract or parcel of land by metes and bounds.)

Remarks:

(Continue remarks if necessary on the back.)
Witness my signature (or my name and mark attached hereto) this 22 day of July, 1930.

M. B. Chapman
STATE OF VIRGINIA, COUNTY OF ... To-wit:

The undersigned hereby certifies that the above named claimant personally appeared before him and made oath that the facts appearing in his above answer are true to the best of his knowledge and belief.

day of July, 1930.
Clerk of the Court or Special Investigator or Notary Public or Justice of the Peace

M. B. Chapman
Filed July 26-1930
Recd: Clerk's Office

