

County: Madison
District: Roberson

Claimant #234 - Davis, Hamp

Acreage Found: 200 Assessed 200 Deed 200 (1913)

Location: East side German Ridge. Park boundary on northeast side.

Incumbrances, counter claims or laps: C. L. Blakey lap. See 239-I.

Soil: Sandy loam. Slopes from moderate to steep and rocky.

Roads: Three miles to Criglersville; thence seventeen miles to Culpeper via State Highway to the nearest railroad point.

History of tract and condition of timber: Some cutting of poplar past year for local mill. Oak and poplar culled on lower slopes. Five acres burned on ridge, spring 1931.

Chestnut oak	--	108 M.
Poplar	--	34
Hickory & oaks	-	34
		<hr/>
		176 M. @ \$3.00 -- \$528.00.

Improvements: Dwelling: 25x31', 6 rooms, porch 7x17', shingle and paper roof, stone flues, 1½ story, ceiled, fair condition, occupied by owner, spring water supply, solid foundation, basement, 3 rooms.
Barn: Frame, 28x47', shingle roof, fair condition.
Meat house: Frame, 8x11x8', shingle roof, fair condition.
Old kitchen: Log, 14x15', paper roof, stone flue, poor condition.
Chicken house: Frame, 8x18x7', paper roof, good condition.
Hen house: Frame, 10x14', shingle roof, fair condition.
Five walnut trees @ \$3.00 -- \$15.00.
Cowbarn and shed: Log, 19x20', shingle roof, poor condition.
Hen house: Frame, 10x13', paper roof, good condition.
Corn house and sheds: Log and frame, 23x27', shingle roof, fair condition.

Total value of improvements -- \$710.00.

Value of land by types:

Type	Acreage	Value per acre	Total Value
Fc	42	\$15.00	\$630.00
Fg	21	\$15.00	\$315.00
Fr	11	5.00	55.00
Slope	121	3.00	\$363.00
Orchard	5	\$80.00	\$400.00
		<hr/>	<hr/>
		200	\$1363.00

Summary:

Total value of land.	\$1363.00
Total value of improvements.	710.00
Total value of timber.	528.00
Total value of orchard.	400.00
Total value of tract.	<hr/>
	\$3001.00

L. H. Farmer, Sec.

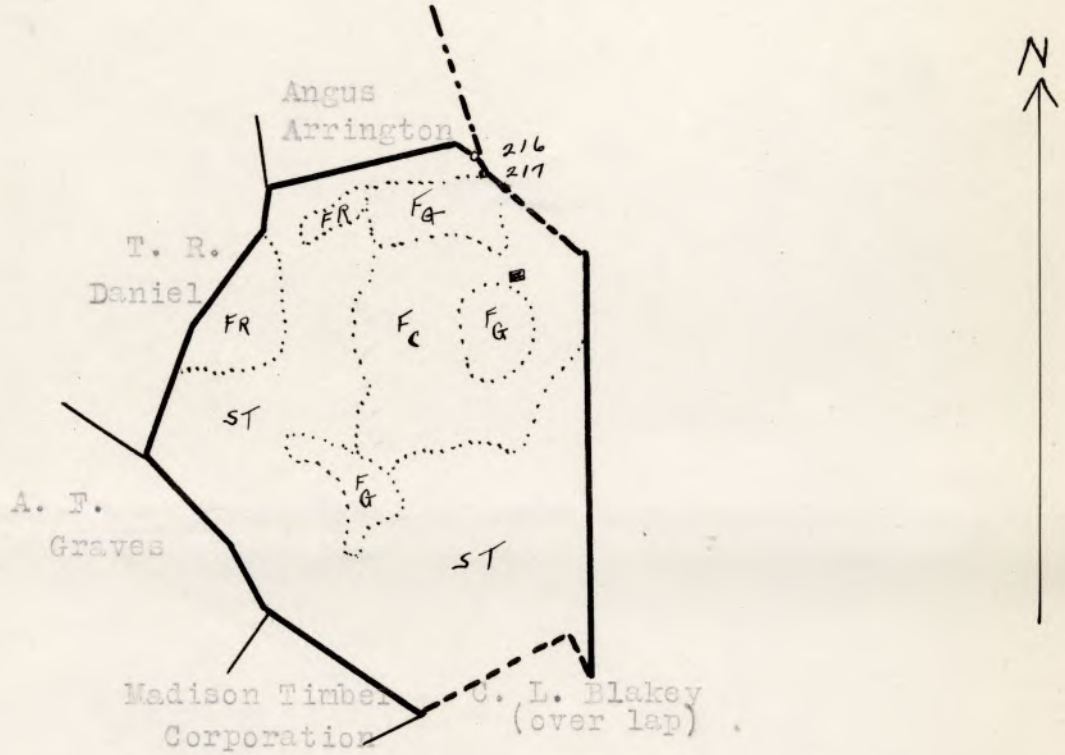

LEGEND
Tillable - Grazing
Restocking - Slope
Orchard
Scale - 1" = 20 chains

County: Madison
District: Roberson

#234 - Davis, Hamp

<u>Acres Claimed:</u>	200	Assessed	200	Deed	200
<u>Value Claimed:</u>	\$10,000	"	\$1300.00	"	(1913) \$1800.
					Area: 196 A.

Location: East side German Ridge. Park boundary on northeast side.

Incumbrances, counter claims or laps: C. L. Blakey lap. See 239-I.

Soil: Sandy loam. Slopes from moderate to steep and rocky.

Roads: Three miles to Criglersville; thence seventeen miles to Culpeper via state highway to the nearest railroad point.

History of tract and condition of timber: Some cutting of poplar past year for local mill. Oak and poplar culled on lower slopes. Five acres burned on ridge, spring 1931.

Chestnut oak	--	108 M.	
Poplar	--	34	
Hickory and oaks	--	34	
		176 M.	@ \$3.00 = \$528.00

Improvements:

<u>Dwelling:</u> 25x31', 6 rooms, porch 7x17', shingle and paper roof, stone flues, 1½ story, ceiled, fair condition, occupied by owner, spring water supply, solid foundation, basement, 3 rooms. --	\$265.00
<u>Barn:</u> Frame, 28x47', shingle roof, fair condition --	75.00
<u>Meat house:</u> Frame, 8x11x8', shingle roof, fair condition --	20.00
<u>Old kitchen:</u> Log, 14x15', paper roof, stone flue, poor condition --	25.00
<u>Chicken house:</u> Frame, 8x18x7', paper roof, good condition --	20.00
<u>Hen house:</u> Frame, 10x14', shingle roof, fair condition --	15.00
<u>Five walnut trees</u> @ \$3.00 --	15.00
<u>Cow barn and shed:</u> Log, 19x20', shingle roof, poor condition --	10.00
<u>Hen house:</u> Frame, 10x13', paper roof, good condition --	15.00
<u>Corn house and sheds:</u> Log and frame, 23x27', shingle roof, fair condition --	30.00
<i>Total Value Improv</i> \$710. **	\$490.00

(continued)

Claim of Hamp Davis
In the Circuit Court of Madison County, Virginia, No. 82, At Law.
The State Commission on Conservation and Development of the State of Virginia, Petitioner, vs. H. W. Anderson et al

200 Acres

more or less, of land in Madison County, Virginia, Defendants.
The undersigned, in answer to the petition of the State Commission on Conservation and Development of the State of Virginia, and in response to the notice of condemnation awarded upon the filing of said petition and published in accordance with the order of the Circuit Court of Madison County, Virginia, asks leave of the Court to file this as his answer to said petition and to said notice.

My name is Hamp Davis

My Post Office Address is Criglersville - Va

I claim a right, title, estate or interest in a tract or parcel of land within the area sought to be condemned, containing about 200 acres, on which there are the following buildings and improvements: Dwelling house - barn and outbuilding orchards &c

This land is located about 2 miles from Criglersville Virginia, in the Robertson Magisterial District of said County.

I claim the following right, title, estate or interest in the tract or parcel of land described above: (In this space claimant should say whether he is sole owner or joint owner, and if joint owner give names of the joint owners. If claimant is not sole or joint owner, he should set out exactly what right, title, estate or interest he has in or to the tract or parcel of land described above).

I am sole owner of said land

The land owners adjacent to the above described tract or parcel of land are as follows:

North Angus Arrington (deed)

South A. F. Graves (deed)

East Dr. H. J. Smith & Dan Washington

West Thos. C. Daniel

I acquired my right, title, estate or interest to this property about the year 1913 in the following manner:

purchased Jas. M. Brown's heirs

I claim that the total value of this tract or parcel of land with the improvements thereon is \$ 10,000.00. I claim that the total value of my right, title, estate or interest, in and to this tract or parcel of land with the improvements thereon is \$ 10,000.00

I am the owner of 17 acres of land adjoining the above described tract or parcel of land but lying outside the Park area, which I claim will be damaged by the proposed condemnation of lands within the Park area, to the extent of \$ none

(In the space below should be set out any additional statements or information as to this claim which claimant desires to make; and if practicable he should also insert here a description of the tract or parcel of land by metes and bounds).

Remarks: _____

(Continue remarks if necessary on the back).

Witness my signature (or my name and mark attached hereto) this 25th day of July, 1930.

Hamp Davis
mark

STATE OF VIRGINIA, COUNTY OF Madison, To-wit:

The undersigned hereby certifies that Hamp Davis the above named claimant personally appeared before him and made oath that the matters and things appearing in his above answer are true to the best of his knowledge and belief, this 25th day of July, 1930.

my commission expires January 14th 1933

Wilmer Caylor, N.P.
Clerk of the Court, or Special Investigator or Notary Public, or Justice of the Peace.

Claim of *Stamps Davis*
in the Circuit Court of *Franklin County, Virginia*
The State Commission on Conservation and Development of the State of Virginia, Petitioner, vs. *Stamps Davis*

more or less of land in *Franklin County, Virginia* Defendants.
The undersigned, in answer to the petition of the State Commission on Conservation and Development of the State of Virginia, and in response to the notice of condemnation awarded upon the filing of said petition and published in accordance with the order of the Circuit Court of *Franklin County, Virginia*, asks leave of the Court to file this as his answer to said petition and to said notice.

My name is *Stamps Davis*
My Post Office Address is *Stamps Davis*

I claim a right title, estate or interest in a tract or parcel of land within the area sought to be condemned, containing about *2.5* acres on which there are the following buildings and improvements: *Shedding house - four corners*

This land is located about *2* miles from *Franklinville*, Virginia, in the *Franklin* Magisterial District of said County.

I claim the following right title, estate or interest in the tract or parcel of land described above: (In this space claimant should say whether he is sole owner or joint owner, and if joint owner give names of the joint owners. If claimant is not sole or joint owner, he should set out exactly what right title, estate or interest he has in or to the tract or parcel of land described above).

The land owners adjacent to the above described tract or parcel of land are as follows:
North: Eugene Cunningham (deceased)
South: [illegible]

I acquired my right title, estate or interest to this property about the year *1924* in the following manner: *from Eugene Cunningham*

I claim that the total value of this tract or parcel of land with the improvements thereon is *\$1000.00*. I claim that the total value of my right title, estate or interest in this tract or parcel of land with the improvements thereon is *\$1000.00*.

I am the owner of *1.5* acres of land adjoining the above described tract or parcel of land but lying outside the Park area, which I claim will be damaged by the proposed condemnation of lands within the Park area, to the extent of *\$1000.00*.

(In the space below should be set out any additional statements or information as to the claim which claimant desires to make; and if practicable he should also insert here a description of the tract or parcel of land by metes and bounds).
Remarks:

(Continue remarks if necessary on the back).

Witness my signature (or my name and mark attached hereto) this *24th* day of *July*, 1930.

STATE OF VIRGINIA, COUNTY OF *Franklin*
The undersigned hereby certifies that *Stamps Davis* the above named claimant personally appeared before him and made oath that the matters and things appearing in his above answer are true to the best of his knowledge and belief.

this *24th* day of *July*, 1930.
Notary Public or Justice of the Peace.
Clerk of the Court or Special Investigator or

Stamps Davis
Filed July 26-1930
State of Virginia