

Claimant #306 - Early, W. M.

Acreage Found: 41 Assessed 630 Deed 627.

Location: East and south slope Kantuck Mountain. Partly in Park Area.

Incumbrances, counter claims or laps: None.

Soil: Sandy loam of moderate depth and fertility. Upper slope rocky.

Roads: Twenty miles to Somerset, nearest railroad - three miles county road to Wolftown, seventeen miles State Highway.

History of tract and condition of timber: Ten acres cut over in 1930.

Mature chestnut oak and white oak on slope. Good timber and grazing land below Park boundary.

25 tons bark @ \$2.00 -- \$50.00.

55 M. ft. chestnut oak

15 M. ft. white oak

10 M. ft. red oak

10 M. ft. hickory

90 M. ft. @ \$4.00 --- ~~\$360~~ \$360.00  
 \$410.00

Improvements: None.

Value of land by types:

Type	Acreage	Value per acre	Total Value
Slope	41	\$3.00	\$123.00

Summary:

Total value of land.	\$123.00
Total value of timber.	\$410.00
Total value of tract.	\$533.00.

*L. W. Farnum, Secy*

County: Madison  
District: Rapidan

#306- Early, W.M.

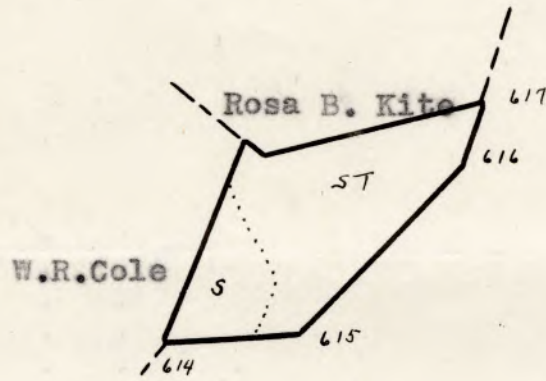

LEGEND:

Slope  
Scale - 1" = 20 chains

County: Madison  
District: Rapidan

#306 - Early, W. M.

Acreage Claimed: Assessed 630 Deed: 627  
(no claim)  
Value Claimed: Assessed: \$10,000. Deed: \$5617.73

Location: East and south slope Kantuck mountain. Partly in  
Park area. Area: 41 A.

Incumbrances, counter claims or laps: None.

Soil: Sandy loam of moderate depth and fertility. Upper  
slope rocky.

Roads: Twenty miles to Somerset, nearest railroad - three  
miles county road to Wolftown, seventeen miles  
state highway.

History of tract and condition of timber: Ten acres cut over in  
1930. Mature chestnut oak and white oak on slope.  
Good timber and grazing land below Park boundary.

25 tons bark @ \$2.00 -- (\$25.00) \$50. xx  
55 M. ft. chestnut oak  
15 M. ft. white oak  
10 M. ft. red oak  
10 M. ft. hickory  
90 M. ft. @ (\$3.00) \$400 -- (270.00) 360. xx  
(\$295.00) \$410. xx

Improvements: None.

Value of land by types:

Type	Acreage	Value per acre	Total Value
Slope	41	\$3.00	\$123.00

Total value of land	\$123.00
Total value of timber & bark	\$295.00
Total value of tract	\$418.00
Average value per acre	\$10.20

Claim of W. M. Early  
In the Circuit Court of Madison County, Virginia, No. \_\_\_\_\_, At Law.  
The State Commission on Conservation and Development of the State of Virginia, Petitioner, vs. \_\_\_\_\_

more or less, of land in Madison County, Virginia, Defendants.  
The undersigned, in answer to the petition of the State Commission on Conservation and Development of the State of Virginia, and in response to the notice of condemnation awarded upon the filing of said petition and published in accordance with the order of the Circuit Court of Madison County, Virginia, asks leave of the Court to file this as his answer to said petition and to said notice.

My name is W. M. Early  
My Post Office Address is Wolftown, Va.

I claim a right, title, estate or interest in a tract or parcel of land within the area sought to be condemned, containing about 35 acres, on which there are the following buildings and improvements: none

This land is located about 2 1/2 miles from Wolftown, Virginia, in the Rapidan Magisterial District of said County.

I claim the following right, title, estate or interest in the tract or parcel of land described above: (In this space claimant should say whether he is sole owner or joint owner, and if joint owner give names of the joint owners. If claimant is not sole or joint owner, he should set out exactly what right, title, estate or interest he has in or to the tract or parcel of land described above).

Sole owner

The land owners adjacent to the above described tract or parcel of land are as follows:

- North R. B. Kite
- South W. R. Cole
- East W. M. Early
- West W. R. Cole

I acquired my right, title, estate or interest to this property about the year 1879 in the following manner:

Left to be my father at his death

I claim that the total value of this tract or parcel of land with the improvements thereon is \$ 250.00. I claim that the total value of my right, title, estate or interest, in and to this tract or parcel of land with the improvements thereon is \$ \_\_\_\_\_.

I am the owner of \_\_\_\_\_ acres of land adjoining the above described tract or parcel of land but lying outside the Park area, which I claim will be damaged by the proposed condemnation of lands within the Park area, to the extent of \$ \_\_\_\_\_.

(In the space below should be set out any additional statements or information as to this claim which claimant desires to make; and if practicable he should also insert here a description of the tract or parcel of land by metes and bounds).

Remarks: \_\_\_\_\_

(Continue remarks if necessary on the back).

Witness my signature (or my name and mark attached hereto) this 27th day of April 1931, 1930.

STATE OF VIRGINIA, COUNTY OF Madison, To-wit:

The undersigned hereby certifies that W. M. Early the above named claimant personally appeared before him and made oath that the matters and things appearing in his above answer are true to the best of his knowledge and belief, this 27th day of April 1931 1930.

[Signature] Notary Public.  
Clerk of the Court, or Special Investigator or Notary Public, or Justice of the Peace.

Wm. Early

Filed May 1, 1931

Jessie: *Wm. Early*

STATE OF VIRGINIA, COUNTY OF MADISON  
The undersigned hereby certifies that  
The above named claimant personally appeared before him and made oath that the contents  
and those appearing in his above answer are true to the best of his knowledge and belief.  
April 1931  
Witness my signature (or my name and mark attached hereto) this 27th day of April 1931  
Continued remains if necessary on the back