

County: Madison
 District: Rapidan

#330 - Graves, Rosa J.

Acreage Found: 28 Assessed: 74 Deed: 74.

Location: Rapidan River near Graves Mill. Partly inside and partly outside of the Park Area.

Incumbrances, counter claims or laps:

Soil: Sandy, clay loam of medium depth and fertility.

Roads: Twenty-two miles to Somerset over ten miles of county road and twelve miles of improved road.

History of tract and condition of timber: All the merchantable saw timber was removed from this tract about two or three years ago. Wood and small stuff included in land value.

Improvements: None.

Value of land by types:

<u>Type</u>	<u>Acreage</u>	<u>Value per acre</u>	<u>Total Value</u>
Slope	28	\$10.00	\$280.00

Summary:

Total value of land	\$280.00
Total value of tract	\$280.00.

L. W. Farmer, Jr.

#330 - Graves, Rosa J.

County: Madison
District: Rapidan

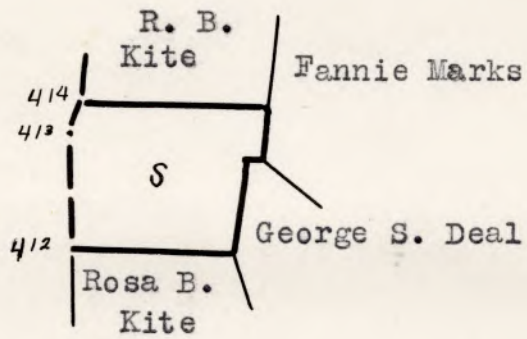
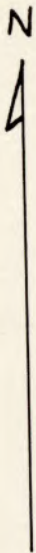

LEGEND

Slope

Scale - 1" = 20 chains

County: Madison
District: Rapidan

#330 - Graves, Rosa J.

Acreage Claimed: Assessed: 74 Deed: 74
Value Claimed: Assessed: \$888.00 Deed: Inher-
Area -- 28 acres. ited.

Location: Rapidan River near Graves Mill. Partly inside and partly outside of the Park area.

Incumbrances, counter claims or laps:

Soil: Sandy, clay loam of medium depth and fertility.

Roads: Twenty-two miles to Somerset over ten miles of county road and twelve miles of improved road.

History of tract and condition of timber: All the merchantable saw timber was removed from this tract about two or three years ago. *Wood & small stuff included in land value*

Improvements: None.

Value of land by types:

<u>Type</u>	<u>Acreage</u>	<u>Value per acre</u>	<u>Total Value</u>
Slope	28	\$3.00	\$84.00

Total value of land \$84.00

Total value of tract \$84.00

Average value per acre \$3.00