

Claimant #310 - Herndon, E. C.

Acreage Found: 44 Assessed 44 Deed 44.

Location: North side of Garth Run. Wholly in Park Area.

Incumbrances, counter claims or laps: None known.

Soil: Sandy loam of moderate depth and fertility.

Roads: Nineteen miles to Somerset, nearest railroad, **six** miles county road to Wolftown, seventeen miles State Highway.

History of tract and condition of timber: Land culled over for poplar and oak by Ward-Rue in 1920. Restocking to poplar, oak and hickory. Land not burned recently. Grazing land has a fair blue grass sod. The estimate and appraisal is:

White oak	40 M. ft. @ \$4.00	---	\$160.00
Chestnut Oak	10 M. ft. @ \$4.00	---	40.00
Miscellaneous	15 M. ft. @ \$4.00	---	60.00
	<u>65 M. ft.</u>		
Bark	10 tons @ \$1.50	---	15.00
			<u>\$275.00.</u>

41 fruit trees \$50.00.

Improvements: Dwelling: Log, 18x27', 3 rooms, shingle roof, stone flues, 1 1/2 story, log finish, poor condition, occupied by tenant, spring water supply, solid foundation, cellar.
Corn house : Log, 12x14x8', shingle roof, poor condition.

Total value of improvements -- \$160.00.

Value of land by types:

<u>Type</u>	<u>Acreage</u>	<u>Value per acre</u>	<u>Total Value</u>
Slope	30	\$4.00	\$120.00
Fg & Fc	14	\$20.00	\$280.00
	<u>44</u>		<u>\$400.00.</u>

Summary:

Total value of land.	\$400.00
Total value of timber	\$275.00
Total value of improvements	\$160.00
Total value of fruit trees.	\$ 50.00
Total value of tract.	<u>\$885.00.</u>

L. W. Farmer, Sec.

County: Madison
District: Rapidan

#310- Herndon, E.C.

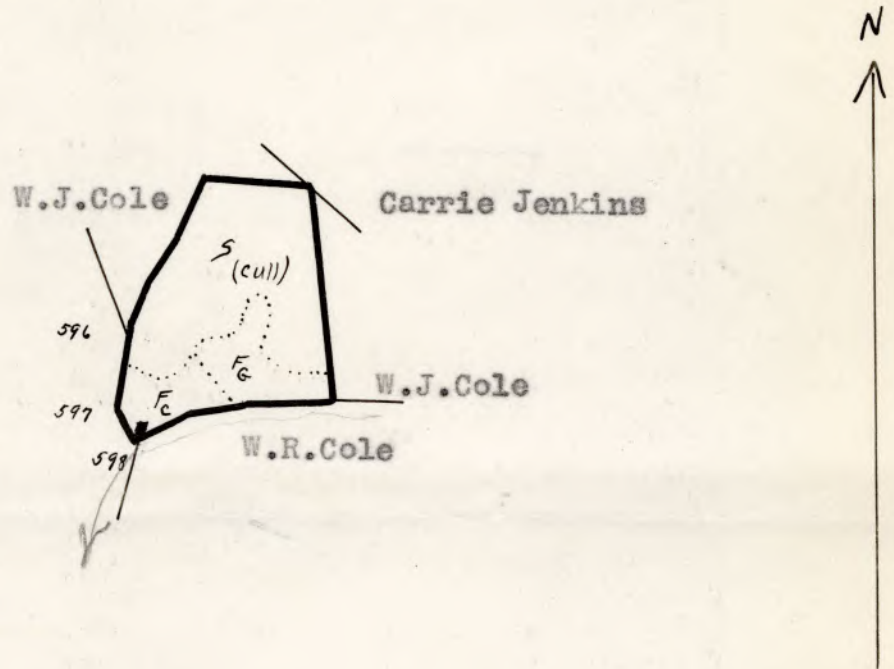

LEGEND:
Slope Grazing
Tillable
Scale - 1" = 20 chains

Revised Report

County: Madison
District: Rapidan

#310 - Herndon, E. C.

Acreage Claimed: 44 Assessed: 44 Deed: 44
Value Claimed: \$2000.00 Assessed: \$344.00 Deed: \$212.50

Area -- 44 acres.

Location: North side of Garth Run. Wholly in Park area.

Incumbrances, counter claims or laps: None known.

Soil: Sandy loam of moderate depth and fertility.

Roads: ^{nineteen}~~Twenty-three~~ miles to Somerset, nearest railroad -
six miles county road to Wolftown, seventeen miles
state highway.

History of tract and condition of timber: Land culled over
for poplar and oak by Ward-Rue in 1920. Restocking
to poplar, oak and hickory. Land not burned recently.
Grazing land has a fair blue grass sod. The estimate
and appraisal is:

White oak	40 M. ft.	@ \$4.00	--	\$160.00
Chestnut oak	10 M. ft.	@ \$4.00	--	40.00
Miscellaneous	15 M. ft.	@ \$4.00	--	60.00
	<u>65 M. ft.</u>			
Bark	10 tons	@ \$1.50	--	15.00
				<u>\$275.00</u>

41 Fruit trees \$50.00

Improvements: Dwelling: Log, 18x27', 3 rooms, shingle roof,
stone flues, 1 1/2 story, log finish, poor condition,
occupied by tenant, spring water supply, solid
foundation, cellar --- { \$125.00
Corn house: Log, 12x14x8', shingle roof,
poor condition --- { 15.00
Adv Value Impr \$160.00 { \$140.00

Value of land by types:

Type	Acreage	Value per acre	Total Value
Slope	30	\$3.00	\$90.00
Grazing	9	20.00	180.00
Tillable	5	20.00	100.00
	<u>44</u>		<u>370.00</u>

Total value of land.....\$370.00
Total value of improvements....\$140.00
Total value of trees..... 41.00
(41 apple trees @ \$1.00)
Total value of timber..... 275.00
Total value of tract.....\$826.00
Average value per acre..... \$8.78

Claim of E.C. Herndon & Flora Herndon
In the Circuit Court of Madison County, Virginia, No. 82, At Law.
The State Commission on Conservation and Development of the State of Virginia, Petitioner, vs. E.C. Herndon and ~~Flora~~ Flora Herndon
for 44 acres of land

more or less, of land in Madison County, Virginia, Defendants.
The undersigned, in answer to the petition of the State Commission on Conservation and Development of the State of Virginia, and in response to the notice of condemnation awarded upon the filing of said petition and published in accordance with the order of the Circuit Court of Madison County, Virginia, asks leave of the Court to file this as his answer to said petition and to said notice.

My name is E.C. Herndon
My Post Office Address is Ruckerville, Va

I claim a right, title, estate or interest in a tract or parcel of land within the area sought to be condemned, containing about 44 acres, on which there are the following buildings and improvements: 1. four room dwelling house with out buildings also 1 orchard and a boundary of very valuable timber.

This land is located about 4 miles from Wolf town Virginia, in the _____ Magisterial District of said County.

I claim the following right, title, estate or interest in the tract or parcel of land described above: (In this space claimant should say whether he is sole owner or joint owner, and if joint owner give names of the joint owners. If claimant is not sole or joint owner, he should set out exactly what right, title, estate or interest he has in or to the tract or parcel of land described above).
sole owners

The land owners adjacent to the above described tract or parcel of land are as follows:
North Joe Cole
South Joe Cole
East Will Cole
West Joe Cole

I acquired my right, title, estate or interest to this property about the year 1930 in the following manner:
for support of Julia and A.B. Cole for the remainder of their lives

I claim that the total value of this tract or parcel of land with the improvements thereon is \$ 2000. I claim that the total value of my right, title, estate or interest, in and to this tract or parcel of land with the improvements thereon is \$ 2000

I am the owner of _____ acres of land adjoining the above described tract or parcel of land but lying outside the Park area, which I claim will be damaged by the proposed condemnation of lands within the Park area, to the extent of \$ _____.
(In the space below should be set out any additional statements or information as to this claim which claimant desires to make; and if practicable he should also insert here a description of the tract or parcel of land by metes and bounds).

Remarks:
E.C. Herndon & wife
Flora D Herndon

(Continue remarks if necessary on the back).

Witness my signature (or my name and mark attached hereto) this _____ day of _____, 1930.

STATE OF VIRGINIA, COUNTY OF Greene, To-wit:

The undersigned hereby certifies that E.C. Herndon & Flora Herndon the above named claimant personally appeared before him and made oath that the matters and things appearing in his above answer are true to the best of his knowledge and belief, this 21st day of July, 1930.

J. S. Durrer, J. P.
Clerk of the Court, or Special Investigator or Notary Public, or Justice of the Peace.

E.C. Herndon
Flora Herndon
1930

Claim of E. C. Henderson
 In the Circuit Court of Madison County, Virginia, No. 22 At Law
 The State Commission on Conservation and Development of the State of Virginia, Petitioner, vs. E. C. Henderson and his heirs
 more or less of land in Madison County, Virginia, Defendants
 The undersigned, in answer to the petition of the State Commission on Conservation and Development of the State of Virginia, and in response to the notice of condemnation awarded upon the filing of said petition and published in accordance with the order of the Circuit Court of Madison County, Virginia, asks leave of the Court to file this as his answer to said petition and to said notice.

My name is E. C. Henderson
 My Post Office Address is Blacksville Va
 I claim a right, title, estate or interest in a tract or parcel of land within the area sought to be condemned, containing about 4 1/2 acres, on which there are the following buildings and improvements: 1 four room building house with out building also porch and a boundary of long valuable timber
 This land is located about 8 miles from Welfair Virginia, in the Madison District of said County.

I claim the following right, title, estate or interest in the tract or parcel of land described above: (In this space claimant should say whether he is sole owner or joint owner, and if joint owner give names of the joint owners. If claimant is not sole or joint owner, he should set out exactly what right, title, estate or interest he has in or to the tract or parcel of land described above.)
sole owner

The land owners adjacent to the above described tract or parcel of land are as follows:

North for the
 South for the
 East Willie Lee
 West for the

I acquired my right, title, estate or interest in this property about the year 1950 in the following manner: for support of public and A. B. Lee for the remainder of their lives

I claim that the total value of this tract or parcel of land with the improvements thereon is \$ 2000. I claim that the total value of my right, title, estate or interest in and to this tract or parcel of land with the improvements thereon is \$ 2000. I am the owner of 4 1/2 acres of land adjoining the above described tract or parcel of land but lying outside the Park area, which I claim will be damaged by the proposed condemnation of lands within the Park area to the extent of \$ 2000. (In the space below should be set out any additional statements or information as to the claim which claimant desires to make; and if practicable he should also insert here a description of the tract or parcel of land by notes and bounds.)

E. C. Henderson
Delaware P. Henderson

(Continue remarks if necessary on the back.)
 Witness my signature (or my name and mark attached hereto) this 21 day of July, 1950.

STATE OF VIRGINIA, COUNTY OF Madison
 The undersigned hereby certifies that E. C. Henderson & his heirs the above named claimant personally appeared before him and made oath that the matters and things appearing in his above answer are true to the best of his knowledge and belief.
 this 21 day of July, 1950.
J. B. Gorman, J. P.
 Clerk of the Court or Special Investigator or Notary Public or Justice of the Peace.

E. C. Henderson
Filed July 23 - 1950