

County: Madison  
District: Rapidan

Claimant #311 - Huffman, T. S.

Acreage Found: 112

Incomplete Deed: 108 A.

Location: Extending across Garth Run. Wholly in Park Area.

Incumbrances, counter claims or laps: None known.

Soil: Sandy loam of good depth and fertility.

Roads: Twenty-three miles to Somerset, nearest railroad,  
seven miles to Wolftown county road, sixteen miles  
state highway.

History of tract and condition of timber: This is largely grazing  
or land restocking acquired through exchange for timber  
land. At N. end the slope was cut over in 1920 by  
Ward-Rue. No merchantable timber. Some fine young  
poplar covering is on this slope. Fire in spring  
1931 burned area indicated on map.

Improvements: Barn: Log, 21x21', shingle roof, poor condition -- \$30.00  
All fruit trees -- \$50.00.

Value of land by types:

Type	Acreage	Value per acre	Total Value
Slope fenced	21	\$5.00	\$105.00
Fr	44	\$10.00	\$440.00
Fc	47	\$25.00	\$1175.00
	112		\$1720.00

Summary:

Total value of land.	\$1720.00
Total value of improvements	\$ 30.00
Total value of fruit trees	\$ 50.00
Total value of tract.	\$1800.00

*L. H. Tanner, Sec.*



County: Madison  
District: Rapidan

MADISON TIMBER CORPORATION

Timber Rights on

#311- HUFFMAN, T. S.

Area: 45 Acres.

Location: Garth Run Area.

Expiration date: April 22, 1936, with option to extend time  
limit 5 years.

History of tract and condition of timber: This tract was cut  
absolutely clean by the West Va. Timber Company  
about 1920. No merchantable timber remains.

Summary:

Timber Rights -No value.

*L. In. Farmer Sec.*



County: Madison  
District: Rapidan

Claimant #311-a - Huffman, T. S.

Acreage Found: 3                      Assessed With other  
lands.

Location: German Ridge U. S. Positions #369 and #370.

Incumbrances, counter claims or laps: None so far as known.

Soil: Sandy loam. Slope type of a good depth and fertility.

Roads: Three-fourth miles via dirt road and fourteen miles  
via graveled road to Somerset, the nearest shipping  
point.

History of tract and condition of timber: This tract has about  
5 M. bd. ft. of red and black oak with a small amount  
of white and chestnut oak.

5 M. ft. @ \$4.00 per M. --- \$20.00.

Improvements: None.

Value of land by types:

<u>Type</u>	<u>Acreage</u>	<u>Value per acre</u>	<u>Total Value</u>
Slope	3	\$10.00	\$30.00

Summary:

Total value of land -- , \$30.00

Total value of timber      \$20.00

Total value of tract.      \$50.00.

*L. H. Farmer, Sec.*



County: Madison  
District: Rapidan

MADISON TIMBER CORPORATION

Timber Rights on

#311-a - HUFFMAN, T. S.

Area: 3 acres.

Location: On the South end of German Ridge.

History of tract and condition of timber: The Madison Timber Corporation have no rights, nor do they claim any rights on this area. Apparently the exhibit of the Petitioner was an error in this case. The timber thereon is valued in the report of the owner of the fee.

*L. W. Tammes & Co.*



County: Madison  
District: Rapidan

#311- Huffman, T.S.

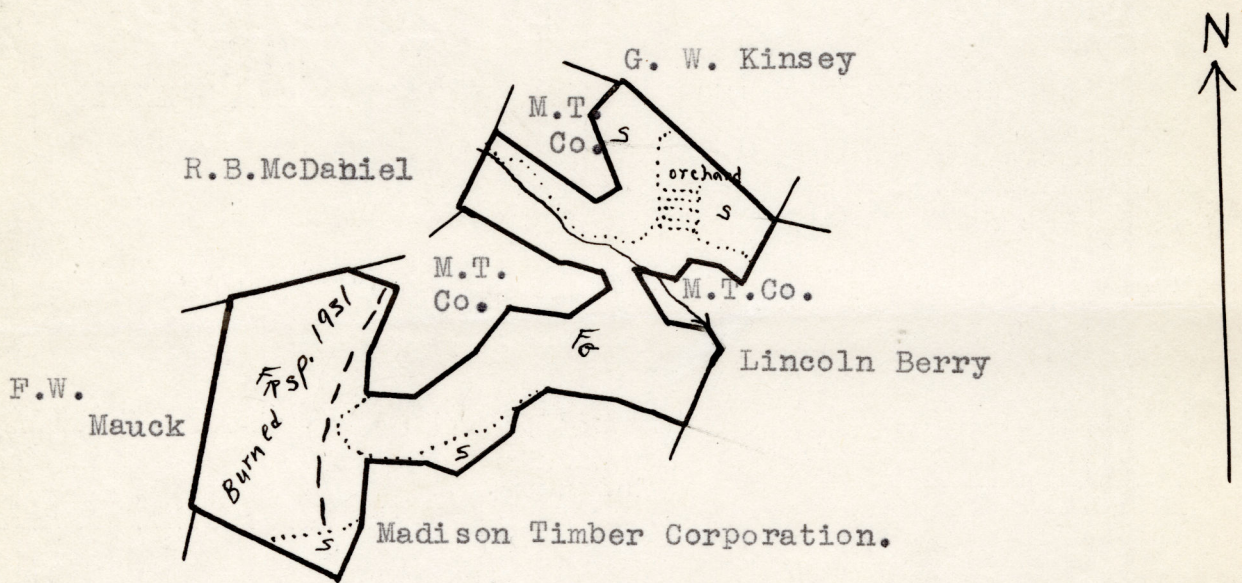

LEGEND:  
Slope      Grazing  
Restocking  
Scale - 1" = 20 chains



County: Madison  
District: Rapidan

#311a- Huffman, T.S.

D.S. Wilhoite L.P. Taylor

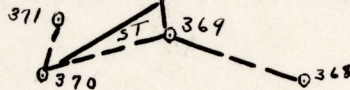

LEGEND:

Slope

Scale - 1" = 20 chains



County: Madison  
District: Rapidan

33  
30  
40  
108

#311 - Huffman, T. S.

Acreage Claimed: 125      Assessed      Incomplete Deed 108A

Value Claimed: \$2500.00      "      "      Area: 112 A.

Location:      Extending across Garth Run.      Wholly in Park area.

Incumbrances, counter claims or laps:      None known.

Soil:      Sandy loam of good depth and fertility.

Roads:      Twenty-three miles to Somerset, nearest railroad, seven miles to Wolfstown county road, sixteen miles state highway.

History of tract and condition of timber:      This is largely grazing or land restocking acquired through exchange for timber land. At N. end the slope was cut over in 1920 by Ward-Rue. No merchantable timber. Some fine young poplar covering is on this slope. Fire in spring 1931 burned area indicated on map.

Improvements:      Barn: Log, 21x21', shingle roof, poor condition - \$30.00.

*All young trees \$50.00*

Value of land by types:

Type	Acreage	Value per acre	Total Value
Slope	21	\$3.00	\$63.00
Restocking	44	10.00	440.00
Grazing	47	20.00	940.00
	112		\$1443.00

Total value of land      \$1443.00  
Total value of improvements      35.00  
Total value of orchard  
1 acre @ \$40.00 -      40.00  
Total value of tract      \$1518.00  
Average value per acre      \$13.55



County: Madison  
District: Rapidan

#311-a - Huffman, T. S.

Acreage Claimed: Assessed With other Deed  
lands.  
Value Claimed: " " Area: 3 A.  
Location: German Ridge U. S. Positions #369 and #370.  
Incumbrances, counter claims or laps: None so far as known.  
Soil: Sandy loam. Slope type of a good depth and fertility.  
Roads: Three-fourth miles Via dirt road and fourteen miles via  
graveled road to Somerset, the nearest shipping point.  
History of tract and condition of timber: This tract has about 5  
M. bd. ft. of red and black oak with a small amount of  
white and chestnut oak.  
5 M. ft. @ ~~\$3.00~~ <sup>\$4\*\*</sup> per M. -- (\$15.00.) - \$20.\*\*  
Improvements: None.

Value of land by types:

<u>Type</u>	<u>Acreage</u>	<u>Value per acre</u>	<u>Total Value</u>
Slope	3	\$3.00	\$9.00

Total value of land	\$9.00
Total value of timber	<u>15.00</u>
Total value of tract	\$24.00
Average value per acre	\$8.00



Claim of J. S. Haffman  
In the Circuit Court of Madison County, Virginia, No. 82, At Law.  
The State Commission on Conservation and Development of the State of Virginia, Petitioner, vs. W. D. Anderson et als

more or less, of land in Madison County, Virginia, Defendants.  
The undersigned, in answer to the petition of the State Commission on Conservation and Development of the State of Virginia, and in response to the notice of condemnation awarded upon the filing of said petition and published in accordance with the order of the Circuit Court of Madison County, Virginia, asks leave of the Court to file this as his answer to said petition and to said notice.

My name is J. S. Haffman  
My Post Office Address is Waftown Va

I claim a right, title, estate or interest in a tract or parcel of land within the area sought to be condemned, containing about 1.25 acres, on which there are the following buildings and improvements: none

This land is located about 4 miles from Waftown Virginia, in the Rapids Magisterial District of said County.

I claim the following right, title, estate or interest in the tract or parcel of land described above: (In this space claimant should say whether he is sole owner or joint owner, and if joint owner give names of the joint owners. If claimant is not sole or joint owner, he should set out exactly what right, title, estate or interest he has in or to the tract or parcel of land described above).  
Sole owner

The land owners adjacent to the above described tract or parcel of land are as follows:

North G. W. Kinsey  
South Madison High Separation  
East Pigeon Berry  
West R. B. McDavid

I acquired my right, title, estate or interest to this property about the year 1920 in the following manner:

by deed from David Jamerson Trust

I claim that the total value of this tract or parcel of land with the improvements thereon is \$ 2500.00. I claim that the total value of my right, title, estate or interest, in and to this tract or parcel of land with the improvements thereon is \$ 2500.00.

I am the owner of no acres of land adjoining the above described tract or parcel of land but lying outside the Park area, which I claim will be damaged by the proposed condemnation of lands within the Park area, to the extent of \$ 0.00.

(In the space below should be set out any additional statements or information as to this claim which claimant desires to make; and if practicable he should also insert here a description of the tract or parcel of land by metes and bounds).

Remarks: \_\_\_\_\_

(Continue remarks if necessary on the back).

Witness my signature (or my name and mark attached hereto) this 7 day of July, 1930.

STATE OF VIRGINIA, COUNTY OF Madison, To-wit:

The undersigned hereby certifies that J. S. Haffman the above named claimant personally appeared before him and made oath that the matters and things appearing in his above answer are true to the best of his knowledge and belief, this 7 day of July, 1930.

A. H. Carr  
Clerk of the Court, or Special Investigator or Notary Public, or Justice of the Peace.



Claim of \_\_\_\_\_  
in the Circuit Court of \_\_\_\_\_  
County, Virginia, No. \_\_\_\_\_  
The State Commission on Conservation and Development of the State of Virginia, Petitioner, vs. \_\_\_\_\_

more or less of land in \_\_\_\_\_  
County, Virginia, Defendants.  
The undersigned, in answer to the petition of the State Commission on Conservation and Development of the State of Virginia, and in response to the notice of condemnation awarded upon the filing of said petition and published in accordance with the order of the Circuit Court of \_\_\_\_\_  
County, Virginia, asks leave of the Court to file this as his answer to said petition and to said notice.

My name is \_\_\_\_\_  
My Post Office Address is \_\_\_\_\_

I claim a right title estate or interest in a tract or parcel of land with the area sought to be condemned, containing about \_\_\_\_\_  
acres, on which there are the following buildings and improvements: \_\_\_\_\_

This land is located about \_\_\_\_\_  
miles from \_\_\_\_\_  
the \_\_\_\_\_  
Magisterial District of said County.

I claim the following right title estate or interest in the tract or parcel of land described above: (In this space claimant should state whether he is sole owner or joint owner and if joint owner give names of the joint owners. If claimant is not the owner of the tract he should set out exactly what right title estate or interest he has in the tract (parcel of land described above).)

The land owner adjacent to the above described tract or parcel of land is \_\_\_\_\_  
North \_\_\_\_\_  
South \_\_\_\_\_  
East \_\_\_\_\_  
West \_\_\_\_\_

I acquired my right title estate or interest to this property about the year \_\_\_\_\_  
in the following manner: \_\_\_\_\_

I claim that the total value of this tract or parcel of land with the improvements thereon is \$22,000. I claim that the total value of my right title estate or interest in and to this tract or parcel of land with the improvements thereon is \$22,000. I am the owner of \_\_\_\_\_  
acres of land adjoining the above described tract or parcel of land but lying outside the Park area, which I claim will be damaged by the proposed condemnation of lands within the Park area, to the extent of \$ \_\_\_\_\_  
(In the space below should be set out any additional statements or information as to this claim which claimant desires to make; and if practicable he should also insert here a description of the tract or parcel of land by metes and bounds).

Remarks: \_\_\_\_\_

(Continue remarks if necessary on the back).

Witness my signature (or my name and mark attached hereto) this \_\_\_\_\_  
day of \_\_\_\_\_  
1930.

STATE OF VIRGINIA, COUNTY OF \_\_\_\_\_  
To-wit: \_\_\_\_\_

The undersigned hereby certifies that \_\_\_\_\_  
the above named claimant personally appeared before him and made oath that the matters and things appearing in his above answer are true to the best of his knowledge and belief.  
this \_\_\_\_\_  
day of \_\_\_\_\_  
1930.

Clerk of the Court or Special Investigator or  
Notary Public or Justice of the Peace.

*J. D. Hoffmann*  
*Filed July 7, 1930*  
*Sub: Park area*



#311-a

Claim of J. S. Haffman  
In the Circuit Court of Madison County, Virginia, No. 82, At Law.  
The State Commission on Conservation and Development of the State of Virginia, Petitioner, vs. W. D. Anderson et al

more or less, of land in Madison County, Virginia, Defendants.  
The undersigned, in answer to the petition of the State Commission on Conservation and Development of the State of Virginia, and in response to the notice of condemnation awarded upon the filing of said petition and published in accordance with the order of the Circuit Court of Madison County, Virginia, asks leave of the Court to file this as his answer to said petition and to said notice.

My name is J. S. Haffman

My Post Office Address is Wofflaw VA

I claim a right, title, estate or interest in a tract or parcel of land within the area sought to be condemned, containing about 25 acres, on which there are the following buildings and improvements: none

This land is located about one miles from Wofflaw Virginia, in the Rapids Magisterial District of said County.

I claim the following right, title, estate or interest in the tract or parcel of land described above: (In this space claimant should say whether he is sole owner or joint owner, and if joint owner give names of the joint owners. If claimant is not sole or joint owner, he should set out exactly what right, title, estate or interest he has in or to the tract or parcel of land described above).

Sole owner

The land owners adjacent to the above described tract or parcel of land are as follows:

North Lizzie Taylor

South Remainder of my tract

East D. S. Wilhite

West deed

I acquired my right, title, estate or interest to this property about the year 1918 in the following manner:

by and from E. Lang

I claim that the total value of this tract or parcel of land with the improvements thereon is \$ 750.00. I claim that the total value of my right, title, estate or interest, in and to this tract or parcel of land with the improvements thereon is \$ 750.00.

I am the owner of 117 acres of land adjoining the above described tract or parcel of land but lying outside the Park area, which I claim will be damaged by the proposed condemnation of lands within the Park area, to the extent of \$ 000.

(In the space below should be set out any additional statements or information as to this claim which claimant desires to make; and if practicable he should also insert here a description of the tract or parcel of land by metes and bounds).

Remarks: \_\_\_\_\_

(Continue remarks if necessary on the back).

Witness my signature (or my name and mark attached hereto) this 7 day of July, 1930.

STATE OF VIRGINIA, COUNTY OF Madison, To-wit:

The undersigned hereby certifies that J. S. Haffman the above named claimant personally appeared before him and made oath that the matters and things appearing in his above answer are true to the best of his knowledge and belief, this 7 day of July, 1930

W. D. Anderson  
Clerk of the Court, or Special Investigator or Notary Public, or Justice of the Peace.



Claim of \_\_\_\_\_  
In the Circuit Court of \_\_\_\_\_ County, Virginia, No. \_\_\_\_\_  
The State Commission on Conservation and Development of the State of Virginia, Petitioner, vs. \_\_\_\_\_

more or less of land in \_\_\_\_\_ County, Virginia, Defendants.  
The undersigned, in answer to the petition of the State Commission on Conservation and Development of the State of Virginia, and in response to the notice of condemnation awarded upon the filing of said petition and published in accordance with the order of the Circuit Court of \_\_\_\_\_ County, Virginia, asks leave of the Court to file this as his answer to said petition and to said notice.

My name is \_\_\_\_\_  
My Post Office Address is \_\_\_\_\_

I claim a right, title, estate or interest in a tract or parcel of land within the area sought to be condemned, containing about \_\_\_\_\_ acres, on which there are the following buildings and improvements: \_\_\_\_\_

This land is located about \_\_\_\_\_ miles from \_\_\_\_\_ the \_\_\_\_\_ Magisterial District of said County.

I claim the following right, title, estate or interest in the tract or parcel of land described above: (In this space claimant should say whether he is sole owner or joint owner, and if joint owner give names of the joint owners. If claimant is not the sole owner, he should set out exactly what right, title, estate or interest he has in the tract or parcel of land described above.)

The land owner adjacent to the above described tract or parcel of land are as follows:  
North \_\_\_\_\_  
South \_\_\_\_\_  
East \_\_\_\_\_  
West \_\_\_\_\_

I acquired my right, title, estate or interest in this property about the year 1918 in the following manner: \_\_\_\_\_

I claim that the total value of this tract or parcel of land with the improvements thereon is \$ 750.00. I claim that the total value of my right, title, estate or interest in and to this tract or parcel of land with the improvements thereon is \$ 750.00. I am the owner of \_\_\_\_\_ acres of land adjoining the above described tract or parcel of land but lying outside the Park area, which I claim will be damaged by the proposed condemnation of lands within the Park area to the extent of \$ 200.00. (In the space below should be set out any additional statements or information as to this claim which claimant desires to make; and if practicable he should also insert here a description of the tract or parcel of land by metes and bounds.)

Remarks: \_\_\_\_\_

(Continue remarks if necessary on the back).

Witness my signature (or my name and mark attached hereto) this \_\_\_\_\_ day of \_\_\_\_\_, 1930.

STATE OF VIRGINIA, COUNTY OF \_\_\_\_\_  
To-wit: \_\_\_\_\_

The undersigned hereby certifies that \_\_\_\_\_ the above named claimant personally appeared before him and made oath that the matters and things appearing in his above answer are true to the best of his knowledge and belief.  
this \_\_\_\_\_ day of \_\_\_\_\_, 1930.

Clerk of the Court or Special Investigator or Notary Public or Justice of the Peace.

*C. D. Hoffmann*  
*Filed July 7-1930*  
*Recd. C. D. Hoffmann*