

County: Madison
District: Rapidan

Claimant #305 - Kite, Rose B.

Acreage Found: 395 Assessed 372 Deed: 372.

Location: East and west slopes Kantuck Ridge, partly in Park Area.

Incumbrances, counter claims or laps: None known.

Soil: Sandy loam of moderate depth and fertility. West slope steep and rocky.

Roads: Twenty-one miles to Somerset, nearest railroad; three miles county road to Wolftown, and eighteen over State road.

History of tract and condition of timber: A part of this tract has been cut over by the Madison Timber Corporation. The part cut over by the company is the most inaccessible part of the tract. The remaining portion of the tract has been lightly culled for the poplar and best oak. The remaining stand consists of the following:

400 M. timber @ \$3.00.	\$1200.00
350 T. bark @ \$1.00.	\$ 350.00
	<hr/>
	\$1550.00.

Improvements: None.

Value of land by types:

Type	Acreage	Value per acre	Total Value
Slope	360	\$6.00	\$2160.00
Fg	35	\$20.00	\$ 700.00
	<hr/>		<hr/>
	395		\$2860.00.

Summary:

Total value of land.	\$2860.00
Total value of timber.	\$1550.00
Total value of tract.	<hr/>
	\$4410.00.

L. H. Tamm, Sec.

County: Madison
District: Rapidan

WARD-RUE LUMBER COMPANY

Timber Rights on

#305-b - KITE, ROSA B.

Area -- 17 acres.

Location: Rapidan River. Partly inside and partly outside
of the Park Area.

Expiration date: The contract of purchase on this area,
dated July 15, 1929 recites-

"The party of the second part agrees to
release all cutting rights to said timber,
as soon as their mills are moved off said
property of the party of the first part."

History of tract and condition of timber: This area was
completely cut over in 1929-30. No merchant-
able timber remains.

Summary:

Timber rights - No value.

L. W. Farmer & Co.

Claimant #305-a - Kite, Rosa B.

Acreage Found: 20 Assessed: 66 Deed: 66

Location: Rapidan River near Graves Mill. Partly inside and partly outside of the Park Area.

Incumbrances, counter claims or laps:

Soil: Sandy, clay loam of good depth and fertility.

Roads: Twenty-two miles to Somerset over ten miles of county road and twelve miles over paved road.

History of tract and condition of timber: All the merchantable saw timber was removed from this tract about two years ago. Wood and small stuff included in land value.

Improvements: None.

Value of land by types:

<u>Type</u>	<u>Acreage</u>	<u>Value per acre</u>	<u>Total Value</u>
Slope	20	\$10.00	\$200.00

Summary:

Total value of land \$200.00
Total value of tract \$200.00.

L. W. Farmer, Sec

County: Madison
District: Rapidan

WARD-RUE LUMBER COMPANY

Timber Rights on

#305-a - KITE, ROSA B.

Area -- 20 acres.

Location: Rapidan River near Graves Mill. Partly inside
and partly outside of the Park Area.

Expiration date: The contract of purchase on this area,
dated July 15, 1929 recites-

"The party of the second part agrees to
release ~~all~~ cutting rights to said timber,
as soon as their mills are moved off said
property of the party of the first part."

History of tract and condition of timber: This area was
completely cut over in 1929-30. No merchant-
able timber remains.

Summary:

Timber rights - No value.

L. W. Farmer Sec.

County: Madison
District: Rapidan

Claimant #305-b - Kite, Rosa B.

Acreage Found: 17 Assessed 70

Location: Rapidan River. Partly inside and partly outside of
the Park Area.

Incumbrances, counter claims or laps: -

Soil: Sandy, clay loam of fair depth and fertility.

Roads: Twenty miles to Somerset, Va., over four miles of
county road and sixteen miles of improved road.

History of tract and condition of timber: All the merchantable
timber was removed from this tract about two years
ago. Wood and small stuff valued with land.

Improvements: None.

Value of land by types:

<u>Type</u>	<u>Acreage</u>	<u>Value per acre</u>	<u>Total Value</u>
Slope	<u>17</u>	<u>\$10.00</u>	<u>\$170.00</u>

Summary:

Total value of land.	\$170.00
Total value of tract.	\$170.00

L. W. Tanner Sec.

#305- Kite, Rosa B.

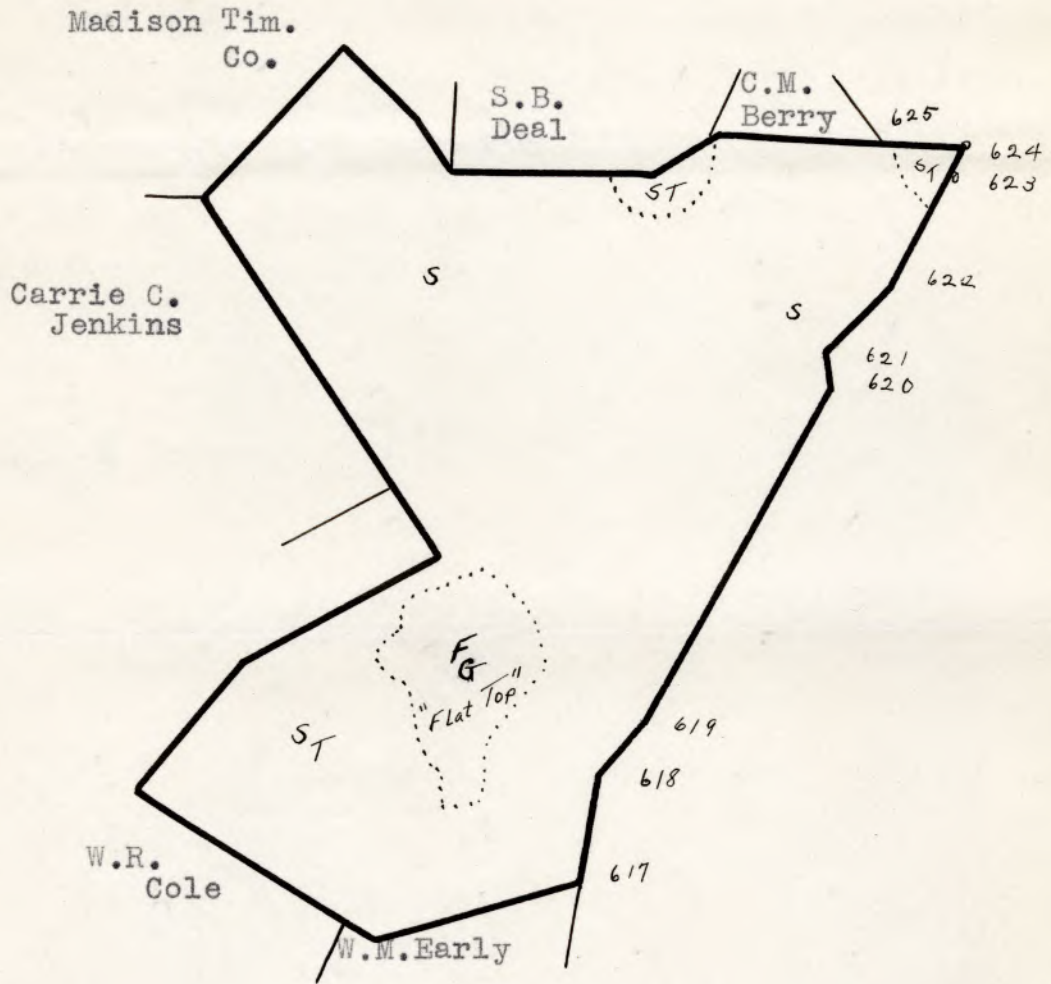

LEGEND:
Slope Grazing
Scale - 1" = 20 chains

305-a

R.B. Kite

County: Madison
District: Rapidan

#305-a - Kite, Rosa B.,

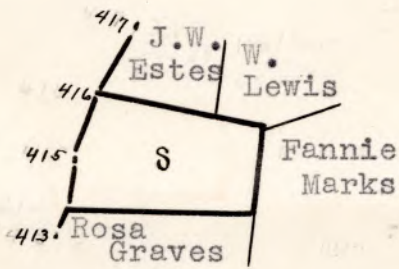

LEGEND:

Slope

Scale - 1" = 20 chains

#305b - Kite, Rosa B.

County: Madison
District: Rapidan

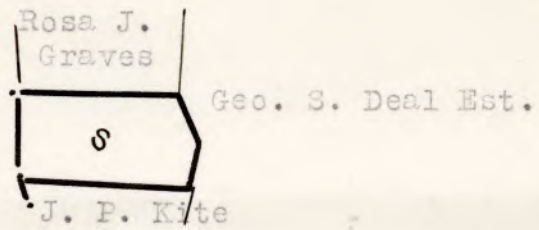

LEGEND

Slope

Scale - 1" = 20 chains

County: Madison
District: Rapidan

#305 - Kite, Rose B.

<u>Acreage Claimed:</u>	412 A.	<u>Assessed:</u>	372	<u>Deed:</u>	372
<u>Value Claimed:</u>	\$9496.00	<u>Assessed:</u>	\$6475.00	<u>Deed:</u>	Inherited. (1914)
		<u>Area:</u>	395 Acres.		

Location: East and west slopes Kentuck Ridge, partly in park area.

Incumbrances, counter claims or laps: None known.

Soil: Sandy loam of moderate depth and fertility. West slope steep and rocky.

Roads: Twenty-one miles to Somerset, nearest railroad; three miles county road to Wolftown, and eighteen over State road.

History of tract and condition of timber: A part of this tract has been cut over by the Madison Timber Corporation. The part cut over by the company is the most inaccessible part of the tract. The remaining portion of the tract has been lightly culled for the poplar and best oak. The remaining stand consists of the following:

320 M. chestnut oak @ \$2.00	--	\$640.00
60 M. poplar @ \$4.00	--	240.00
20 M. hickory and others @ \$1.50	-	30.00
<u>400</u>		<u>\$910.00</u>
700 T. bark @ 75¢	--	525.00
400 M Timber @ \$3.00	\$1200	
350 T. Bark	100	
		<u>\$1435.00</u>
		\$1550.00**

Improvements: None.

Value of land by types:

<u>Type</u>	<u>Acreage</u>	<u>Value per acre</u>	<u>Total Value</u>
Slope	369	\$3.00	\$1107.00
Grazing	26	15.00	390.00
	<u>395</u>		<u>\$1497.00</u>

Total value of land	\$1497.00
Total value of timber	<u>1435.00</u>
Total value of tract	<u>\$2932.00</u>
Average value per acre	\$7.42

#305-a - Kite, Rosa B.

County: Madison
District: Rapidan

<u>Acreage Claimed:</u> 28	Assessed: 66	Deed: 66
<u>Value Claimed:</u> \$280.00	Assessed: \$858.00	Deed: -

Area -- 20 acres.

Location: Rapidan River near Graves Mill. Partly inside and partly outside of the Park area.

Incumbrances, counter claims or laps:

Soil: Sandy, clay loam of good depth and fertility.

Roads: Twenty-two miles to Somerset over ten miles of county road and twelve miles over paved road.

History of tract and condition of timber: All the merchantable saw timber was removed from this tract about two years ago. *Wood & small stuff included in land value*

Improvements: None.

Value of land by types:

<u>Type</u>	<u>Acreage</u>	<u>Value per acre</u>	<u>Total Value</u>
Slope	20	\$3.00	\$60.00

Total value of land \$60.00

Total value of tract \$60.00

Average value per acre \$3.00

County: Madison
District: Rapidan

#305-b - Kite, Rosa B.

<u>Acreage Claimed:</u>	28	Assessed	70	Deed
<u>Value Claimed:</u>	\$280.00	"	\$840.00	"
				Area: 17 A.

Location: Rapidan River. Partly inside and partly outside of the Park area.

Incumbrances, counter claims or laps: -

Soil: Sandy, clay loam of fair depth and fertility.

Roads: Twenty miles to Somerset, Va., over four miles of county road and sixteen miles of improved road.

History of tract and condition of timber: All the merchantable timber was removed from this tract about two years ago. *Wood and small stuff valued with land*

Improvements: None.

Value of land by types:

<u>Type</u>	<u>Acreage</u>	<u>Value per acre</u>	<u>Total Value</u>
Slope	17	\$2.50	\$42.50

Total value of land \$42.50

Total value of tract \$42.50

Average value per acre \$2.50

Claim of R. B. Kite
In the Circuit Court of Madison County, Virginia, No. 82, At Law.
The State Commission on Conservation and Development of the State of Virginia, Petitioner, vs. W. D. Anderson et al
41 1/2 acres of land

more or less, of land in Madison County, Virginia, Defendants.
The undersigned, in answer to the petition of the State Commission on Conservation and Development of the State of Virginia, and in response to the notice of condemnation awarded upon the filing of said petition and published in accordance with the order of the Circuit Court of Madison County, Virginia, asks leave of the Court to file this as his answer to said petition and to said notice.

My name is Mr. R. B. Kite
My Post Office Address is Wofftown

I claim a right, title, estate or interest in a tract or parcel of land within the area sought to be condemned, containing about 41 1/2 acres, on which there are the following buildings and improvements: none

This land is located about 2 miles from Stone Mill Virginia, in the Rapahan Magisterial District of said County.

I claim the following right, title, estate or interest in the tract or parcel of land described above: (In this space claimant should say whether he is sole owner or joint owner, and if joint owner give names of the joint owners. If claimant is not sole or joint owner, he should set out exactly what right, title, estate or interest he has in or to the tract or parcel of land described above).
Owner

The land owners adjacent to the above described tract or parcel of land are as follows:
North C. M. Berry
South W. M. Cook
East Remainder of Sawyer
West Carrie Jenkins

I acquired my right, title, estate or interest to this property about the year 1908 in the following manner:
Sawyer in name of J. P. Kite

I claim that the total value of this tract or parcel of land with the improvements thereon is \$ 9496.00 I claim that the total value of my right, title, estate or interest, in and to this tract or parcel of land with the improvements thereon is \$ 9496.00

I am the owner of _____ acres of land adjoining the above described tract or parcel of land but lying outside the Park area, which I claim will be damaged by the proposed condemnation of lands within the Park area, to the extent of \$ _____
(In the space below should be set out any additional statements or information as to this claim which claimant desires to make; and if practicable he should also insert here a description of the tract or parcel of land by metes and bounds).

Remarks: _____

(Continue remarks if necessary on the back).

Witness my signature (or my name and mark attached hereto) this 24 day of July, 1930.

STATE OF VIRGINIA, COUNTY OF Madison, To-wit:
The undersigned hereby certifies that R. B. Kite
the above named claimant personally appeared before him and made oath that the matters and things appearing in his above answer are true to the best of his knowledge and belief, this 24 day of July, 1930.

W. A. Rose
Clerk of the Court, or Special Investigator or Notary Public, or Justice of the Peace.

Handwritten notes in left margin:
W. D. Anderson
41 1/2 acres
Madison Co. Va.
July 24 1930

Claim of _____
In the Circuit Court of _____ County, Virginia, No. _____
The State Commission on Conservation and Development of the State of Virginia, Petitioner, vs. _____

more or less of land in _____ County, Virginia, Defendants.
The undersigned, in answer to the petition of the State Commission on Conservation and Development of the State of Virginia, and in response to the notice of condemnation awarded upon the filing of said petition and published in accordance with the order of the Circuit Court of _____ County, Virginia, asks leave of the Court to file this as his answer to said petition and to said notice.

My name is _____
My Post Office Address is _____

I claim a right, title, estate or interest in a tract or parcel of land within the area sought to be condemned, containing about _____ acres, on which there are the following buildings and improvements: _____

The land is located about _____ miles from _____ Virginia, in _____ Magisterial District of said County.

I claim the following right, title, estate or interest in the tract or parcel of land described above: (In this space claimant should say whether he is sole owner or joint owner, and if joint owner give names of the joint owners. If claimant is not sole or joint owner, he should set out exactly what right, title, estate or interest he has in or to the tract or parcel of land described above.)

The land owners adjacent to the above described tract or parcel of land are as follows:
North _____
South _____
East _____
West _____

I acquired my right, title, estate or interest to this property about the year 1908 in the following manner:

I claim that the total value of this tract or parcel of land with the improvements thereon is \$ _____
I claim that the total value of my right, title, estate or interest in and to this tract or parcel of land with the improvements thereon is \$ _____

I am the owner of _____ acres of land adjoining the above described tract or parcel of land but lying outside the Park area, which I claim will be damaged by the proposed condemnation of lands within the Park area, to the extent of \$ _____

(In the space below should be set out any additional statements or information as to this claim which claimant desires to make; and if practicable he should also insert here a description of the tract or parcel of land by metes and bounds.)
Remarks: _____

(Continue remarks if necessary on the back.)
Witness my signature (or my name and mark attached hereto) this _____ day of _____ 1930.

STATE OF VIRGINIA, COUNTY OF _____
The undersigned hereby certifies that _____
the above named claimant personally appeared before him and made oath that the matters and things appearing in his above answer are true to the best of his knowledge and belief.

this _____ day of _____ 1930.
Notary Public, or Justice of the Peace

Clerk of the Court, or Special Investigator or Notary Public, or Justice of the Peace

Filed July 24, 1930
J. P. Rice
J. P. Rice

Claim of R. B. Kille
In the Circuit Court of Madison County, Virginia, No. 82, At Law.
The State Commission on Conservation and Development of the State of Virginia, Petitioner, vs. W. A. Audyson et al
28 acres of land

more or less, of land in Madison County, Virginia, Defendants.
The undersigned, in answer to the petition of the State Commission on Conservation and Development of the State of Virginia, and in response to the notice of condemnation awarded upon the filing of said petition and published in accordance with the order of the Circuit Court of Madison County, Virginia, asks leave of the Court to file this as his answer to said petition and to said notice.

My name is Mr. R. B. Kille
My Post Office Address is Waxflour

I claim a right, title, estate or interest in a tract or parcel of land within the area sought to be condemned, containing about 28 acres, on which there are the following buildings and improvements:

none
This land is located about 2 miles from How Mill Virginia, in the Rapidan Magisterial District of said County.

I claim the following right, title, estate or interest in the tract or parcel of land described above: (In this space claimant should say whether he is sole owner or joint owner, and if joint owner give names of the joint owners. If claimant is not sole or joint owner, he should set out exactly what right, title, estate or interest he has in or to the tract or parcel of land described above).

sole owner

The land owners adjacent to the above described tract or parcel of land are as follows:
North J. W. Estes
South Mrs. L. P. Brown
East J. Walter Lewis
West C. M. Berry

I acquired my right, title, estate or interest to this property about the year 1930 in the following manner:
by deed from Elizabeth Moore

I claim that the total value of this tract or parcel of land with the improvements thereon is \$ 280.00. I claim that the total value of my right, title, estate or interest, in and to this tract or parcel of land with the improvements thereon is \$ 280.00.

I am the owner of _____ acres of land adjoining the above described tract or parcel of land but lying outside the Park area, which I claim will be damaged by the proposed condemnation of lands within the Park area, to the extent of \$_____.

(In the space below should be set out any additional statements or information as to this claim which claimant desires to make; and if practicable he should also insert here a description of the tract or parcel of land by metes and bounds).

Remarks: _____

(Continue remarks if necessary on the back).

Witness my signature (or my name and mark attached hereto) this 24 day of July, 1930.

STATE OF VIRGINIA, COUNTY OF Madison, To-wit:

The undersigned hereby certifies that R. B. Kille the above named claimant personally appeared before him and made oath that the matters and things appearing in his above answer are true to the best of his knowledge and belief, this 24 day of July, 1930.

At Home
Clerk of the Court, or Special Investigator or Notary Public, or Justice of the Peace.

Handwritten notes on the left margin:
Mr. R. B. Kille
July 24 1930

Claim of _____
In the Circuit Court of _____
The State Commission on Conservation and Development of the State of Virginia, Petitioner, vs. _____

more or less of land in _____
The undersigned, in answer to the petition of the State Commission on Conservation and Development of the State of Virginia, and in response to the notice of condemnation awarded upon the filing of said petition and published in accordance with the order of the Circuit Court of _____, Virginia, asks leave of the Court to file this as his answer to said petition and to said notice.

My name is _____
My Post Office Address is _____

I claim a right, title, estate or interest in a tract or parcel of land within the area sought condemned, containing about _____ acres, on which there are the following buildings and improvements:

The land is located about _____ miles from _____ in _____
Magisterial District of said County.

I claim the following right, title, estate or interest in the tract or parcel of land described above: (In this space claimant should say whether he is sole owner or joint owner, and if joint owner give names of the joint owners. If claimant is not sole or joint owner, he should set out exactly what right, title, estate or interest he has in or to the tract or parcel of land described above.)

The land owners adjacent to the above described tract or parcel of land are as follows:
North _____
South _____
East _____
West _____

I acquired my right, title, estate or interest to this property about the year _____ in the following manner: _____

I claim that the total value of this tract or parcel of land with the improvements thereon is \$ _____ I claim that the total value of my right, title, estate or interest in and to this tract or parcel of land with the improvements thereon is \$ _____

I am the owner of _____ acres of land adjoining the above described tract or parcel of land but lying outside the Park area, which I claim will be damaged by the proposed condemnation of lands within the Park area, to the extent of \$ _____ (In the space below should be set out any additional statements or information as to this claim which claimant desires to make; and if practicable he should also insert here a description of the tract or parcel of land by metes and bounds.)

Remarks: _____

(Continue remarks if necessary on the back.)
Witness my signature (or my name and mark attached hereto) this _____ day _____ 1930.

STATE OF VIRGINIA, COUNTY OF _____
To-wit: _____

The undersigned hereby certifies that _____ the above named claimant personally appeared before him and made oath that the matters and things appearing in his above answer are true to the best of his knowledge and belief, this _____ day of _____ 1930.

Clerk of the Court or Special Investigator or Notary Public or Justice of the Peace

Filed July 24-1930
Mrs. P. D. Rice

Claim of R. B. Kite
In the Circuit Court of Madison County, Virginia, No. 82, At Law.
The State Commission on Conservation and Development of the State of Virginia, Petitioner, vs. W. D. Anderson et als.

28 acres of land
more or less, of land in Madison County, Virginia, Defendants.
The undersigned, in answer to the petition of the State Commission on Conservation and Development of the State of Virginia, and in response to the notice of condemnation awarded upon the filing of said petition and published in accordance with the order of the Circuit Court of Madison County, Virginia, asks leave of the Court to file this as his answer to said petition and to said notice.

My name is Mrs. R. B. Kite
My Post Office Address is Waxton

I claim a right, title, estate or interest in a tract or parcel of land within the area sought to be condemned, containing about 28 acres, on which there are the following buildings and improvements: none

This land is located about 2 miles from Groves Mill Virginia, in the Rapids Magisterial District of said County.

I claim the following right, title, estate or interest in the tract or parcel of land described above: (In this space claimant should say whether he is sole owner or joint owner, and if joint owner give names of the joint owners. If claimant is not sole or joint owner, he should set out exactly what right, title, estate or interest he has in or to the tract or parcel of land described above).
sole owner

The land owners adjacent to the above described tract or parcel of land are as follows:
North Mrs. L. P. Groves
South James P. Kite
East Chas. Carr & W. G. Payne
West Dowd

I acquired my right, title, estate or interest to this property about the year 1919 in the following manner:
by deed from Fritz Jenkins

I claim that the total value of this tract or parcel of land with the improvements thereon is \$ 280.00. I claim that the total value of my right, title, estate or interest, in and to this tract or parcel of land with the improvements thereon is \$ 280.00.

I am the owner of _____ acres of land adjoining the above described tract or parcel of land but lying outside the Park area, which I claim will be damaged by the proposed condemnation of lands within the Park area, to the extent of \$ _____.

(In the space below should be set out any additional statements or information as to this claim which claimant desires to make; and if practicable he should also insert here a description of the tract or parcel of land by metes and bounds).

Remarks: _____

(Continue remarks if necessary on the back).

Witness my signature (or my name and mark attached hereto) this 24 day of July, 1930.

STATE OF VIRGINIA, COUNTY OF Madison, To-wit:

The undersigned hereby certifies that R. B. Kite
the above named claimant personally appeared before him and made oath that the matters and things appearing in his above answer are true to the best of his knowledge and belief, this 24 day of July, 1930.

W. D. Anderson
Clerk of the Court, or Special Investigator or Notary Public, or Justice of the Peace.

Handwritten notes on the left margin:
24-7-30
R. B. Kite
24-7-30

Claim of P. B. Kille
In the Circuit Court of Madison County, Virginia, No. 82 At Law.
The State Commission on Conservation and Development of the State of Virginia, Petitioner, vs. U. S. Government et al.

more or less of land in Madison County, Virginia, Defendants.
The undersigned, in answer to the petition of the State Commission on Conservation and Development of the State of Virginia, and in response to the notice of condemnation awarded upon the filing of said petition and published in accordance with the order of the Circuit Court of Madison County, Virginia, asks leave of the Court to file this as his answer to said petition and to say that
My name is U. S. Government
My Post Office Address is Washington

I claim a right, title, estate or interest in a tract or parcel of land within the area sought to be condemned, containing about 2.8 acres, on which there are the following buildings and improvements: none

This land is located about 2 miles from Lawson Hill in Madison County, Virginia, in the Madison Magisterial District of said County.
I claim the following right, title, estate or interest in the tract or parcel of land described above: (In this space claimant should say whether he is sole owner or joint owner, and if joint owner give names of the joint owners. If claimant is not sole or joint owner, he should set out exactly what right, title, estate or interest he has in or to the tract or parcel of land described above.)
sole owner

The land owners adjacent to the above described tract or parcel of land are as follows:
North Mr. J. P. Jones
South James P. Kille
East U. S. Gov. & Mrs. Jones
West Lawson

I acquired my right, title, estate or interest to this property about the year 1919 in the following manner: by deed from J. P. Jones

I claim that the total value of this tract or parcel of land with the improvements thereon is \$ 280.00. I claim that the total value of my right, title, estate or interest in and to this tract or parcel of land with the improvements thereon is \$ 280.00.
I am the owner of 2.8 acres of land adjoining the above described tract or parcel of land but lying outside the Park area, which I claim will be damaged by the proposed condemnation of lands within the Park area, to the extent of \$ 280.00.
(In the space below should be set out any additional statements or information as to this claim which claimant desires to make; and if practicable he should also insert here a description of the tract or parcel of land by metes and bounds.)

Remarks:

(Continue remarks if necessary on the back.)
Witness my signature for my name and mark attached hereto, this 27 day of July, 1930.
STATE OF VIRGINIA, COUNTY OF Madison
To-wit: U. S. Government

The undersigned hereby certifies that the above named claimant personally appeared before him and made oath that the matters and things appearing in his above answer are true to the best of his knowledge and belief, this 27 day of July, 1930.
Clerk of the Court, or Special Commissioner
Notary Public or Justice of the Peace

Filed July 24-1930
Mrs. P. B. Kille