

County: Madison
District: Roberson

Claimant #185 - Seal, H. V.

Acreage Found: 50

Assessed 113

Deed 113-76
160

Location: Quaker Run, U. S. Positions #179 to #190. Part outside
the Park Area.

Incumbrances, counter claims or laps: None known.

Soil: Sandy loam of a fair depth and fertility. Slopes are
moderate to steep.

Roads: Twenty-two miles hard surface road to Culpeper, the nearest
shipping point.

History of tract and condition of timber: Fire has killed or badly
damaged the timber on a part of this tract. Some timber
has been removed from the timbered area. On 13 acres there
is estimated to be 33 M. saw timber, 70% oaks and 30% poplar
and 16 tons tanbark.

33 M. saw timber @ \$3.50 per M.	---	\$115.50
16 tons bark @ \$2.00 per ton.	---	\$ 32.00
		<u>\$147.50.</u>

Improvements: None.

Value of land by types:

Type	Acreage	Value per acre	Total Value
Slope	50	<u>\$5.00</u>	<u>\$250.00</u>

Summary:

Total value of land.	\$250.00
Total value of timber.	\$147.50
Total value of tract.	<u>\$397.50.</u>

L. W. Farnum Sec.

County: Madison
District: Roberson

Claimant #185-a - Seal, H. V.

Acreage Found: 236 A. Assessed: 282 A. Deed: 282 A.

Location: West side of German Ridge, near Hoover Road. Partly inside the Park boundary.

Incumbrances, counter claims or laps: None known.

Soil: Sandy loam. West slope steep and rocky.

Roads: Five miles to Criglersville; thence seventeen miles to Culpeper via State Highway, the nearest railroad.

History of tract and condition of timber: The tract has been culled for poplar and the choice oaks, but has been protected from fire and there is now some second growth poplar.

A peeling operation was in progress in April and May 1931, at the time the examination of the property was made, and a check cruise made after the completion of the peeling operation. The stand of timber remaining is as follows:

Red Oak and others	20 M. @ \$3.50	-----	\$70.00
Chestnut Oak	102 M. @ \$3.50	-----	\$357.00
Chestnut oak bark	300 T. @ \$2.00	-----	\$600.00
			<u>\$1027.00.</u>

Total value of fruit trees -- \$100.00.

Improvements: None.

Acreage and value of land by types:

<u>Type</u>	<u>Acreage</u>	<u>Value per acre</u>	<u>Total Value</u>
Slope	223	\$4.00	\$892.00
Fg	8	\$10.00	\$80.00
Fr	5	\$5.00	\$25.00
	<u>236</u>		<u>\$997.00.</u>

Summary:

Total value of land.	\$997.00
Total value of timber.	\$1027.00
Total value of fruit trees.	\$100.00
Total value of tract.	<u>\$2124.00.</u>

L. W. Farmer Sec.

County: Madison
District: Roberson

#185-Seal, H.V.

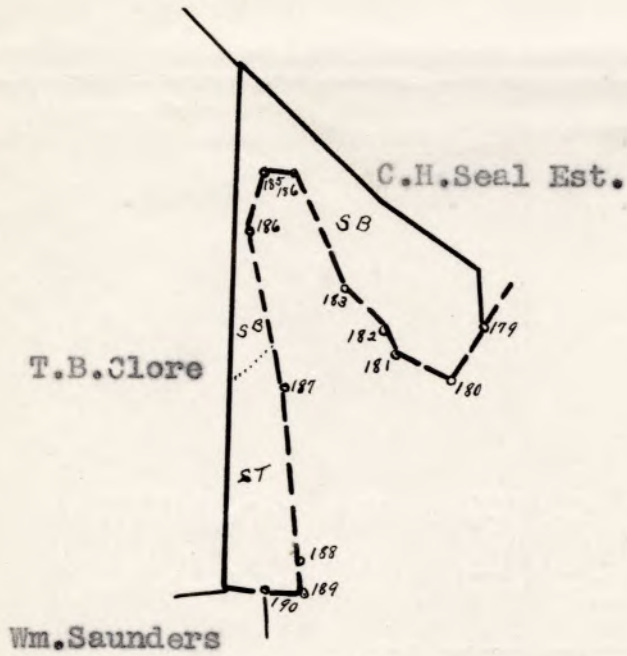

LEGEND:
Slope
Scale - 1" = 20 chains

County: Madison
District: Roberson

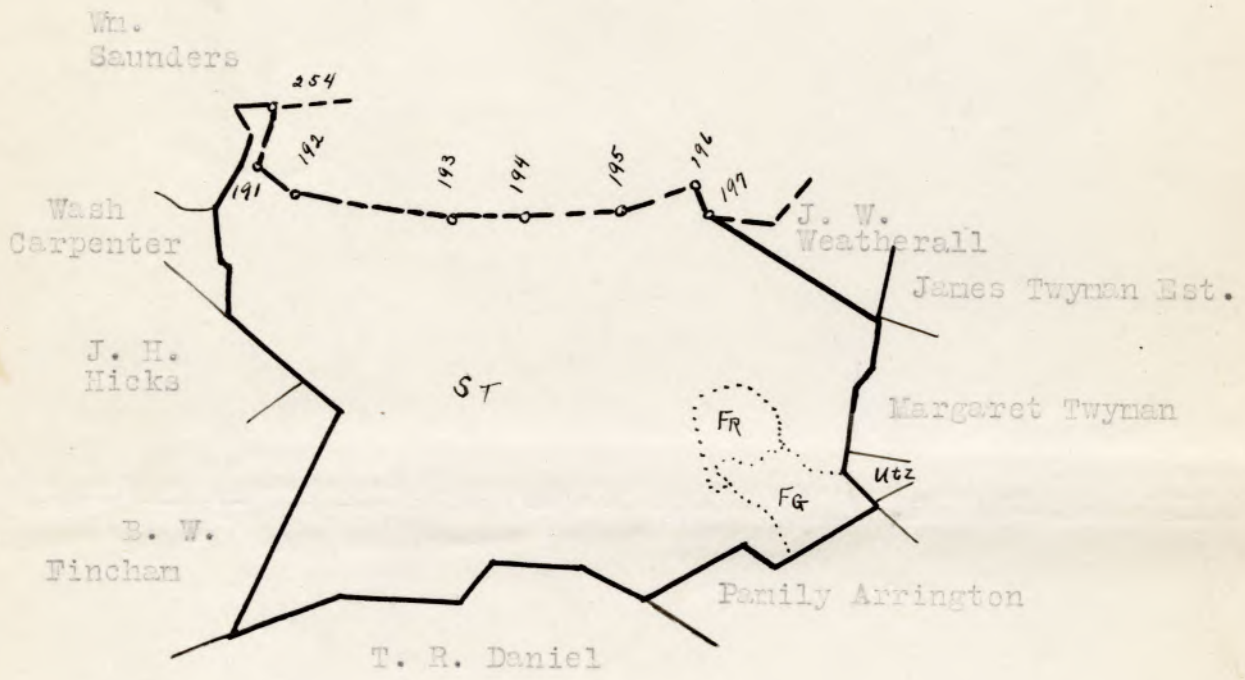

LEGEND
 Slope - Grazing
 Restocking
 Scale - 1" = 20 chains

REVISED REPORT

County: Madison
 District: Roberson

#185-a - Seal, H. V.

Acreage Claimed: 223 A Assessed: 282 A. Deed: 282 A.
Value Claimed: \$2899.00 Assessed: \$1892.00 Not given. (1925)
AREA: 236 A.

Location: West side of German Ridge, near Hoover road. Partly inside the Park boundary.

Incumbrances, counter claims or laps: None known.

Soil: Sandy loam. West slope steep and rocky.

Roads: Five miles to Criglersville; thence seventeen miles to Culpeper via State highway, the nearest railroad.

History of tract and condition of timber: The tract has been culled for poplar and the choice oaks, but has been protected from fire and there is now some second growth poplar. A peeling operation was in progress in April and May, 1931 at the time the examination of the property was made, and a check cruise made after the completion of the peeling operation. The stand of timber remaining is as follows:

Red Oak and others	20 M.	@ \$5.	} \$350 3.50 2.00	} (\$100.00) \$70.00 510.00 357.00 750.00 600.00
Chestnut Oak	102 M.	@ \$5.		
Chestnut oak bark	300 T.	@ (\$2.50)		
<i>Total Value Fruit Trees \$100.00 xx</i>				<u>\$1360.00</u> <u>1027</u>

Improvements: None.

Acreage and value of land by types:

<u>Type:</u>	<u>Acreage:</u>	<u>Value per acre</u>	<u>Total Value</u>
Slope	223	\$3.00	\$669.00
Grazing	8	8.00	64.00
Restocking	5	5.00	25.00
	<u>236</u>		<u>\$758.00</u>

Total value of land: \$758.00

Total value of orchard:
 (1 acre @ \$100.---\$100.00
 scattered- 87 trees
 @ 50¢----- 43.50

Total value of timber 143.50
 Total value of tract 1360.00
 Total value of tract \$2261.50
 Average value per acre \$9.58