

County: Madison  
District: Roberson

#176 - Smith, G. Y.

Acreage Found: 11                      Assessed: 36 A.                      Deed: No field sheet.

Location:     Rose River; U. S. Positions 134-135 and 136. Part  
                  outside the Park Area.

Incumbrances, counter claims or laps: None known.

Soil:           Sandy loam of a fair depth and fertility. Slopes are  
                  moderate to steep.

Roads:           4 $\frac{1}{2}$  miles dirt road and 18 miles hard surface road to  
                  Culpeper.

History of tract and condition of timber: All of the saw timber  
                  was removed from this tract several years ago.

Improvements: None.

Value of land by types:

<u>Type</u>	<u>Acreage</u>	<u>Value per acre</u>	<u>Total Value</u>
Slope	11	\$5.00	\$55.00

Summary:

Total value of land.                      \$55.00  
Total value of tract.                      \$55.00

*L. M. Farmer Sec.*

County: Madison  
District: Robertson

#176- Smith, G.V.

Acreage Claimed: Assessed: 36 A. Deed: No Field Sheet.  
Value Claimed: Assessed: \$244.00 Deed:

AREA: 11 A.

Location: Rose River; U. S. Positions 134-135 and 136. Part outside the Park Area.

Incumbrances, counter claims, or laps: None known.

Soil: Sandy loam of a fair depth and fertility. Slopes are moderate to steep.

Roads:  $4\frac{1}{2}$  miles dirt road and 18 miles hard surface road to Culpeper.

History of tract and condition of timber: All of the saw timber was removed from this tract several years ago.

Improvements: None.

Value of land by types:

<u>Type:</u>	<u>Acreage:</u>	<u>Value Per A.</u>	<u>Total Value</u>
Slope	11	\$2.50	\$22.00

Total value of land: \$22.00  
Total value of tract 22.00

Average value per acre: \$2.00



County: Madison  
District: Roberson

#176- Smith, G.Y.

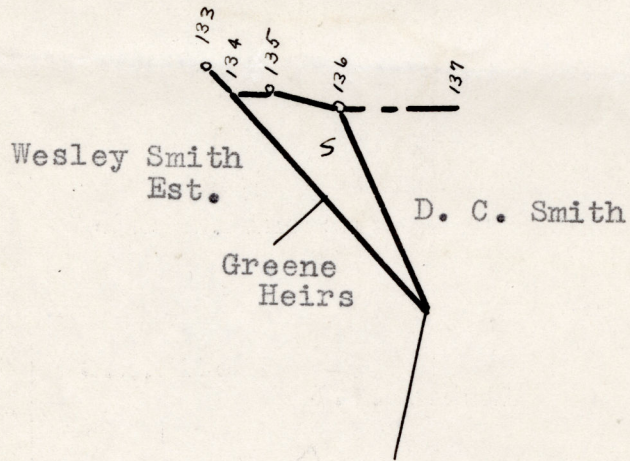
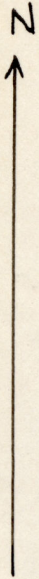

LEGEND:  
Slope  
Scale - 1" = 20 chains