

County: Madison
District: Roberson

#240 - Smith, W. J.

Acreage Found: 140 Assessed: 325 Deed: No field sheet.

Location: East side German Ridge, along Park boundary from stations #219 to #224 and partly outside of Park Area.

Incumbrances, counter claims or laps: None known.

Soil: Sandy loam, Slopes into cove, steep and rocky.

Roads: Five miles to Criglersville; thence seventeen miles via improved highway to Culpeper, nearest railroad point.

History of tract and condition of timber: Lower slopes culled for poplar and oaks. Mature poplar and oaks in cove. Heavy stand of chestnut (dead) on north slope. Land not burned recently.

Chestnut oak -- 120 M. ft.
Poplar -- 40 M. ft.
Red oak -- 15 M. ft.
Hickory -- 15 M. ft.
Miscellaneous-- 10

200 M. ft. @ \$3.00 -- \$600.00.

Improvements: 60 apple trees @ 50¢ --- \$30.00.

Value of land by types:

Type	Acreage	Value per acre	Total Value
Slope & Cove	138	\$5.00	\$690.00
Fg	2	\$10.00	20.00
	<u>140</u>		<u>\$710.00.</u>

Summary:

Total value of land. \$710.00
Total value of timber. \$600.00
Total value of fruit trees. 30.00
Total value of tract. \$1340.00.

L. H. Farmer, Sec.

County: Madison
District: Roberson

#240- Smith, W.J.

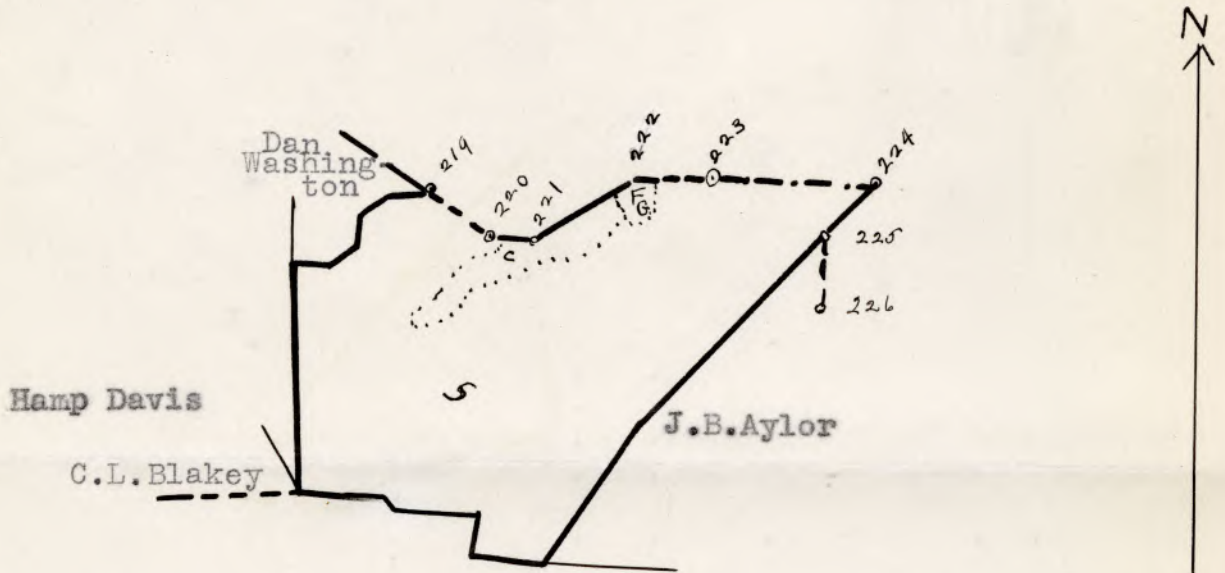

LEGEND:
Slope Grazing
Cove
Scale - 1" = 20 chains

County: Madison
District: Roberson

#240 - Smith, W. J.

Acreage Claimed: (no claim) Assessed: 325 Deed: No field sheet.
Value Claimed: Assessed: \$2975.00 Deed:

Area -- 140 A.

Location: East side German Ridge, along Park boundary from stations #219 to #224 and partly outside of Park area.

Incumbrances, counter claims or laps: None known.

Soil: Sandy loam. Slopes into cove, steep and rocky.

Roads: Five miles to Criglersville; thence seventeen miles via improved highway to Culpeper, nearest railroad point.

History of tract and condition of timber: Lower slopes culled for poplar and oaks. Mature poplar and oaks in cove. Heavy stand of chestnut (dead) on north slope. Land not burned recently.

Chestnut oak -- 120 M. ft.
Poplar -- 40 M. ft.
Red oak -- 15 M. ft.
Hickory -- 15 M. ft.
Miscellaneous -- 10
200 M. ft. @ ^{\$3.00} (\$2.80) = ^{\$600.00} (\$560.00).

Improvements: 60 apple trees @ 50¢ ---- \$30.00

Value of land by types:

Type	Acreage	Value per acre	Total Value
Slope	130	\$3.00	\$390.00
Cove	8	5.00	40.00
Grazing	2	8.00	16.00
	<u>140</u>		<u>\$446.00</u>

Total value of land.....\$446.00
Total value of fruit trees..
(60 apple trees @ 50¢)30.00
Total value of timber.....560.00
Total value of tract.....\$1036.00
Average value per acre.....\$ 7.40