

County: Madison
District: Roberson

Claimant #215 - Weatherall, J. W.

Acreage Found: 17 A.

Assessed: 33 A.

Deed: 33 A.

Location: North side German Ridge, on drains of Quaker Run.
Park boundary is west side of tract. Part outside.

Incumbrances, counter claims or laps: None known.

Soil: Sandy loam; slope, steep and rocky.

Roads: Three miles to Criglersville, N. E.

History of tract and condition of timber: Much dead chestnut, bark off.

	16 M. C. Oak, @ \$2.00	and Hickory @ \$3.00 per M --	\$102.00
Improvements:	None.		\$20.00
			<u>\$122.00</u>

Acreage and value of land by types:

Type	Acreage	Value per acre	Total Value
Slope	17	\$5.00	\$85.00

Summary:

Total value of land.	\$85.00
Total value of timber.	\$122.00
	<u>\$207.00.</u>

L. M. Farmer, Sec.

County: Madison
District: Roberson

#215- Weatherall, J.W.

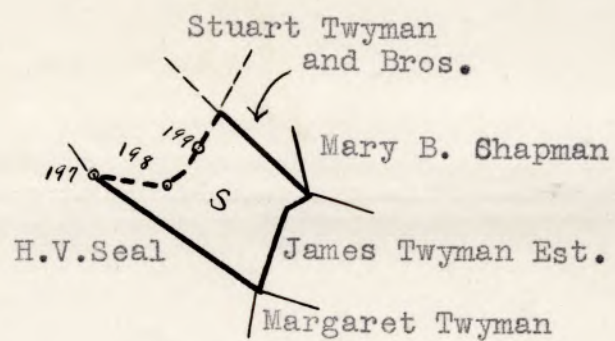

LEGEND:

Slope
Scale - 1" = 20 chains

County: Madison
District: Roberson

#215- Weatherall, J.W.

Acreage Claimed: 27 A. Assessed: 33 A. Deed: 33 A.
Value Claimed: \$540.00 Assessed: \$198.00 Deed: \$400.

Area: 17 A.

Location: North side Jarman Ridge, on drains of Quaker Run.

Park boundary is west side of tract. *Part outside.*

Incumbrances, counter claims or laps: None known.

Soil: Sandy loam; slope, steep and rocky.

Roads: Three miles to Criglersville, N.E.

History of tract and condition of timber: (Poplar and oaks cut out -
(only cull timber on land.) Much dead chestnut, bark off.

Improvements: ³⁴(10) M. C. Oak, Poplar and Hickory - @ \$3.00 per M. -- (\$30.00)
now 10 Tom Bark @ \$2.00

Acreage and value of land by types:

<u>Type:</u>	<u>Acreage:</u>	<u>Value per A.</u>	<u>Total Value</u>
Slope	17	\$3.00	\$51.00

Total value of land: \$51.00

Total value of timber: 30.00

Total value of tract: \$81.00

Average value per acre: \$4.76

215

Claim of J. W. Withrall
In the Circuit Court of Madison County, Virginia, No. 82, At Law.
The State Commission on Conservation and Development of the State of Virginia, Petitioner, vs. W. D. Anderson et al

27 acres, of land
more or less, of land in Madison County, Virginia, Defendants.
The undersigned, in answer to the petition of the State Commission on Conservation and Development of the State of Virginia, and in response to the notice of condemnation awarded upon the filing of said petition and published in accordance with the order of the Circuit Court of Madison County, Virginia, asks leave of the Court to file this as his answer to said petition and to said notice.

My name is J. W. Withrall
My Post Office Address is Crighersville Va

I claim a right, title, estate or interest in a tract or parcel of land within the area sought to be condemned, containing about 27 acres, on which there are the following buildings and improvements: none

This land is located about 3 miles from Crighersville Virginia, in the Madison Magisterial District of said County.

I claim the following right, title, estate or interest in the tract or parcel of land described above: (In this space claimant should say whether he is sole owner or joint owner, and if joint owner give names of the joint owners. If claimant is not sole or joint owner, he should set out exactly what right, title, estate or interest he has in or to the tract or parcel of land described above).
Sole

The land owners adjacent to the above described tract or parcel of land are as follows:

North Henry Ray
South John L. Ray
East J. W. Withrall
West J. W. Withrall

I acquired my right, title, estate or interest to this property about the year 1920 in the following manner:

Hogwood & Daigle et al.

I claim that the total value of this tract or parcel of land with the improvements thereon is \$ 540.00. I claim that the total value of my right, title, estate or interest, in and to this tract or parcel of land with the improvements thereon is \$ 540.00.

I am the owner of _____ acres of land adjoining the above described tract or parcel of land but lying outside the Park area, which I claim will be damaged by the proposed condemnation of lands within the Park area, to the extent of \$ _____.

(In the space below should be set out any additional statements or information as to this claim which claimant desires to make; and if practicable he should also insert here a description of the tract or parcel of land by metes and bounds).

Remarks: _____

(Continue remarks if necessary on the back).

Witness my signature (or my name and mark attached hereto) this 25 day of July, 1930.

STATE OF VIRGINIA, COUNTY OF Madison, To-wit:

The undersigned hereby certifies that _____
the above named claimant personally appeared before him and made oath that the matters and things appearing in his above answer are true to the best of his knowledge and belief, this 25 day of July, 1930.

Carl Stone
Clerk of the Court, or Special Investigator or
Notary Public, or Justice of the Peace.

J. W. Wickham

Filed July 20 - 1930

John Cotton Smith

Claim of _____
In the _____ Court of _____ County, Virginia, No. _____ At Law.
The State Commission on Conservation and Development of the State of Virginia, Petitioner,
vs.
_____, Defendant.

more or less of land in _____ County, Virginia, Defendants.
The undersigned, in answer to the petition of the State Commission on Conservation and Development of the State of Virginia, and in response to the notice of condemnation awarded upon the filing of said petition and published in accordance with the order of the Circuit Court of _____ County, Virginia, asks leave of the Court to file this as his answer to said petition and to said notice.

My name is _____
My Post Office Address is _____
I claim a right, title, estate or interest in a tract or parcel of land within the area sought to be condemned, containing about _____ acres, on which there are the following buildings and improvements: _____

This land is located about _____ miles from _____ Virginia, in the _____ Magisterial District of said County.

I claim the following right, title, estate or interest in the tract or parcel of land described above: (In this space claimant should say whether he is sole owner or joint owner, and if joint owner give names of the joint owners. If claimant is not sole or joint owner, he should set out exactly what right, title, estate or interest he has in or to the tract or parcel of land described above.)
John Cotton Smith

The land owner adjacent to the above described tract or parcel of land are as follows:
North _____
East _____
West _____
South _____

I acquired my right, title, estate or interest to this property about the year 1920 in the following manner:
John Cotton Smith

I claim that the total value of this tract or parcel of land with the improvements thereon is \$ 240.00. I claim that the total value of my right, title, estate or interest in and to this tract or parcel of land with the improvements thereon is \$ 240.00.

I am the owner of _____ acres of land adjoining the above described tract or parcel of land but lying outside the Park area, which I claim will be damaged by the proposed condemnation of lands within the Park area to the extent of \$ _____. (In the space below should be set out any additional statements or information as to the claim which claimant desires to make; and if practicable he should also insert here a description of the tract or parcel of land by metes and bounds.)

Remarks: _____

(Continue remarks if necessary on the back.)
Witness my signature (or my name and mark attached hereto) this _____ day of _____ 1930.
John Cotton Smith
STATE OF VIRGINIA, COUNTY OF _____
To-wit: _____
The undersigned hereby certifies that the above named claimant personally appeared before him and made oath that the matters and things appearing in his above answer are true to the best of his knowledge and belief.
this _____ day of _____ 1930.
John Cotton Smith
Clerk of the Court, or Special Investigator or Notary Public or Justice of the Peace.