

NAME OF CLAIMANT

#98 - Sampson, Mary E.

Number of Acres: 67

Location: Elk Run, on U. S. Positions 65-66-67. Entirely within the Park area.

Roads: County road, clay surface, 3 miles, one-half mile hard surface to Elkton, the nearest shipping point.

Soil: Slope type, sandy loam, with a fair depth and fertility. The tillable area of this tract is fairly level.

History of Tract and condition of timber: This tract has been heavily culled, the remaining stand consists of second growth white pine and oaks.

Improvements: LOG DWELLING, 14x17', 3 rooms, shingle and metal roof, 1 1/2 story, stone flue, condition poor, occupied by owner. Spring water supply. STABLE--Log 22x31x12', shingle roof, condition poor. ---HEN HOUSE--Frame 8x10x7', board roof, condition poor. STABLE--Log, 10x12x10', shingle roof, poor condition.

Acreage and value of types:

Types	Acreage		Value per acre	Total Value
Ridge:				
Slope: --	51	@	\$5.00	\$255.00
Cove:				
Grazing Land: --	16	@	30.00	480.00
				<hr/> \$735.00

Fields Restocking:

Cultivated Land:

Orchard:

Minerals:

Value of Land: \$	735.00	
Value of Improvements: \$	365.00	365.00
Value of Orchard: \$		50.00
Value of Minerals: \$		100.00
Value of Fruit: \$	50.00	50.00
Value of Timber: \$	100.00	<hr/> \$1300.00
Value of Wood: \$	50.00	
Value per acre for tract: \$	19.90	

Incidental damages arising from the taking of this tract: \$ None

*Geo. V. Pen* CLERK

Claim of \_\_\_\_\_  
In the Circuit Court of Rockingham County, Virginia, No. \_\_\_\_\_, At Law.  
The State Commission on Conservation and Development of the State of Virginia, Petitioner, vs. Mary Sampson  
Seventy-four acres

more or less, of land in Rockingham County, Virginia, Defendants.  
The undersigned, in answer to the petition of the State Commission on Conservation and Development of the State of Virginia, and in response to the notice of condemnation awarded upon the filing of said petition and published in accordance with the order of the Circuit Court of Rockingham County, Virginia, asks leave of the Court to file this as his answer to said petition and to said notice.

My name is Mary Sampson  
My post office address is Swift Run Va.

I claim a right, title, estate or interest in a tract or parcel of land within the area sought to be condemned, containing about 74 acres, on which there are the following buildings and improvements: Small dwelling, stable and henhouse

This land is located about three miles from Elkton Virginia, in the Stonewall Magisterial District of said County.

I claim the following right, title, estate or interest in the tract or parcel of land described above: (In this space claimant should say whether he is sole owner or joint owner, and if joint owner give names of the joint owners. If claimant is not sole or joint owner, he should set out exactly what right, title, estate or interest he has in or to the tract or parcel of land described above.)

I am sole owner, feesimple of title

The land owners adjacent to the above described tract or parcel of land are as follows:  
North Marvinney Hensley  
South Ted Hensley  
East Sigourney Hensley  
West Will Wood

I acquired my right, title, estate or interest to this property about the year 1912 in the following manner:

By deed from E.D. Ott Special Commissioner of Court.

I claim that the total value of this tract or parcel of land with the improvements thereon is \$ 1750.00. I claim that the total value of my right, title, estate or interest, in and to this tract or parcel of land with the improvements thereon is \$ 1750.00.

I am the owner of \_\_\_\_\_ acres of land adjoining the above described tract or parcel of land but lying outside the Park area, which I claim will be damaged by the proposed condemnation of lands within the Park area, to the extent of \$ \_\_\_\_\_.

(In the space below should be set out any additional statements or information as to this claim which claimant desires to make; and if practicable he should also insert here a description of the tract or parcel of land by metes and bounds).

Remarks: \_\_\_\_\_

(Continue remarks if necessary on the back).

Witness my signature (or my name and mark attached hereto) this 11th day of February, 1930<sup>1</sup>

STATE OF VIRGINIA, COUNTY OF Rockingham, To-wit:

The undersigned hereby certifies that Mary Sampson the above named claimant personally appeared before him and made oath that the matters and things appearing in his above answer are true to the best of his knowledge and belief, this 11th day of February 1931, 1930.

H. B. Guitey Jr.  
Clerk of the Court, or Special Investigator or Notary Public, or Justice of the Peace.

Filed in the Clerk's Office  
Rockingham County, Va.  
FEB 17 1931  
Clerk

S - Z

County: Rockingham  
 District: Stonewall

#98 - Mary E. Sampson

Acreage Claimed: 74      Assessed 70.77      Deed ( sold 4 A. to T. Hensley in 1927) 70.77

Value Claimed: \$1750.00      "      \$390.00      " (1921) Area: 65 \$1650.00

Location: Elk Run, on U. S. Positions 65-66-67. Entirely within the Park area.

Laps: None known.

Soil: Slope type, sandy loam with a fair depth of fertility. The tillable area of this tract is fairly level.

Roads: County road, clay surface, 3 miles, 1/2 mile hard surfacette to Elkton, the nearest shippingpoint.

History: This tract has been heavily culled, the remaining stands consist of second growth, white pine and oaks about  
 15,000 Bd. ft saw timber on 49 A. @ \$4.00 per M. \$60.00  
 196 cds. of fuel wood on 49 A. @ \$1.00 per Cd. \$196.00  
 \$256.00

Improvements: Log, Dwelling 14x17, 3 rooms, shingle and metal roof, 1 1/2 story, stone flue, condition poor, occupied by owner, Spring water supply, Value ----- \$75.00  
 Stable, log 22x31x12, Shingle roof, cond. poor, ----- \$100.00  
 Hen house, Frame 8x10x7, Board roof, Cond. poor. ----- 5.00  
 Stable, log 10x12x10, Shingle roof, Cond. poor. ----- 15.00  
 \$195.00

Value of land by types:

Type	Acreage	Value per acre	Total Value
Slope	49	\$5.00	\$245.00
Tillable	16	\$25.00	400.00
	65		\$645.00

Total value of land \$645.00  
 Total value of improvements \$195.00  
 Total value of timber 256.00  
 Value of 14 fruit trees 20.00  
 Total value of tract \$1116.00

Average value per acre 17.17

#98 Sampson, Mary E.

County: Rockingham  
District: Stonewall

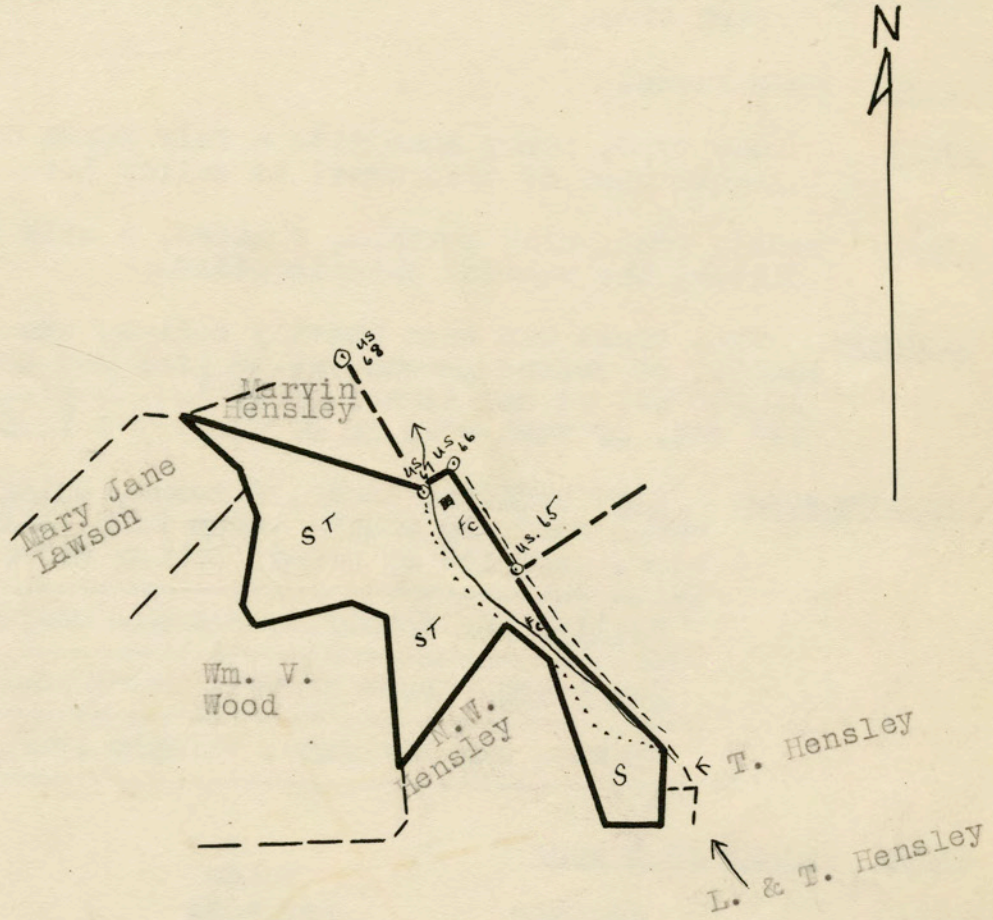

LEGEND

Slope - Tillable  
Scale - 1" = 20 chains

Claim of The School Board of Rockingham County  
In the Circuit Court of Rockingham County, Virginia, No. 1829, At Law.  
The State Commission on Conservation and Development of the State of Virginia, Petitioner, vs. Cassandra Lawson Atkins and others 52,561 acres

more or less, of land in Rockingham County, Virginia, Defendants.  
The undersigned, in answer to the petition of the State Commission on Conservation and Development of the State of Virginia, and in response to the notice of condemnation awarded upon the filing of said petition and published in accordance with the order of the Circuit Court of Rockingham County, Virginia, asks leave of the Court to file this as his answer to said petition and to said notice.

My name is The School Board of Rockingham County

My post office address is Harrisonburg, Va.

I claim a right, title, estate or interest in a tract or parcel of land within the area sought to be condemned, containing about One acres, on which there are the following buildings and improvements: One-room school building.

This land is located about six miles ~~from~~ southeast of Elkton, Virginia, in the Stonewall Magisterial District of said County.

I claim the following right, title, estate or interest in the tract or parcel of land described above: (In this space claimant should say whether he is sole owner or joint owner, and if joint owner give names of the joint owners. If claimant is not sole or joint owner, he should set out exactly what right, title, estate or interest he has in or to the tract or parcel of land described above.)

Sole owner

The land owners adjacent to the above described tract or parcel of land are as follows:

North Surrounded by lands of A. E. Wyant.

South \_\_\_\_\_

East \_\_\_\_\_

West \_\_\_\_\_

I acquired my right, title, estate or interest to this property about the year 1885 in the following manner:

Purchased from J. W. Baugher.

I claim that the total value of this tract or parcel of land with the improvements thereon is \$ 600.00. I claim that the total value of my right, title, estate or interest, in and to this tract or parcel of land with the improvements thereon is \$ 600.00.

I am the owner of \_\_\_\_\_ acres of land adjoining the above described tract or parcel of land but lying outside the Park area, which I claim will be damaged by the proposed condemnation of lands within the Park area, to the extent of \$ \_\_\_\_\_.

(In the space below should be set out any additional statements or information as to this claim which claimant desires to make; and if practicable he should also insert here a description of the tract or parcel of land by metes and bounds).

Remarks: \_\_\_\_\_

(Continue remarks if necessary on the back).

Witness my signature (or my name and mark attached hereto) this 11<sup>th</sup> day of February, 1930.

STATE OF VIRGINIA, COUNTY OF Rockingham, To-wit: School Board of Rockingham Co.

The undersigned hereby certifies that John C. Myers the above named claimant personally appeared before him and made oath that the matters and things appearing in his above answer are true to the best of his knowledge and belief, this 11 day of Feb., 1930.

J. A. Blackburn  
Clerk of the Court, or Special Investigator or Notary Public, or Justice of the Peace.

2/11/31

Claim of The School Board of Rockingham County  
In the Circuit Court of Rockingham County, Virginia, No. 1829, At Law.  
The State Commission on Conservation and Development of the State of Virginia, Petitioner, vs. Cassandra Lawson Atkins and others 52,561 acres

more or less, of land in Rockingham County, Virginia, Defendants.  
The undersigned, in answer to the petition of the State Commission on Conservation and Development of the State of Virginia, and in response to the notice of condemnation awarded upon the filing of said petition and published in accordance with the order of the Circuit Court of Rockingham County, Virginia, asks leave of the Court to file this as his answer to said petition and to said notice.

My name is The School Board of Rockingham County  
My post office address is Harrisonburg, Va.

I claim a right, title, estate or interest in a tract or parcel of land within the area sought to be condemned, containing about one acres, on which there are the following buildings and improvements: One-room school building.

This land is located about 10 miles from East of Elkton, Virginia, in the Stonewall Magisterial District of said County.

I claim the following right, title, estate or interest in the tract or parcel of land described above: (In this space claimant should say whether he is sole owner or joint owner, and if joint owner give names of the joint owners. If claimant is not sole or joint owner, he should set out exactly what right, title, estate or interest he has in or to the tract or parcel of land described above.)  
Sole Owner

The land owners adjacent to the above described tract or parcel of land are as follows:  
North Mr. Tom Hensley and others.  
South \_\_\_\_\_  
East \_\_\_\_\_  
West \_\_\_\_\_

I acquired my right, title, estate or interest to this property about the year \_\_\_\_\_ in the following manner:

I claim that the total value of this tract or parcel of land with the improvements thereon is \$1,200.00. I claim that the total value of my right, title, estate or interest, in and to this tract or parcel of land with the improvements thereon is \$1,200.00.

I am the owner of \_\_\_\_\_ acres of land adjoining the above described tract or parcel of land but lying outside the Park area, which I claim will be damaged by the proposed condemnation of lands within the Park area, to the extent of \$\_\_\_\_\_.

(In the space below should be set out any additional statements or information as to this claim which claimant desires to make; and if practicable he should also insert here a description of the tract or parcel of land by metes and bounds).

Remarks: \_\_\_\_\_  
\_\_\_\_\_  
\_\_\_\_\_

(Continue remarks if necessary on the back).

Witness my signature (or my name and mark attached hereto) this 11<sup>th</sup> day of February, 1930.  
School Board of Rockingham Co.

STATE OF VIRGINIA, COUNTY OF Rockingham, To-wit: John B. Myers Clerk

The undersigned hereby certifies that John B. Myers the above named claimant personally appeared before him and made oath that the matters and things appearing in his above answer are true to the best of his knowledge and belief, this 11<sup>th</sup> day of Feb., 1930.

J. Blackburn  
Clerk of the Court, or Special Investigator or Notary Public, or Justice of the Peace.

2/11/31

Claim of The School Board of Rockingham County  
In the Circuit Court of Rockingham County, Virginia, No. \_\_\_\_\_, At Law.  
The State Commission on Conservation and Development of the State of Virginia, Petitioner, vs. Cassandra Lawson Atkins and others 52,561 acres

more or less, of land in Rockingham County, Virginia, Defendants.  
The undersigned, in answer to the petition of the State Commission on Conservation and Development of the State of Virginia, and in response to the notice of condemnation awarded upon the filing of said petition and published in accordance with the order of the Circuit Court of Rockingham County, Virginia, asks leave of the Court to file this as his answer to said petition and to said notice.

My name is The School Board of Rockingham County  
My post office address is Harrisonburg, Va.

I claim a right, title, estate or interest in a tract or parcel of land within the area sought to be condemned, containing about one acres, on which there are the following buildings and improvements: Single room school building

This land is located about ten miles from East of Elkton, Virginia, in the Stonewall Magisterial District of said County.

I claim the following right, title, estate or interest in the tract or parcel of land described above: (In this space claimant should say whether he is sole owner or joint owner, and if joint owner give names of the joint owners. If claimant is not sole or joint owner, he should set out exactly what right, title, estate or interest he has in or to the tract or parcel of land described above.)

Sole owner

The land owners adjacent to the above described tract or parcel of land are as follows:  
North \_\_\_\_\_  
South \_\_\_\_\_  
East \_\_\_\_\_  
West \_\_\_\_\_

I acquired my right, title, estate or interest to this property about the year 1881 in the following manner:

Purchased from Solomon Dean

I claim that the total value of this tract or parcel of land with the improvements thereon is \$1,200.00. I claim that the total value of my right, title, estate or interest, in and to this tract or parcel of land with the improvements thereon is \$1,200.00.

I am the owner of \_\_\_\_\_ acres of land adjoining the above described tract or parcel of land but lying outside the Park area, which I claim will be damaged by the proposed condemnation of lands within the Park area, to the extent of \$\_\_\_\_\_.

(In the space below should be set out any additional statements or information as to this claim which claimant desires to make; and if practicable he should also insert here a description of the tract or parcel of land by metes and bounds).

Remarks: \_\_\_\_\_  
\_\_\_\_\_  
\_\_\_\_\_

(Continue remarks if necessary on the back).

Witness my signature (or my name and mark attached hereto) this 11<sup>th</sup> day of February, 1930.

STATE OF VIRGINIA, COUNTY OF Rockingham To-wit: John C. Meyer

The undersigned hereby certifies that John C. Meyer the above named claimant personally appeared before him and made oath that the matters and things appearing in his above answer are true to the best of his knowledge and belief, this 11 day of Feb., 1930.

J. F. Blackburn  
Clerk of the Court, or Special Investigator or Notary Public, or Justice of the Peace.

2/11/31

Claim of The School Board of Rockingham County  
In the Circuit Court of Rockingham County, Virginia, No. 1829, At Law.  
The State Commission on Conservation and Development of the State of Virginia, Petitioner, vs. Cassandra Lawson Atkins and others 52,561 acres

more or less, of land in Rockingham County, Virginia, Defendants.  
The undersigned, in answer to the petition of the State Commission on Conservation and Development of the State of Virginia, and in response to the notice of condemnation awarded upon the filing of said petition and published in accordance with the order of the Circuit Court of Rockingham County, Virginia, asks leave of the Court to file this as his answer to said petition and to said notice.

My name is The School Board of Rockingham County  
My post office address is Harrisonburg, Va.

I claim a right, title, estate or interest in a tract or parcel of land within the area sought to be condemned, containing about one acres, on which there are the following buildings and improvements: One-room school building.

This land is located about six miles ~~from~~ southeast of Elkton, Virginia, in the Stonewall Magisterial District of said County.

I claim the following right, title, estate or interest in the tract or parcel of land described above: (In this space claimant should say whether he is sole owner or joint owner, and if joint owner give names of the joint owners. If claimant is not sole or joint owner, he should set out exactly what right, title, estate or interest he has in or to the tract or parcel of land described above.)  
Sole owner.

The land owners adjacent to the above described tract or parcel of land are as follows:  
~~North~~ J. M. Comer and Henry Shiflett.  
South \_\_\_\_\_  
East \_\_\_\_\_  
West \_\_\_\_\_

I acquired my right, title, estate or interest to this property about the year 1928 in the following manner:  
Purchased from J. M. Comer

I claim that the total value of this tract or parcel of land with the improvements thereon is \$ 700.00. I claim that the total value of my right, title, estate or interest, in and to this tract or parcel of land with the improvements thereon is \$ 700.00.

I am the owner of \_\_\_\_\_ acres of land adjoining the above described tract or parcel of land but lying outside the Park area, which I claim will be damaged by the proposed condemnation of lands within the Park area, to the extent of \$ \_\_\_\_\_.

(In the space below should be set out any additional statements or information as to this claim which claimant desires to make; and if practicable he should also insert here a description of the tract or parcel of land by metes and bounds).

Remarks: \_\_\_\_\_  
\_\_\_\_\_  
\_\_\_\_\_

(Continue remarks if necessary on the back).

Witness my signature (or my name and mark attached hereto) this 11<sup>th</sup> day of February, 1930.

STATE OF VIRGINIA, COUNTY OF Rockingham, To-wit: School Board of Rockingham Co. John C. Guyer clerk

The undersigned hereby certifies that John C. Guyer the above named claimant personally appeared before him and made oath that the matters and things appearing in his above answer are true to the best of his knowledge and belief, this 11 day of Feb., 1930.

J. H. Blackbeem  
Clerk of the Court, or Special Investigator or Notary Public, or Justice of the Peace.

211/31



Claim of The School Board of Rockingham County  
In the Circuit Court of Rockingham County, Virginia, No. 1829, At Law.  
The State Commission on Conservation and Development of the State of Virginia, Petitioner, vs. Cassandra Lawson Atkins and others 52,561 acres

more or less, of land in Rockingham County, Virginia, Defendants.  
The undersigned, in answer to the petition of the State Commission on Conservation and Development of the State of Virginia, and in response to the notice of condemnation awarded upon the filing of said petition and published in accordance with the order of the Circuit Court of Rockingham County, Virginia, asks leave of the Court to file this as his answer to said petition and to said notice.

My name is The School Board of Rockingham County

My post office address is Harrisonburg, Va.

I claim a right, title, estate or interest in a tract or parcel of land within the area sought to be condemned, containing about 82 poles acres, on which there are the following buildings and improvements: One-room school building (new)

This land is located about three miles from South of Port Republic Virginia, in the Stonewall Magisterial District of said County.

I claim the following right, title, estate or interest in the tract or parcel of land described above: (In this space claimant should say whether he is sole owner or joint owner, and if joint owner give names of the joint owners. If claimant is not sole or joint owner, he should set out exactly what right, title, estate or interest he has in or to the tract or parcel of land described above.)

Sole owner.

The land owners adjacent to the above described tract or parcel of land are as follows:

North Ashby Mace

South Arthur Raines

East Ashby Mace

West \_\_\_\_\_

I acquired my right, title, estate or interest to this property about the year 1883 in the following manner:

Purchased from Sara Sipe

I claim that the total value of this tract or parcel of land with the improvements thereon is \$ 1,650.00. I claim that the total value of my right, title, estate or interest, in and to this tract or parcel of land with the improvements thereon is \$ 1,650.00.

I am the owner of \_\_\_\_\_ acres of land adjoining the above described tract or parcel of land but lying outside the Park area, which I claim will be damaged by the proposed condemnation of lands within the Park area, to the extent of \$ \_\_\_\_\_.

(In the space below should be set out any additional statements or information as to this claim which claimant desires to make; and if practicable he should also insert here a description of the tract or parcel of land by metes and bounds).

Remarks: \_\_\_\_\_

(Continue remarks if necessary on the back).

Witness my signature (or my name and mark attached hereto) this 11<sup>th</sup> day of February, 1930.

STATE OF VIRGINIA, COUNTY OF Rockingham, To-wit: John C. Myers

The undersigned hereby certifies that John C. Myers the above named claimant personally appeared before him and made oath that the matters and things appearing in his above answer are true to the best of his knowledge and belief, this 11 day of Feb., 1930.

J. F. Blackman  
Clerk of the Court, or Special Investigator or Notary Public, or Justice of the Peace.

2/11/31

Claim of The School Board of Rockingham County  
In the Circuit Court of Rockingham County, Virginia, No. 1829, At Law.  
The State Commission on Conservation and Development of the State of Virginia, Petitioner, vs. Cassandra Lawson Atkins and others 52,561 acres

more or less, of land in Rockingham County, Virginia, Defendants.  
The undersigned, in answer to the petition of the State Commission on Conservation and Development of the State of Virginia, and in response to the notice of condemnation awarded upon the filing of said petition and published in accordance with the order of the Circuit Court of Rockingham County, Virginia, asks leave of the Court to file this as his answer to said petition and to said notice.

My name is The School Board of Rockingham County  
My post office address is Harrisonburg, Va.

I claim a right, title, estate or interest in a tract or parcel of land within the area sought to be condemned, containing about 1 rood, 18 poles acres, on which there are the following buildings and improvements: One-room school building.

This land is located about eight miles ~~from~~ East from Elkton, Virginia, in the Stonewall Magisterial District of said County.

I claim the following right, title, estate or interest in the tract or parcel of land described above: (In this space claimant should say whether he is sole owner or joint owner, and if joint owner give names of the joint owners. If claimant is not sole or joint owner, he should set out exactly what right, title, estate or interest he has in or to the tract or parcel of land described above.)  
Sole owner.

The land owners adjacent to the above described tract or parcel of land are as follows:  
North Land around owned by Q. E. Smith.  
South \_\_\_\_\_  
East \_\_\_\_\_  
West \_\_\_\_\_

I acquired my right, title, estate or interest to this property about the year 1890 in the following manner:  
Purchased from Thomas Hensley.

I claim that the total value of this tract or parcel of land with the improvements thereon is \$ 700.00. I claim that the total value of my right, title, estate or interest, in and to this tract or parcel of land with the improvements thereon is \$ 700.00.

I am the owner of \_\_\_\_\_ acres of land adjoining the above described tract or parcel of land but lying outside the Park area, which I claim will be damaged by the proposed condemnation of lands within the Park area, to the extent of \$ \_\_\_\_\_.

(In the space below should be set out any additional statements or information as to this claim which claimant desires to make; and if practicable he should also insert here a description of the tract or parcel of land by metes and bounds).

Remarks: \_\_\_\_\_  
\_\_\_\_\_  
\_\_\_\_\_

(Continue remarks if necessary on the back).

Witness my signature (or my name and mark attached hereto) this 11<sup>th</sup> day of February, 1930.

STATE OF VIRGINIA, COUNTY OF Rockingham, To-wit: John C. Myers

The undersigned hereby certifies that John C. Myers the above named claimant personally appeared before him and made oath that the matters and things appearing in his above answer are true to the best of his knowledge and belief, this 11<sup>th</sup> day of Feb., 1930.

H. B. Black  
Clerk of the Court, or Special Investigator or Notary Public, or Justice of the Peace.

2/11/31