

NAME OF CLAIMANT

#121 - Shifflett, George W.

Number of Acres: 22

Location: Near Sandy Bottom.

Roads: One mile of fair dirt road to Spottswood Trail near Swift Run; thence four miles to Elkton.

Soil: Sandy clay of good depth and fertility; moderate slopes; southeast and southwest exposures.

History of Tract and condition of timber: Portion of tract cleared many years ago, and has been cultivated since. Wooded area cut over repeatedly in the past. Present stand consists of mixed oaks and yellow pine.

Improvements:

Acreage and value of types:

Types	Acreage		Value per acre	Total Value
Ridge:				
Slope: --	13	@	\$5.00	\$65.00
Cove:				
Grazing Land:				
Fields Restocking:				
Cultivated Land: --	$\frac{9}{22}$	@	25.00	$\frac{225.00}{\$290.00}$

Orchard:

Minerals:

Value of Land: \$ 290.00

Value of Improvements: \$

50.00

Value of Orchard: \$

\$340.00

Value of Minerals: \$

Value of Fruit: \$

Value of Timber: \$

Value of Wood: \$ 50.00

Value per acre for tract: \$ 15.45

Incidental damages arising from the taking of this tract: \$ 15.45

Geo. L. Pen: CLERK

County: Rockingham
District: Stonewall

#121 - Shiflett, George W.

* Acreage Claimed: 24 A. Assessed: 22 A. 124 P. Deed: Part of 23 $\frac{1}{2}$ A. tract was later sold & may be owned by J. M. Comer.
Value Claimed: \$1500. " (23 $\frac{1}{2}$ A. --1918 - \$550.00
(5 $\frac{1}{2}$ A ---1911 - \$300.00
(3 $\frac{1}{2}$ A.----1921 - \$162.00

Location: Near Sandy Bottom.

Incumbrances, counter claims or laps: None known.

Soil: Sandy clay of good depth and fertility; moderate slopes; Southeast and southwest exposure.

Roads: One mile of fair dirt road to Spotswood Trail near Swift Run; thence four miles to Elkton.

History of tract and condition of timber: Portion of tract cleared many years ago, and has been cultivated since. Wooded area cut over repeatedly in the past. Present stand consists of mixed oaks and yellow pine. Estimated to cut an average of 6 cords per acre of fuelwood valued @ 50¢ or a total of 78 cords @ 50¢ per cord ----- \$39.00

Improvements: None.

Value of land by types:

Type	Acreage	Value per acre	Total Value
Slope	13	\$4.00	\$52.00
F c	9	25.00	225.00
	<u>22</u>		<u>277.00</u>

Total value of land \$277.00
Total value of timber 39.00
Total value of tract 316.00
Average value per acre 14.37

* - Includes Tract No. 121a.

#121 - Shifflett, George W.

County: Rockingham
District: Stonewall

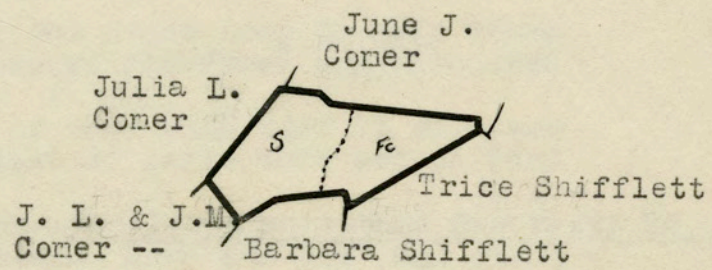
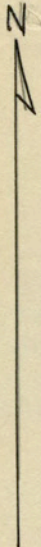

LEGEND

Slope - Tillable
Scale - 1" = 20 chains

STATE COMMISSION ON CONSERVATION AND DEVELOPMENT OF THE STATE
OF VIRGINIA.

I, Geo. W. Shifflett in the county of Rockingham, State of Virginia, do offer my right, title and interest in two tracts of land, or parcel of lands within the Park area: Tract No. 1 containing about 8 acres, with one dwelling house, three large rooms, with metal roof; good kitchen and two porches with metal roof. 46 apple trees; six quince trees; 2 cherry trees; corn crib and smoke house; one stable; one chicken house. My dwelling house and kitchen I had insured for \$600.00. This land is bounded on the north by J. M. Comer and Barbara Shifflett; on the east by D. S. Roach; on the south by D. S. Roach and J. J. Comer, and on the west by J. J. Comer.

Tract No. 2. I also claim the right and title to second tract or parcel of land containing about 16 acres. This tract has about five acres in cultivation and the rest in woodland. Bounded on the north by J. M. Comer; on the east by J. J. Comer and A. J. Williams; on the south by T. M. Shifflett; and on the west by J. M. Comer. I claim that the total value of these two tracts or parcels of land with improvements is worth \$1500.00. For further reference I refer you to the Clerk's Office of Rockingham county for accurate description of the foregoing lands.

I also agree to take when presented to me, the \$1500.00 for the two tracts of land, and sign my full right and title to the State Commission or who he may be that is acting as Agent or Commissioner for the Park area upon his approved check, if said check shall be presented to me within the next six months, and if paid within the next six months, on or before August 10, 1931, this shall remain in full force, if not this obligation and offer shall be void.

Yours for a square deal

G. W. Shifflett

Swift Run.

Claim of _____
In the Circuit Court of _____ County, Virginia, No. _____, At Law.
The State Commission on Conservation and Development of the State of Virginia, Petitioner, vs. _____

more or less, of land in _____ County, Virginia, Defendants.
The undersigned, in answer to the petition of the State Commission on Conservation and Development of the State of Virginia, and in response to the notice of condemnation awarded upon the filing of said petition and published in accordance with the order of the Circuit Court of _____ County, Virginia, asks leave of the Court to file this as his answer to said petition and to said notice.

My name is _____

My post office address is _____

I claim a right, title, estate or interest in a tract or parcel of land within the area sought to be condemned, containing about _____ acres, on which there are the following buildings and improvements: _____

This land is located about _____ miles from _____ Virginia, in the _____ Magisterial District of said County.

I claim the following right, title, estate or interest in the tract or parcel of land described above: (In this space claimant should say whether he is sole owner or joint owner, and if joint owner give names of the joint owners. If claimant is not sole or joint owner, he should set out exactly what right, title, estate or interest he has in or to the tract or parcel of land described above.) _____

The land owners adjacent to the above described tract or parcel of land are as follows:

North _____

South _____

East _____

West _____

I acquired my right, title, estate or interest to this property about the year _____ in the following manner: _____

I claim that the total value of this tract or parcel of land with the improvements thereon is \$_____. I claim that the total value of my right, title, estate or interest, in and to this tract or parcel of land with the improvements thereon is \$_____.

I am the owner of _____ acres of land adjoining the above described tract or parcel of land but lying outside the Park area, which I claim will be damaged by the proposed condemnation of lands within the Park area, to the extent of \$_____.

(In the space below should be set out any additional statements or information as to this claim which claimant desires to make; and if practicable he should also insert here a description of the tract or parcel of land by metes and bounds).

Remarks: _____

(Continue remarks if necessary on the back).

Witness my signature (or my name and mark attached hereto) this _____ day of _____, 1930.

STATE OF VIRGINIA, COUNTY OF _____, To-wit:

The undersigned hereby certifies that _____ the above named claimant personally appeared before him and made oath that the matters and things appearing in his above answer are true to the best of his knowledge and belief, this _____ day of _____, 1930.

Swift-Run, Va.
Feb. 10. 1931.

Mr. J. Robert Switzer.
Harrisonburg, Va.

Friend Robert,

Enclose herewith a
petition or a sale bill or
what ever you may call it.
would you be so kind as to
hand this to the committee
for me. as I am not feeling
so well, and just don't know
when I am coming to town
will appreciate it very much
Hope you and yours are all
well.

I am very Sincerely yours.
S. W. Shifflett.

The State Commission on Conservation and
Development of the State of Virginia.

I G. W. Shifflett in the County of Rockingham
State of Virginia, do offer my right title and
and interest in two tracts of land or parcel
of lands with in the park area. Tract No 1
Containing about eight acres, with one
dwelling house with three large rooms
with the mittle roof, good kitchen and
two porches with mittle roofing, forty six
apple trees, six quince trees, two cherry trees,
corn crib and smoke house, one stable,
one chicken house. My dwelling house and
kitchen, I had insured for six hundred
dollars. This land is bounded on the
north by J. M. Comer, and Barbara A.
Shifflett, on the East by D. S. Roach, on the
South by D. S. Roach, and J. J. Comer, on
the West by J. M. Comer.

Tract No 2 I also claim the right and
title to second tract or parcel of land,
Containing about sixster acres. This tract has
about five acres in cultivation and the rest
in woodland. Bounded on the north by J. M.
Comer, on the East by J. J. Comer, and A. J. Williams
Comer, on the South J. M. Shifflett, on the West by J. M.
I claim that the total value of these
two tracts or parcel of lands with the improve-
thereon is worth fifteen hundred dollars. \$1500.00

For farther reference. I will refer you to the
Clerk Office in Rockingham County for an accurate
discription of the foregoing describe lands.

I also agree to take when presented to me the
#) \$500.00 for the two tracts of lands, and
sign my full rights and title, to the state
Commission, or whom he may be, that's acting
as agent or Commissioner for the park area,
upon his approval check. if said check shall
be presented to me with in the next six months
and if paid with in the next six months, on
or before August the 10th 1931, this shall be
remain in full force, if not this obligation
and offer shall be avoid.

Yours for a square deal
G. W. Shifflett