

County: Rappahannock
District: Piedmont

NAM. 021

#99- Harrell, Mrs. Savilla

Number of Acres: 136 $\frac{1}{4}$

Location: On Waters of Thornton River, at Position 589.

Roads: 19 miles to Luray (nearest shipping point) over 2 miles of rough country road and 17 miles of macadam.

Soil: West and south slope. Sandy clay loam of good depth and fertility in the hollows but rather poor soil with outcrops of rocks on the ridges.

History of Tract and condition of timber: The timbered area of this tract has been cut since the tan bark was removed. A portion of the tract is field grazing and field cultivated. TIMBER: There is an open stand with some trees up to 30" DBH but most of the trees are small. The stand on 132 acres is estimated at -Poplar 46 M., Red Oak, 35 M., White Pine 23 M., Hickory 11 M., and Chestnut Oak 1 M., a total of 116 M.

Improvements: One 4 room frame and stone house, shingle roof, frame meat house, chicken house, tool house and shed, spring house; all in good condition.

Acreage and value of types:

Types	Acreage		Value per acre	Total Value
Slope:	108 $\frac{1}{4}$	@	\$3.00	\$324.75
Cove:				
Grazing Land:	12	@	10.00	120.00
Cultivated Land:	16	@	15.00	240.00
				<hr/> \$684.75
Orchard:				
Minerals:				
Value of Land: \$				
Value of Improvements: \$	520.00			520.00
Value of Orchard: \$				
Value of Minerals: \$				
Value of Timber: \$	348.00			348.00
Value of Wood: \$				<hr/> \$1552.75
Value per acre for tract: \$	11.39			

Incidental damages arising from the taking of this tract: \$ NONE

Geo. N. Perry

CLERK

99
Claim of Ms. Sarah Harrell, widow of John Harrell
In the Circuit Court of App County, Virginia, No. 149, At Law.
The State Commission on Conservation and Development of the State of Virginia, Petitioner, vs. Clifton L. Taylor et al \$37,400

acres
more or less, of land in App County, Virginia, Defendants.
The undersigned, in answer to the petition of the State Commission on Conservation and Development of the State of Virginia, and in response to the notice of condemnation awarded upon the filing of said petition and published in accordance with the order of the Circuit Court of App County, Virginia, asks leave of the Court to file this as his answer to said petition and to said notice.

My name is Ms. Sarah Harrell

My Post Office Address is Sperryville, Va

I claim a right, title, estate or interest in a tract or parcel of land within the area sought to be condemned, containing about 1.73 acres, on which there are the following buildings and improvements: 1 - 4 room - shingle roof dwelling - smoke house - new house

corn house with shed 2 sheds
This land is located about 1 1/4 miles from Nashington Virginia, in the Vermon Magisterial District of said County.

I claim the following right, title, estate or interest in the tract or parcel of land described above: (In this space claimant should say whether he is sole owner or joint owner, and if joint owner give names of the joint owners. If claimant is not sole or joint owner, he should set out exactly what right, title, estate or interest he has in or to the tract or parcel of land described above). See sample

The land owners adjacent to the above described tract or parcel of land are as follows:

North C. H. Brown & Joe Betty Brown

South S. G. Harrell

East H. L. Johnson & John Carter

West Lee Craig

I acquired my right, title, estate or interest to this property about the year 1919 in the following manner:

I took possession of it at death of my husband

I claim that the total value of this tract or parcel of land with the improvements thereon is \$ 2000. I claim that the total value of my right, title, estate or interest, in and to this tract or parcel of land with the improvements thereon is \$ 2000.

I am the owner of 0 acres of land adjoining the above described tract or parcel of land but lying outside the Park area, which I claim will be damaged by the proposed condemnation of lands within the Park area, to the extent of \$ 0.

(In the space below should be set out any additional statements or information as to this claim which claimant desires to make; and if practicable he should also insert here a description of the tract or parcel of land by metes and bounds).

Remarks: _____

(Continue remarks if necessary on the back).

Witness my signature (or my name and mark attached hereto) this 5 day of June, 1930.

STATE OF VIRGINIA, COUNTY OF App, To-wit:

The undersigned hereby certifies that S. G. Harrell Agt
the above named claimant personally appeared before him and made oath that the matters and things appearing in his above answer are true to the best of his knowledge and belief, this 5 day of June, 1930.

Charles H. Seeger
Clerk of the Court, or Special Investigator or Notary Public, or Justice of the Peace.

1880

to year

this

and things appearing in his above answer are true to the best of his knowledge and belief,
the above named claimant personally appeared before him and made oath that the matters
The undersigned hereby certifies that

STATE OF VIRGINIA, COUNTY OF

of 1880

To wit:

1880

Witness my signature (or my name and mark attached hereto) this day

(Should add any remarks if necessary on the back)

Remarks:

Description of the tract or parcel of land by metes and bounds, and if practicable he should also insert here a
this claim which claimant desires to make; and if practicable he should also insert here a

(In the space below should be set out any additional statements or information as to
posed condemnation of lands within the Park area, to the extent of \$

parcel of land not lying outside the Park area, which I claim will be damaged by the pro-
I am the owner of _____ acres of land adjoining the above described tract or

in and to this tract or parcel of land with the improvements thereon is \$ _____
on is \$ _____ I claim that the total value of my right, title, estate or interest

I claim that the total value of this tract or parcel of land with the improvements there-
on is \$ _____

the land owner adjacent to the above described tract or parcel of land are as follows:

following manner:
I acquired my right, title, estate or interest to this property about the year _____ in the

West _____ East _____ South _____ North _____

COUNTY---RAPPAHANNOCK
DISTRICT---PIEDMONT
AREA---160

#99 - Herrell, Mrs. Savilla

Acreage Claimed:

Value Claimed:

Location: On waters of Thornton River at Position 589.

Incumbrances, counter claims or laps: None known.

Soil: West and south slope. Andy clay loam of good depth and fertility in the hollows but rather poor soil with outcrops of rocks on the ridges.

Roads: 19 miles to Luray (nearest shipping point) over 2 miles of rough country road and 17 miles of Macadam.

History of Tract and condition of timber: The timbered area of this tract has been cut since the tan bark was removed. A portion of the tract is field grazing and field cultivated.
TIMBER: There is an open stand with some trees up to 30" DBH but most of the trees are small. The stand on 132 acres is estimated at Poplar 46M, Red Oak 35M, White Pine 23M, Hickory 11M, and Chestnut Oak 1M. A total of 116M valued at \$3.00 per M or \$348.00

Improvements: Consist as follows:-
House, frame and rock, 4 rooms, 14 x 16
1½ story with 14 x 16; shingle roof, 1-story
kitchen----- \$350.00
Meat house-frame, 10 x 10 (shingle roof)--- 25.00
Chicken house, frame, 10 x 10 (shingle roof) 25.00
Tool house, 10 x 12, with two 8 x 12 sheds
Shingle roof,----- 50.00
Spring house, 6 x 12, shingle roof----- 25.00
Total----- \$475.00

Value of land by types:

<u>Types</u>	<u>Acreage</u>	<u>Value Per Acre</u>	<u>Total Value</u>
Slope	132	\$3.00	\$396.00
FG	12	5.00	60.00
FC	16	15.00	240.00
	<u>160</u>		<u>\$696.00</u>

Total value of land-----	\$696.00
Total value of improvements	475.00
Total value of timber-----	348.00
Total value of tract-----	1519.00
Average value per acre----	9.50

County: Rappahannock
 District: Piedmont
 Area-- 160

#99-Herrell, Mrs. Savilla

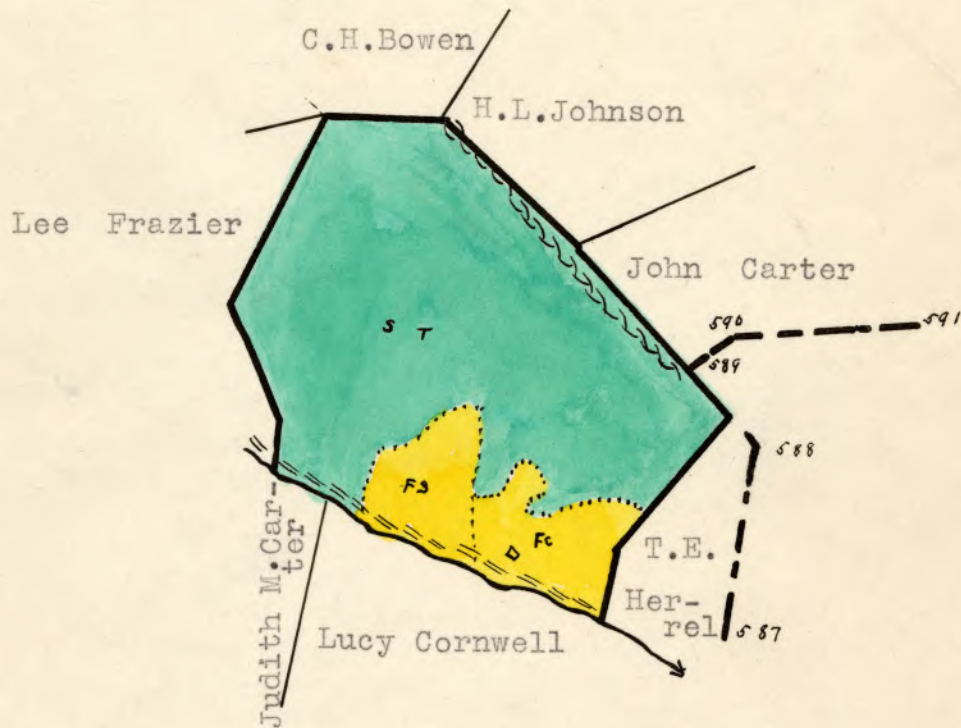

LEGEND:

Cove	Orchard
Slope	Grazing Land
Ridge	Tillable "
Scale - 1" = 20 Chains	