

NAME OF CLAIMANT

#362 - Roadcap, Virginia B. - Morris, J. F.

Number of Acres: 2-1/2

Location: Near positions #266 and #267.

Roads: Three and one-half miles fair dirt road to Grottoes.

Soil: Sandy clay, good depth, fair fertility, moderately rocky, gentle slopes, northwest exposure.

History of Tract and condition of timber: Small portion cleared many years ago, grazed since. Wooded area cut over repeatedly in past. Mixed oaks, some yellow pine 2" to 8" DBH.

Improvements:

None.

Acreage and value of types:

Types	Acreage		Value per acre	Total Value
Ridge:				
Slope:	2	@	\$5.00	\$10.00
Cove:				
Grazing Land:	-1/2	@	20.00	10.00
	<u>2-1/2</u>			<u>\$20.00</u>

Fields Restocking:

Cultivated Land:

Orchard:

Minerals:

Value of Land: \$ 20.00

Value of Improvements: \$

Value of Orchard: \$

Value of Minerals: \$

Value of Fruit: \$

Value of Timber: \$

Value of Wood: \$

Value per acre for tract: \$ 8.00

Incidental damages arising from the taking of this tract: \$ NONE.

Geo. N. Pen. CLERK. 67

124

County: Rockingham
District: Stonewall

County: Augusta
District: Middle River

#362- Virginia B. Roadcap & J. P. Morris. (Rockingham co.)

Acreage Claimed: Assessed 71 A. 150 P. Deed

Value Claimed: " \$290.00 "

Location: Near Positions #266 and #267.

Incumbrances, counter claims or laps: None known.

Soil: Sandy clay, good depth, fair fertility, moderately rocky, gentle slopes, northwest exposure.

Roads: Three and one-half miles fair dirt road to Grottoes.

History of tract and condition of timber: Small portion cleared many years ago, grazed since. Wooded area cut over repeatedly in past. Mixed oaks, some yellow pine 2" to 8" DBH. Estimated to cut an average of 3 cords fuelwood per acre valued at 50¢ per cord.

6 cords of fuelwooe @ 50¢ -- \$3.00.

Improvements: None.

Value of land by types:

Type	Acreage	Value per acre	Total Value
Pg	1	\$12.00	\$6.00
S	2	3.00	6.00
	<u>2 1/2</u>		<u>\$12.00</u>

Total value of land \$12.00

Total value of timber 3.00

Total value of tract \$15.00

Average value per acre \$6.00

	SUMMARY
Total value of tract (Augusta Co.)	- \$15.00
Total value of tract (Rockingham)	- 15.00
Total value ---	<u>\$30.00</u>
Average value per acre	\$6.00

1242

County: Rockingham
District: Stonewall

County: Augusta
District: Middle River

(Rockingham) #362 Roadcap, Virginia B., and
J.F. Morris

(Augusta) #3--

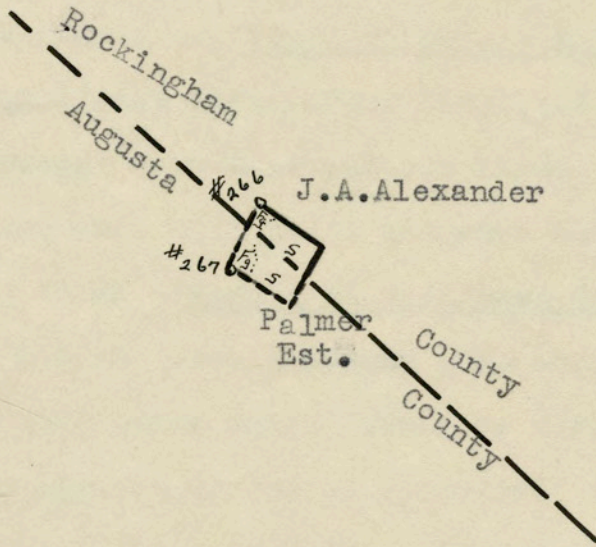

LEGEND:

Slope Grazing
Scale - 1" = 20 chains