

NAME OF OWNER

#97 - Wood, Wm. V.-Estate

Number of Acres: 125

Location: Swift Run. entirely within the park area.

Roads: On Spotswood Trail, 3 miles of hard surface to Elkton, nearest shipping point.

Soil: Sandy loam, slope type of fair depth and fertility, northwest exposure. The tillable land is fairly smooth, but has some smooth scattering rocks.

History of Tract and condition of timber: This tract has been heavily culled, the remaining stand consists of second growth chestnut oak, walnut, mixed oaks and some white and shortleaf pines.

Improvements: DWELLING---Frame 28x28', 6 rooms, porch 7x26', 2 story, fair condition. Foundation solid, cellar 14x28'. BARN----Frame, 24 x26x12', shingle roof, condition fair. HEN HOUSE---Frame, 16x16x12' unfinished---HEN HOUSE---Frame, 8x10x7', paper roof, condition fair. CIDER HOUSE----Frame, 26x26x12', Paper roof, fair condition. HEN HOUSE----Frame, 8x10x8', paper roof, fair condition. ---SHOP Frame, 16x22x10', paper roof, fair condition.

Acreege and value of types:

Types	Acreege		Value per acre	Total Value
Ridge:				
Slope: --	89	@	\$5.00	\$445.00
Cove:				
Grazing Land: --	10		15.00	150.00
Fields Restocking:				
Cultivated Land: --	24	@	27.50	660.00
Orchard: --	2	@	50.00	\$1255.00
				100.00
Minerals:				
Value of Land:	\$ 1255.00			
Value of Improvements:	\$ 1425.00			1425.00
Value of Orchard:	\$ 100.00			
Value of Minerals:	\$			
Value of Fruit:	\$			
Value of Timber:	\$ 92.00			92.00
Value of Wood:	\$ 356.00			356.00
Value per acre for tract:	\$25.82			\$3228.00

Incidental damages arising from the taking of this tract: \$ NONE

Geo. W. Pen: CLERK

County: Rockingham  
 District: Stonewall

#97 - William V. Wood

Acreage Claimed: Assessed 125.67 Deed only 119 A. of Record.

Value Claimed: " "

Location: Swift Run. Entirely within the Park area.

Incumbrances, counter claims, or laps: None known.

Soil: Sandy loam, slope type of fair depth of fertility, N. W. exposure. The fc. is fairly smooth, but has some smooth scattering rocks.

Roads: On Spotswood Trail, 3 miles of hard surface to Elkton, nearest shipping point.

History of tract and condition of timber: This tract has been heavily culled, the remaining stand consists of second growth, chestnut oak, walnut oak, mixed oaks, and some white and short leaf pines.

about 23,000 Bd. ft. on 89 acres @ \$4.00 per M.	\$92.00
356 cds. of fuel wood " 89 " @ 1.00 per cd.	356.00
	<u>\$448.00</u>

Improvements:

Dwelling, Frame 28x28, 6 rooms, porch 7x26, roof, 2 story, condition fair, foundation solid, cellar 14x20. Value -----	\$900.00
Barn, Frame 24x26x12, shingle roof, condition fair. -----	150.00
Hen house, Frame 16x16x12, unfinished	50.00
Hen house, Frame 8x10x7, paper roof, condition fair. -----	15.00
Cider house, Frame 26x26x12, paper roof, cond. fair. -----	200.00
Hen house, Frame 8x10x8, paper roof, cond. fair	15.00
Shop, Frame 16x22x10, paper roof, condition "	60.00
	<u>\$1390.00</u>

Value of land by types:

Type	Acreage	Value per acre	Total Value
Slope	89	\$8.00	\$712.00
Grazing	10	30.00	300.00
Tillable	34	30.00	720.00
Orchard	2	60.00	120.00
	<u>125</u>		<u>\$1732.00</u>

Total value of land \$1732.00  
 Total value of improvement 1390.00  
 Value of orchard 120.00

Tot

33

Total value of land	17	\$1732.00
Total value of improvements		1390.00
Value of timber		120.00
Total value of timber		448.00
Total value of tract		3690.00
Average value per acre		29.52

33

#97 - William V. Wood

County: Rockingham  
District: Stonewall

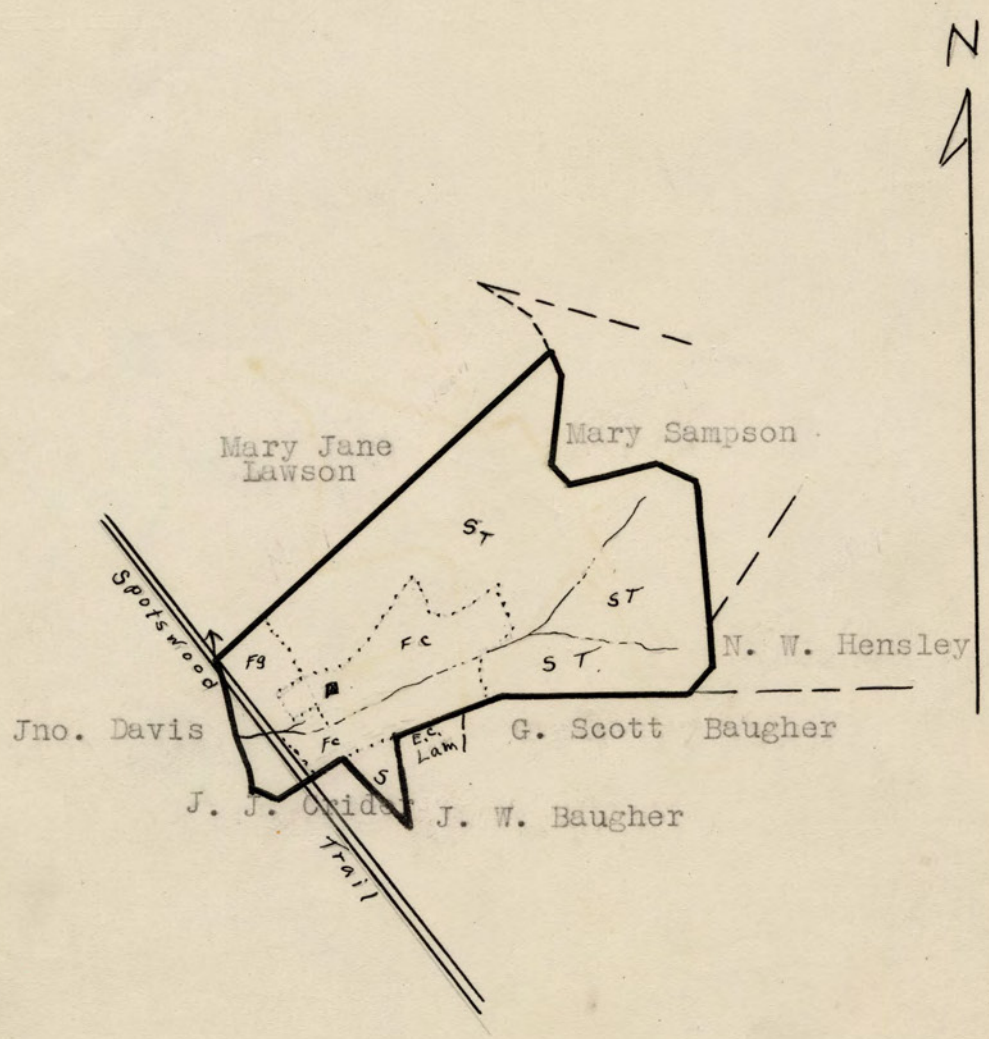

LEGEND  
 Slope - Grazing  
 Tillable - Orchard  
 Scale - 1" = 20 chains