

ROCKINGHAM COUNTY

NAME OF OWNER

#104 - Davis, C. A.

Number of Acres: 8

Location: -- Elk Run. Three miles southeast of Elkton, U. S. Positions

Roads:- 74 - 75 and 75-AA. Part outside Park.

--- Three miles county road to Elkton.

Soil: Sandy loam, slope type of fair depth and fertility, moderate slopes, free from rocks, northeast exposure.

History of Tract and condition of timber:

All saw timber removed, remainings stand consists of small oaks and pines, about three cords wood per acre. 24 cords wood.

Improvements:

None.

Acreage and value of types:

Types	Acreage	Value per acre	Total Value
Ridge:			
Slope:	8	\$5.00	\$40.00
Cove:			
Grazing Land:			
Fields Restocking:			
Cultivated Land:			
Orchard:			30.00
Minerals:			\$70.00

Value of Land: \$40.00

Value of Improvements: \$

Value of Orchard: \$

Value of Minerals: \$

Value of Fruit: \$

Value of Timber: \$

Value of Wood: \$ 30.00

Value per acre for tract: \$ 8.75

Incidental damages arising from the taking of this tract: \$ NONE.

Geo. H. Pen CLERK.

Claim of Charles Davis
In the Circuit Court of Potomac County, Virginia, No. _____, At Law.
The State Commission on Conservation and Development of the State of Virginia, Petitioner, vs. _____

more or less, of land in Potomac County, Virginia, Defendants.
The undersigned, in answer to the petition of the State Commission on Conservation and Development of the State of Virginia, and in response to the notice of condemnation awarded upon the filing of said petition and published in accordance with the order of the Circuit Court of Potomac County, Virginia, asks leave of the Court to file this as his answer to said petition and to said notice.

My name is Charles Davis

My post office address is Bealeton

I claim a right, title, estate or interest in a tract or parcel of land within the area sought to be condemned, containing about 114 acres, on which there are the following buildings and improvements: Dwelling 4 rooms granary
Beaksmith shop Pen house 2 acres orchard
60 acre cedar

This land is located about 7 miles from Elkton Virginia, in the Honewall Magisterial District of said County.

I claim the following right, title, estate or interest in the tract or parcel of land described above: (In this space claimant should say whether he is sole owner or joint owner, and if joint owner give names of the joint owners. If claimant is not sole or joint owner, he should set out exactly what right, title, estate or interest he has in or to the tract or parcel of land described above.)

Sole owner

The land owners adjacent to the above described tract or parcel of land are as follows:

North cf. M. Shifflett

South Wash. Stevens

East Ambrase Shifflett

West Big Survey

I acquired my right, title, estate or interest to this property about the year 1887 in the following manner:

I claim that the total value of this tract or parcel of land with the improvements thereon is \$ 5000.00. I claim that the total value of my right, title, estate or interest, in and to this tract or parcel of land with the improvements thereon is \$ 5000.00.

I am the owner of _____ acres of land adjoining the above described tract or parcel of land but lying outside the Park area, which I claim will be damaged by the proposed condemnation of lands within the Park area, to the extent of \$ _____.

(In the space below should be set out any additional statements or information as to this claim which claimant desires to make; and if practicable he should also insert here a description of the tract or parcel of land by metes and bounds).

Remarks: _____

(Continue remarks if necessary on the back).

Witness my signature (or my name and mark attached hereto) this 31st day of Aug, 1931.

STATE OF VIRGINIA, COUNTY OF Potomac, To-wit:

The undersigned hereby certifies that _____ the above named claimant personally appeared before him and made oath that the matters and things appearing in his above answer are true to the best of his knowledge and belief, this 31 day of Aug, 1931.

Geo. H. Ben
Clerk of the Court, or Special Investigator or Notary Public, or Justice of the Peace.

Claim of The Bank of Elkhorn, Inc.
In the Circuit Court of Rockingham County, Virginia, No. 1829, At Law.
The State Commission on Conservation and Development of the State of Virginia, Petitioner, vs. Chaudia Dawson et al.

more or less, of land in Rockingham County, Virginia, Defendants.
The undersigned, in answer to the petition of the State Commission on Conservation and Development of the State of Virginia, and in response to the notice of condemnation awarded upon the filing of said petition and published in accordance with the order of the Circuit Court of Rockingham County, Virginia, asks leave of the Court to file this as his answer to said petition and to said notice.

My name is The Bank of Elkhorn, Inc.

My post office address is Elkhorn, Va.

I claim a right, title, estate or interest in a tract or parcel of land within the area sought to be condemned, containing about 62.30 acres, on which there are the following buildings and improvements:

This land is located about _____ miles from Elkhorn, _____ Virginia, in the Lawrence Magisterial District of said County.

I claim the following right, title, estate or interest in the tract or parcel of land described above: (In this space claimant should say whether he is sole owner or joint owner, and if joint owner give names of the joint owners. If claimant is not sole or joint owner, he should set out exactly what right, title, estate or interest he has in or to the tract or parcel of land described above.)

I have a first deed of trust here on said land securing me in the sum of \$3,500.00 with interest

The land owners adjacent to the above described tract or parcel of land are as follows:

North _____

South _____

East _____

West _____

I acquired my right, title, estate or interest to this property about the year 1929 in the following manner:

by a deed of trust from C. S. Davis & wife to Geo. H. Harnsberger, Justice, dated April 29, 1929, & recorded in D. S. 144, p. 21

I claim that the total value of this tract or parcel of land with the improvements thereon is \$_____. I claim that the total value of my right, title, estate or interest, in and to this tract or parcel of land with the improvements thereon is \$_____.

I am the owner of _____ acres of land adjoining the above described tract or parcel of land but lying outside the Park area, which I claim will be damaged by the proposed condemnation of lands within the Park area, to the extent of \$_____.

(In the space below should be set out any additional statements or information as to this claim which claimant desires to make; and if practicable he should also insert here a description of the tract or parcel of land by metes and bounds).

Remarks: The undersigned is only interested in said land to the extent of said loan, and it asks that its rights to that extent be protected.

(Continue remarks if necessary on the back).

Witness my signature (or my name and mark attached hereto) this 12 day of February, 1930 City Elkhorn

STATE OF VIRGINIA, COUNTY OF Rockingham, To-wit: President

The undersigned hereby certifies that Geo. H. Harnsberger the above named claimant personally appeared before him and made oath that the matters and things appearing in his above answer are true to the best of his knowledge and belief, this 13th day of February, 1930.

Clerk of the Court, or Special Investigator or Notary Public, or Justice of the Peace.

2/13/30

Filed in the Clerk's Office
Rockingham County, Va.

FEB 1931

Clerk



37
County: Rockingham
District: Stonewall

#104 - C. A. Davis

Acreage Claimed: Assessed 77.53 Deed (no field sheet)
Value Claimed: " \$2100 "

Location: Elk Run. 3 miles southeast of Elkton, U. S.
 Positions 74- 75 and 75 A A. Part outside Park.

Laps: None known.

Soil: Sandy loam, slope type of fair depth and fertility,
 moderate slopes, free from rocks, northeast exposure.

Roads: 3 miles county road to Elkton.

History: All saw timber removed, remaining stand consists
 of small oaks and pines, about 3 cords wood per acre
 24 cords wood @ \$1.00 per cord \$24.00

Improvements:

Value of land by types:

<u>Type</u>	<u>Acreage</u>	<u>Value per acre</u>	<u>Total Value</u>
Slope	8	\$4.00	\$32.00

Total value of land \$32.00

Total value of improvements

Total value of timber 24.00

Total value of tract 56.00

Average value per acre 7.00

37

County: Rockingham
District: Stonewall

#104- Davis, C.A.

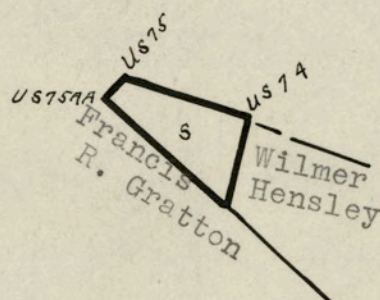
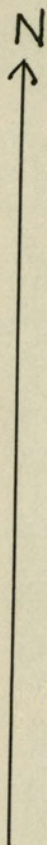

LEGEND:

Slope
Scale - 1" = 20 chains