

NAME OF CLAIMANT

143 - Collier, Florence E.

Number of Acres: 22

Location: Near Sandy Bottom.

Roads: Two miles of fair dirt road to Swift Run; thence four miles to Elkton.

Soil: Sandy clay, deep and fertile; gentle slopes with southwest exposure; very little rock.

History of Tract and condition of timber: The entire tract was cleared many years ago, grazed and cultivated since. Small portions were neglected, now grown up to briars, etc.

Improvements: No dwelling:
Barn: Log, 18x18x14', with shed, poor condition.
Hen house: Frame, 8x15x6', shingle roof, poor condition.
Corn house: Log, shingle roof, poor condition.

Acreage and value of types:

Types	Acreage		Value per acre	Total Value
Ridge:				
Slope:				
Cove:				
Grazing Land:	8	@	\$25.00	\$200.00
Fields Restocking:	1	@	15.00	15.00
Cultivated Land:	$\frac{13}{22}$	@	30.00	$\frac{390.00}{\$605.00}$

Orchard:

Minerals:

Value of Land: \$ 605.00 50.00

Value of Improvements: \$50.00

Value of Orchard: \$75.00

Value of Minerals: \$ 75.00

Value of Fruit: \$ \$730.00

Value of Timber: \$

Value of Wood: \$

Value per acre for tract: \$ 33.18

Incidental damages arising from the taking of this tract: \$ NONE.

Geo. N. Pinn
 _____ CLERK.

56

County: Rockingham
District: Stonewall

#143 - Collier, Florence E.

Acreage Claimed: Assessed Not Deed 22 A. 100 P.
Value Claimed: " " Not given.
" (1911)

Location: Near Sandy Bottom.

Incumbrances, counter claims or laps: None known.

Soil: Sandy clay, deep and fertile. Gentle slopes with southwest exposure; very little rock.

Roads: Two miles of fair dirt road to Swift Run; thence four miles to Elkton.

History of tract and condition of timber: The entire tract was cleared many years ago, grazed and cultivated since. Small portions were neglected, now grown up to briars, etc.

Improvements: No dwelling:

Barn: Log 18x18x14' with shed, poor condition --	\$50.00
Hen house: Frame 8x15x6', shingle roof, poor condition--	10.00
Corn house: Log, shingle roof, poor condition --	10.00
Orchard: 40 apple trees - 30 years old -- valued @	
\$1.50 per tree -----	60.00
	<u>\$130.00</u>

Value of land by types:

<u>Type</u>	<u>Acreage</u>	<u>Value per acre</u>	<u>Total Value</u>
Fg	8	\$15.00	\$120.00
Fc	13	20.00	260.00
Fr	<u>1</u>	6.00	6.00
	22		<u>\$386.00</u>

Total value of land \$386.00
 Total value of improvements 130.00
 Total value of tract \$516.00
 Average value per acre 23.45

2 checks

IN THE CIRCUIT COURT OF ROCKINGHAM COUNTY, VIRGINIA

The State Commission on Conservation
and Development of the State of Virginia

vs.

Cassandra Lawson Atkins, et als

This cause came on to be heard this 9 day of June, 1934,
on the papers formerly read, proceedings formerly had, the
exhibits filed and argument of counsel;

Upon consideration whereof, it appearing to the Court that
the tract of 120 acres of land, designated in this proceeding as
Tract No. 229, was condemned herein, and the amount of award therefor
fixed by the Commissioners is to-wit, \$1277.00, which sum, set out
in the judgment of condemnation, has heretofore been paid into
Court; and it further appearing to the Court that Herbert W. Wyant
has been appointed and qualified as Receiver of the Court in the
cause now pending therein of Russell G. Collier, et al vs. Iris
C. Baugher, et als, wherein said award of \$1277.00 is to be
administered under orders of the Court; it is therefore adjudged,
ordered and decreed that the Treasurer of Virginia do pay unto
Herbert W. Wyant, Receiver in said cause of Russell G. Collier et al
vs. Iris Collier Baugher, et als, the sum of \$1277.00, being the
amount in full ascertained to be due for said Tract No. 229, and
which is to be by said Receiver disbursed in accordance with the
orders of the Court, to be entered in said cause pending in said Court.

It is further ordered that said Receiver shall receipt for said
\$1277.00 and payment thereof certified to the Clerk of this Court
for appropriate entry thereof as required by law.

ent
HWB

20
207

56

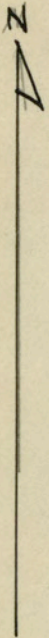

County: Rockingham
District: Stonewall

#143- Collier, Florence E.

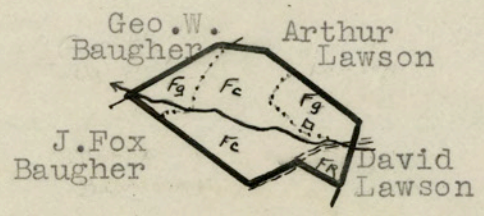

LEGEND:
 Grazing Tillable
 Fields restocking
 Scale - 1" = 20 chains