

#6-Chester Gap Orchard Co.

Acreage Claimed:

Value Ulaimed:

Examined by: Marsh, Stoneburner and Gilliam

Location: Head of right fork of Indian River.

Incumbrances, counter claims and baps: None known.

Roads: Woods roads lead to the apple orchard just outside the park boundary, and thence by a rough road about three miles to the State highway at Chester Gap. From there it is six miles to Front Royal, the nearest shipping point.

Soil: The soil is a sandy loam of fairly good depth and fertility, strewn with comparatively small rocks. The slopes are gentle.

History of tract and condition of timber: The bark was removed about 30 years ago, and practically all the merchantable timber has been cut except some scattered large red and white oaks and a few small chestnut oaks. Repeated fires in the past have done much damage to the reproduction. The timber consists of a few large and widely scattered red oaks of fair quality and an occasional smaller white oak.

Improvements: There are none.

Acreage and value by types:

Type:	Acreage:	Value Per A.	Total Value
Slope	84	\$2.00	\$168.00
Value per acre for land-	\$2.00		
Value of land-----		\$168.00	
Value of timber-153 M.ft.B.M. @ \$3.		399.00	
Value of tract-----		\$567.00	
Value per acre for tract-	\$6.75		

County: Rappahannock  
District: Wakefield

#6-Chester Gap Orchard Co.

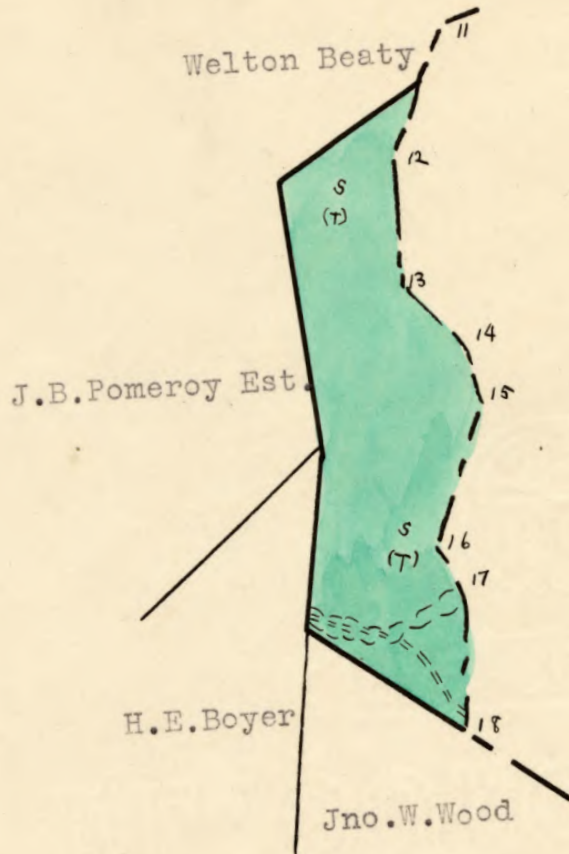
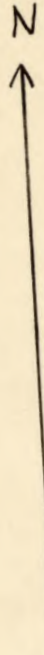

LEGEND:  
Cove      Orchard Land  
Slope      Grazing Land  
Ridge      Tillable Land  
Scale - 1" = 20 Chains