

NAME OF CLAIMANT

#249 - King, J. W.

Number of Acres: 70

Location: Between Mile Run and Two Mile Run near Rock Bar. This tract is partly inside and partly outside of the Park area

Roads: Two miles over county road to Island Ford.

Soil: Slope.

History of Tract and condition of timber: All merchantable timber has been removed from this tract.

Improvements:

None.

Acreage and value of types:

Types	Acreage	Value per acre	Total Value
Ridge:			
Slope:	70	\$5.00	\$350.00
Cove:			
Grazing Land:			
Fields Restocking:			
Cultivated Land:			
Orchard:			
Minerals:			262.00
Value of Land: \$	350.00		\$612.00
Value of Improvements: \$			
Value of Orchard: \$			
Value of Minerals: \$			
Value of Fruit: \$			
Value of Timber: \$			
Value of Wood: \$	262.00		
Value per acre for tract: \$	8.74		
Incidental damages arising from the taking of this tract: \$	None.		

Geo. H. Pen: CLERK 56

Claim of J. W. King
In the Circuit Court of Rockingham County, Virginia, No. 1829, At Law.
The State Commission on Conservation and Development of the State of Virginia, Petitioner, vs. Cassandra Lawson Atkins, et als., and 52,561 acres,

more or less, of land in Rockingham County, Virginia, Defendants.
The undersigned, in answer to the petition of the State Commission on Conservation and Development of the State of Virginia, and in response to the notice of condemnation awarded upon the filing of said petition and published in accordance with the order of the Circuit Court of Rockingham County, Virginia, asks leave of the Court to file this as his answer to said petition and to said notice.

My name is J. W. King

My post office address is Elkton, Va., R.#4,

I claim a right, title, estate or interest in a tract or parcel of land within the area sought to be condemned, containing about 45 or 50 acres, on which there are the following buildings and improvements:

This land is located about seven miles from Elkton, Virginia, in the Stonewall Magisterial District of said County.

I claim the following right, title, estate or interest in the tract or parcel of land described above: (In this space claimant should say whether he is sole owner or joint owner, and if joint owner give names of the joint owners. If claimant is not sole or joint owner, he should set out exactly what right, title, estate or interest he has in or to the tract or parcel of land described above.)

sole owner.

The land owners adjacent to the above described tract or parcel of land are as follows:

North O. D. Sellers

South Raines and Shifflett

East M. H. Harrison

West Raines and Shifflett

I acquired my right, title, estate or interest to this property about the year 1926 in the following manner:

by deed from Jno. W. Morrison, Special Commissioner, (or Trustee)

I claim that the total value of this tract or parcel of land with the improvements thereon is \$2,500.00. I claim that the total value of my right, title, estate or interest, in and to this tract or parcel of land with the improvements thereon is \$2,500.00.

I am the owner of 45 or 50 acres of land adjoining the above described tract or parcel of land but lying outside the Park area, which I claim will be damaged by the proposed condemnation of lands within the Park area, to the extent of \$(included in above \$2500.)

(In the space below should be set out any additional statements or information as to this claim which claimant desires to make; and if practicable he should also insert here a description of the tract or parcel of land by metes and bounds).

Remarks: the above land to be taken is enclosed by wire fencing, which I should like to remove, presuming that the fencing would not be of any use to the park area.

(Continue remarks if necessary on the back).

Witness my signature (or my name and mark attached hereto) this 17th day of February, 1931

STATE OF VIRGINIA, COUNTY OF Rockingham, To-wit:

The undersigned hereby certifies that J. W. King the above named claimant personally appeared before him and made oath that the matters and things appearing in his above answer are true to the best of his knowledge and belief, this 17th day of February, 1931.

Margaret Bowers, Deputy
Clerk of the Court, or Special Investigator or Notary Public, or Justice of the Peace.

County: Rockingham
District: Stonewall

#249 - J. W. King

Acreage Claimed: 45 or 50 Assessed 116.90 acres Deed (no field sheet)

Value Claimed: \$2500. # \$3010.00 " Area: 70 A.

Location: Between Mile Run, and two mile Run near Rock Bar. This tract is partly inside and partly outside of the park area.

Laps:

Soil: Slope.

Roads: 2 miles over county road to Island Ford.

History: All merchantable timber has been removed from this tract.

Improvements: None.

Timber: Fuel wood 350 cds. @ 75¢ per cd. ----- \$262.50

Value of land by types:

<u>Type</u>	<u>Acreage</u>	<u>Value per acre</u>	<u>Total Value</u>
Slope	70	\$4.00	\$280.00

Total value of land \$280.00

Total value of improvement

Total value of timber 262.00

Total value of tract 542.50

Average value per acre 7.75

#249- King, J. W.

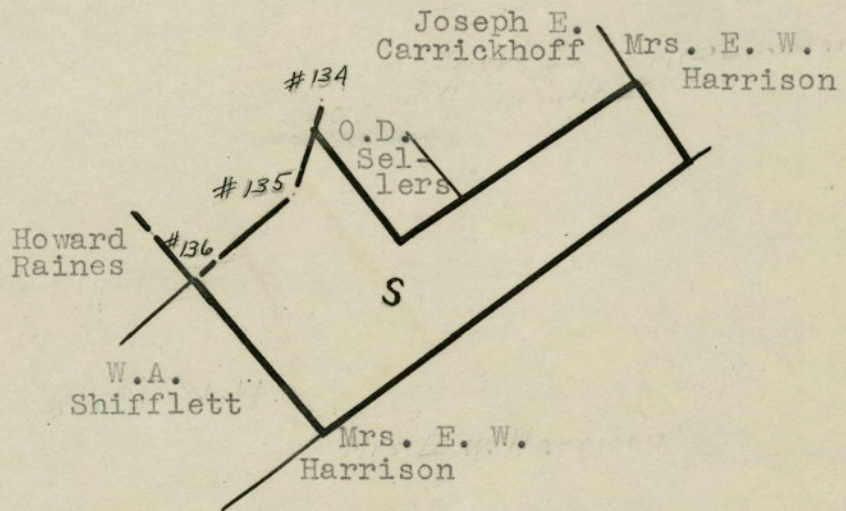
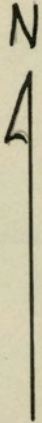

LEGEND:

Slope
Scale - 1" = 20 chains