

Rappahannock County
Wakefield District

NAME OF OWNER

#39 - Green, Barnett

Number of Acres: 40

Location: West slopes of Nixon's Arm, and southeast of the Peak.

Roads: Three miles ordinary country road to Flint Hill and 13 miles of macadam to Front Royal, the nearest shipping point.

Soil: Sandy clay loam. Slopes are medium steep and rocky near center of tract.

History of Tract and condition of timber: Completely cut over except for some scattered chestnut oak which were not cut when tract was operated for bark about 25 years ago. On the smooth slopes there is a young stand of oak, hickory, locust, yellow poplar and sassafras.

Timber: Chestnut oak bark, oak lumber and locust posts are the only merchantable products which can be cut from the tract at present.

Improvements: None.

Acreage and value of types:

Types	Acreage		Value per acre	Total Value
Slope:	40	@	2.50	\$100.00

Cove:

Grazing Land:

Cultivated Land:

Orchard:

Minerals:

Value of Land: \$

Value of Improvements: \$

Value of Orchard: \$

Value of Minerals: \$

Value of Timber: \$ 96.00

96.00

\$196.00

Value of Wood: \$

Value per acre for tract: \$ 4.90

Incidental damages arising from the taking of this tract: \$ NONE

Geo. H. Peni

CLERK

#39-Green, Barnett

Acreage Claimed:

Value Claimed:

Location: West slopes of Nixon's Arm, and southeast of the Peak.

Incumbrances, counter claims and laps: None so far as known.

Roads: Three miles ordinary country road to Flint Hill and 13 miles of macadam to Front Royal, the nearest shipping point.

Soil: Sandy Clay loam. Slopes are medium steep and rocky near center of tract.

History of tract and condition of timber: Completely cut over except for some scattered chestnut oak which were not cut when tract was operated for bark about 25 years ago. On the smooth slopes there is a young stand of oak, hickory, locust, yellow poplar and sassafras.

Improvements: None.

Timber: Chestnut oak bark, oak lumber and locust posts are the only merchantable products which can be cut from the tract at present. The estimated stand is as follows:

23 tons bark @ \$2.00	\$46.00
20 M. ft. saw-timber @ 2.50	50.00
	<u>\$96.00</u>

Acreage and value by types:

<u>Type</u>	<u>Acreage</u>	<u>Value per A.</u>	<u>Total Value</u>
Slope	40	\$2.00	\$80.00

Value of land----	\$80.00
" " Timber	96.00
" " Tract	<u>\$176.00</u>

Value per acre for tract---- \$4.40

#39-Green, Barnett

County: Rappahannock
District: Wakefield

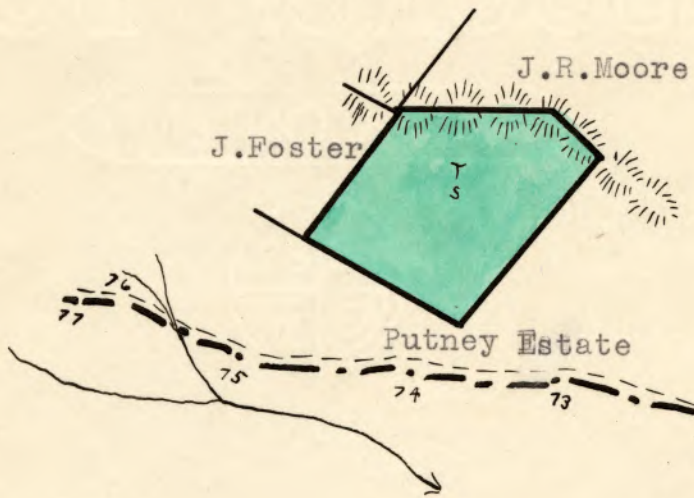

LEGEND:

- | | | |
|-------|---|---------------|
| Cove | — | Orchard |
| Slope | ■ | Grazing Land |
| Ridge | — | Tillable Land |
- Scale - 1" = 20 Chains