

## NAME OF CLAIMANT

#113 - Lawson, George S.

Number of Acres: 32

Location: Swift Run. Entirely within the Park area.

Roads: Spottswood Trail, hard surface,  $2\frac{3}{4}$  miles to Elkton, nearest shipping point.

Soil: Slope type, sandy loam, N.E. exposure, fairly thin. The tillable land on this tract has a fair depth of fertility and is level and fairly free from rocks.

History of Tract and condition of timber: The merchantable saw timber has been removed from this tract; the remaining stand consists of small oaks and some scrub pine.

IMPROVEMENTS: DWELLING---Frame, 12x29', 3 rooms, ceiled, metal roof, 1 story, condition, fair---occupied by owner. Spring water supply.---STABLE---Frame, 11x20x12', paper roof, condition fair. MEAT HOUSE:---Frame, 6x8x6', paper roof, condition fair.---HOG PEN---Improvements: Frame 4x10x5', condition fair.---CORN HOUSE ---Frame, 7x10x7', shingle roof, condition fair. HEN HOUSE ---Frame, 6x8x8', shingle roof, condition fair.

## Acreage and value of types:

Types	Acreage		Value per acre	Total Value
Ridge:				
Slope: --	24	@	\$5.00	\$120.00
Cove:				
Grazing Land:				
Fields Restocking: ----	2	@	15.00	30.00
Cultivated Land: ----	6	@	35.00	210.00
	<u>32</u>			<u>\$360.00</u>
Orchard:				
Minerals:				
Value of Land: \$	360.00			
Value of Improvements: \$	485.00			485.00
Value of Orchard: \$	50.00			50.00
Value of Minerals: \$				50.00
Value of Fruit: \$				
Value of Timber: \$				
Value of Wood: \$	50.00			
Value per acre for tract: \$	29.53			<u>\$945.00</u>

Incidental damages arising from the taking of this tract: \$ None

Geo. N. Brown CLERK



Claim of George S. Lawson  
In the Circuit Court of Rockingham County, Virginia, No. 1829, At Law.  
The State Commission on Conservation and Development of the State of Virginia, Petitioner, vs. Alessandra Atkins & others for the condemnation  
of 52.521 acres

more or less, of land in Rockingham County, Virginia, Defendants.  
The undersigned, in answer to the petition of the State Commission on Conservation and Development of the State of Virginia, and in response to the notice of condemnation awarded upon the filing of said petition and published in accordance with the order of the Circuit Court of Rockingham County, Virginia, asks leave of the Court to file this as his answer to said petition and to said notice.

My name is George S. Lawson

My post office address is Swift Run, Virginia

I claim a right, title, estate or interest in a tract or parcel of land within the area sought to be condemned, containing about 32 acres, on which there are the following buildings and improvements: dwelling house, poultry house, hog pen, stable and other buildings, garden, inclosed, new gates, all new woven wire fence with locust posts and here  
fruit trees, consisting of apples, peaches, grapes, and other fruit, with peach  
This land is located about 2 1/2 miles from Gettysburg Virginia, in the Stonewall Magisterial District of said County.

I claim the following right, title, estate or interest in the tract or parcel of land described above: (In this space claimant should say whether he is sole owner or joint owner, and if joint owner give names of the joint owners. If claimant is not sole or joint owner, he should set out exactly what right, title, estate or interest he has in or to the tract or parcel of land described above.)

as sole owner

The land owners adjacent to the above described tract or parcel of land are as follows:

North Daniel S. Davis and Ella Baughler

South John H. Davis and J. J. Linder

East State Highway No 17, Spottswood Trail

West George W. Baughler and the Baughler land

I acquired my right, title, estate or interest to this property about the year 1915 in the following manner:

By general warranty deed from George Linder and wife

I claim that the total value of this tract or parcel of land with the improvements thereon is \$ 1600.00 on this day. I claim that the total value of my right, title, estate or interest, in and to this tract or parcel of land with the improvements thereon is \$ 1600.00.

I am the owner of no acres of land adjoining the above described tract or parcel of land but lying outside the Park area, which I claim will be damaged by the proposed condemnation of lands within the Park area, to the extent of \$ -----.

(In the space below should be set out any additional statements or information as to this claim which claimant desires to make; and if practicable he should also insert here a description of the tract or parcel of land by metes and bounds).

Remarks: I beg leave to state further that I am about  
70 years old, and that have made arrangements to remain on  
the above mentioned tract of land as my home, and it  
has a greater value to me than a fair cash value.  
Also 2 acres of the above tract are taxed as commercial land  
(Continue remarks if necessary on the back).

Witness my signature (or my name and mark attached hereto) this 7 day of February, 1930.

STATE OF VIRGINIA, COUNTY OF Rockingham, To-wit:

The undersigned hereby certifies that George S. Lawson  
the above named claimant personally appeared before him and made oath that the matters and things appearing in his above answer are true to the best of his knowledge and belief, this 7 day of February, 1930.

A. E. Bryant, N. P.  
Clerk of the Court, or Special Investigator or  
Notary Public, or Justice of the Peace.

219/31



William of George Lawson

24

The State Commission on

Conservation and Development

of the State of Virginia

County, Virginia, Defendant.  
The State Commission on Conservation and Development of the State of Virginia, Petitioner,  
in the Circuit Court of Roanoke County, Virginia, No. 10,000, At Law.  
Plaintiff vs. Defendant.

My name is \_\_\_\_\_  
My post office address is \_\_\_\_\_  
I claim a right, title, estate or interest in a tract or parcel of land within the following  
described, containing about \_\_\_\_\_ acres, on which there are the following  
buildings and improvements: \_\_\_\_\_  
This land is located about \_\_\_\_\_ miles from \_\_\_\_\_  
Magisterial District of said County.

I claim the following right, title, estate or interest in the tract or parcel of land de-  
scribed above: (In this space claimant should say whether he is sole owner or joint owner,  
it joint owner give names of the joint owners. If claimant is not sole or joint owner,  
should set out exactly what right, title, estate or interest he has in or to the tract or  
parcel of land described above.) \_\_\_\_\_  
The land owners adjacent to the above described tract or parcel of land are as follows:  
North \_\_\_\_\_  
East \_\_\_\_\_  
West \_\_\_\_\_

I acquired my right, title, estate or interest to this property about the year \_\_\_\_\_ in the  
following manner: \_\_\_\_\_  
I claim that the total value of this tract or parcel of land with the improvements there-  
on is \$\_\_\_\_\_. I claim that the total value of my right, title, estate or interest  
in and to this tract or parcel of land with the improvements thereon is \$\_\_\_\_\_.  
I am the owner of \_\_\_\_\_ acres of land adjoining the above described tract or  
parcel of land but lying outside the Park area, which I claim will be damaged by the pro-  
posed condemnation of lands within the Park area to the extent of \$\_\_\_\_\_.  
(In the space below should be set out any additional statements or information as to  
this claim which claimant desires to make; and if practicable he should also insert here a  
description of the tract or parcel of land by name and number.) \_\_\_\_\_

Remarks: \_\_\_\_\_  
I declare under oath that the foregoing is true to the best of my knowledge and belief.  
Witness my signature or my name and mark attached hereto) this \_\_\_\_\_ day  
of \_\_\_\_\_, 1930.  
To-wit: \_\_\_\_\_

Filed in the Clerk's Office  
Roanoke County, Va.

FEB 1931

Clerk

Clerk of the Court or Special Investigator or  
Notary Public or Justice of the Peace



County: Rockingham  
District: Stonewall

#113 - Lawson Geo. S.

<u>Acres Claimed:</u>	32 A.	Assessed	30 A.	Deed	31.	$\frac{80}{160}$
<u>Value Claimed:</u>	\$1600.	"	\$180.00	"	(1914)	
			1.00		(1925)	
				Area:	35 A.	

Location: Swift Run. Entirely within the Park area.

Incumbrances, counter claims or laps: None known.

Soil: Slope type, sandy loam, N. E. exposure, fairly thin. The tillable land on this tract has a fair depth of fertility and is level and fairly free from rocks.

Roads: Spotswood Trail hard surface, 2 $\frac{1}{2}$  miles to Elkton, nearest shipping point.

History of tract and condition of timber: The merchantable saw timber has been removed from this tract the remaining stand consists of small oaks and some scrub pine. about 2 cds. fuel wood per A. on 27 acres @ \$1.00 per cd. \$54.00

<u>Improvements:</u>	<u>Dwelling</u> , Frame 12x29, 3 rooms, ceiled, metal roof, 1 story, condition fair, occupied by owner, spring water <del>supply</del> supply. Value -----	\$200.00
	<u>Stable</u> , Frame 11x20 x12, paper roof, condition fair. -----	65.00
	<u>Meat house</u> , Frame 6x8x6, paper roof, condition fair. -----	20.00
	<u>Hog pen</u> , Frame 4x10x5, condition fair -----	5.00
	<u>Corn house</u> , Frame 7x10x7, shingle roof, condition fair. -----	25.00
	<u>Hen house</u> , Frame 6x8x8, shingle roof, cond. fair. -----	10.00
		<u>\$325.00</u>

Value of land by types:

<u>Type</u>	<u>Acreage</u>	<u>Value per acre</u>	<u>Total Value</u>
Slope	24	\$10.00	\$240.00
Tillable	6	45.00	270.00
Fr.	2	10.00	20.00
	<u>32</u>		<u>530.00</u>

Total value of land	\$530.00
Total value of improvements	325.00
Total value of timber	54.00
Value of <del>12</del> fruit trees $\frac{1}{2}$ #.	30.00
Total value of tract	<u>\$939.00</u>

Average value per acre	27.34
------------------------	-------



#113 - Lawson, Geo. S.

County: Rockingham  
District: Stonewall

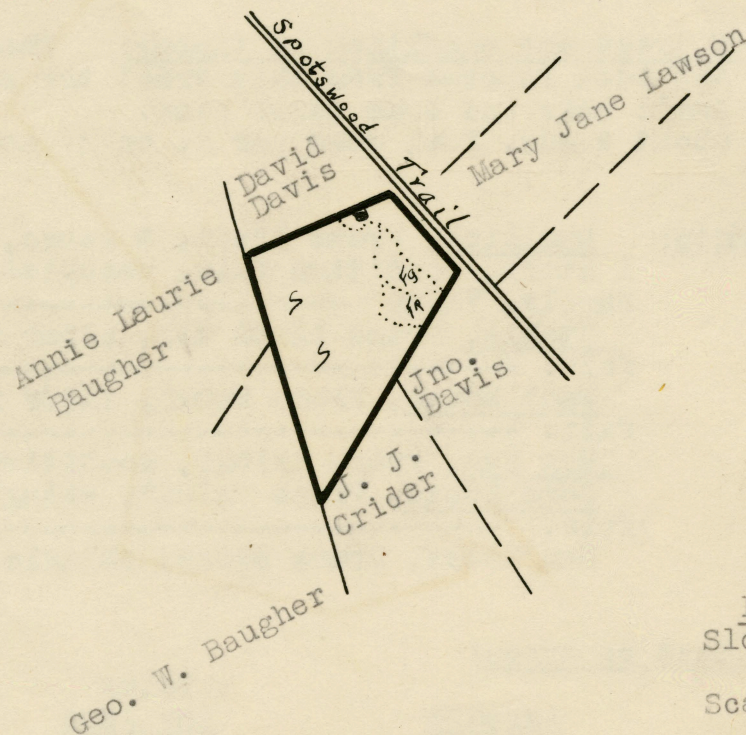

LEGEND  
Slope - Tillable  
Restocking  
Scale - 1" = 20 chains