

Rappahannock County
Wakefield District

NAME OF CLAIMANT

#21 - Robinson & Kern

Number of Acres: 74

Location:

Roads:

Soil: -- Clay loam with gradual slopes and exposure toward the east,
and reasonably good fertility.

History of Tract and condition of timber: -- Chestnut oak was cut for tan bark 25-30 years ago and some of the merchantable saw timber has been removed since. The stand now consists of scattered mixed oaks and a fair stand of second growth poplar.

Improvements: None

Acreage and value of types:

Types	Acreage	Value per acre	Total Value
Slope:	30	@ \$3.00	\$90.00
Cove:			
Grazing Land:	39	@ 15.00	585.00
			<hr/> \$675.00
Cultivated Land:			
Orchard:	5	@ 70.00	350.00
			<hr/> \$1025.00
Minerals:			168.00
			<hr/> \$1193.00
Value of Land: \$ 675.00			
Value of Improvements: \$			
Value of Orchard: \$ 350.00			
Value of Minerals: \$			
Value of Timber: \$ 168.00			
Value of Wood: \$			
Value per acre for tract: \$ 16.12			

Incidental damages arising from the taking of this tract: \$ NONE

Geo. N. Pen.

CLERK

21

Claim of Robertson & Kern (Harry R. Kern and Jas. E. Robertson)
In the Circuit Court of Rappahannock County, Virginia, No. 149, At Law.
The State Commission on Conservation and Development of the State of Virginia, Petitioner, vs. Clifton Aylor et als and 37,400 acres

more or less, of land in Rappahannock County, Virginia, Defendants.
The undersigned, in answer to the petition of the State Commission on Conservation and Development of the State of Virginia, and in response to the notice of condemnation awarded upon the filing of said petition and published in accordance with the order of the Circuit Court of Rappahannock County, Virginia, asks leave of the Court to file this as his answer to said petition and to said notice.

Our ~~My~~ names ~~is~~ are Harry R. Kern and Jas. E. Robertson

My Post Office Address is Winchester, Va

We ~~I~~ claim a right, title, estate or interest in a tract or parcel of land within the area sought to be condemned, containing about 74 acres, on which there are the following buildings and improvements:

This land is located about 6 miles from Flint Hill, Virginia, in the Wakefield Magisterial District of said County.

We ~~I~~ claim the following right, title, estate or interest in the tract or parcel of land described above: (In this space claimant should say whether he is sole owner or joint owner, and if joint owner give names of the joint owners. If claimant is not sole or joint owner, he should set out exactly what right, title, estate or interest he has in or to the tract or parcel of land described above).

Joint owners

The land owners adjacent to the above described tract or parcel of land are as follows:

North Jos. Reid, Jr. & Thos. Settle

South Geo. W. Bowling

East R. B. Rust, J. D. Haddox and W. A. Haddox

West Thos. H. Settle

We ~~I~~ acquired my right, title, estate or interest to this property about the year 1926 in the following manner:

By deed from J. M. Settle & wife to J. E. Robertson
and W. I. Eastham, and ~~from W. I. Eastham to Kern and Robertson~~ Harry R. Kern, and

We ~~I~~ claim that the total value of this tract or parcel of land with the improvements thereon is \$5550.00 ~~or~~ ^{our} We ~~I~~ claim that the total value of ~~my~~ ^{our} right, title, estate or interest, in and to this tract or parcel of land with the improvements thereon is \$ 5550.00 ~~of~~

I am the owner of _____ acres of land adjoining the above described tract or parcel of land but lying outside the Park area, which I claim will be damaged by the proposed condemnation of lands within the Park area, to the extent of \$_____.

(In the space below should be set out any additional statements or information as to this claim which claimant desires to make; and if practicable he should also insert here a description of the tract or parcel of land by metes and bounds).

Remarks: _____

(Continue remarks if necessary on the back).

Witness ^{our} my signature ~~(or my name and mark attached hereto)~~ this 7th day of July, 1930. Harry R. Kern J. E. Robertson

STATE OF VIRGINIA, COUNTY OF Warren, To-wit:

The undersigned hereby certifies that Harry R. Kern and J. E. Robertson the above named claimant personally appeared before him and made oath that the matters and things appearing in his above answer are true to the best of his knowledge and belief, this 7th day of July, 1930.

Emma N. Stokes
Clerk of the Court, or Special Investigator or Notary Public, or Justice of the Peace.

1890

the Wakarusa District of said County.

5-11-1909

The land owners adjacent to the above described tract or parcel of land are as follows:

North
Los Angeles
Los Angeles & Thos. Settle

Yours &c

County: Rappahannock
District: Wakefield

#21-Robinson & Kern

Acreage Claimed:

Value Claimed:

Examined by:

Location:

Incumbrances, counter claims or laps: None known.

Roads:

Soil: Clay loam with gradual slopes and exposure toward the east, and reasonably good fertility.

History of tract and condition of timber: Chestnut oak was cut for tan bark 25 - 30 years ago and some of the merchantable saw timber has been removed since. The stand now consists of scattered mixed oaks and a fair stand of second growth poplar.

Improvements: None.

Timber: The timbered area of this tract contains approximately 30 acres with an estimated total stand of 42 M.Bd. ft. valued at \$4. per M. or \$168.

Acreage and value by Types:

<u>Types:</u>	<u>Acreage</u>	<u>Value Per A.</u>	<u>Total Value</u>
Grazing	44	\$15.00	\$660.00
Slope	30	2.00	60.00
	<u>74</u>		<u>\$720.00</u>

Value of land- ----- \$720.00
" " timber- ----- - 168.00
 \$888.00

Value per acre: \$12.00

County: Rappahannock
District: Wakefield

#21-Robinson & Kern

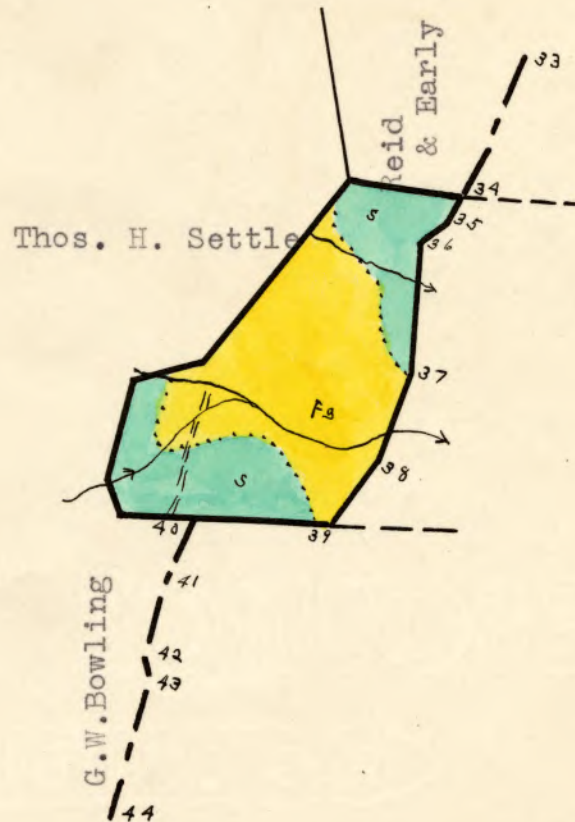

LEGEND:

Cove Orchard
Slope Grazing Land
Ridge Tillable Land
Scale - 1" = 20 Chains