

NAME OF CLAIMANT

#139 - Williams, H. A. & Lam, Mary  
 Now Annie Lawson

Number of Acres: 16

Location: Along Beldor Road.

Roads: One and one-half mile to Swift Run; thence four miles to Elkton.

Soil: Sandy clay, deep and fertile in the cultivated portions; moderate to gentle slopes; southeast and southwest exposure.

History of Tract and condition of timber: A large portion of the tract was cleared many years ago, grazed and cultivated since. The wooded area has been cut over repeatedly in the past. The present stand consists of mixed oaks and white pine.

Improvements:  
 (See reverse side)

Acreeage and value of types:

Types	Acreeage		Value per acre	Total Value
Ridge:				
Slope:	2	@	\$5.00	\$10.00
Cove:				
Grazing Land:	$\frac{14}{16}$	@	35.00	$\frac{490.00}{\$500.00}$
Fields Restocking:				
Cultivated Land:				
Orchard:				800.00
Minerals:				75.00
Value of Land:	\$500.00			
Value of Improvements:	\$ 800.00			$\frac{10.00}{\$1385.00}$
Value of Orchard:	\$ 75.00			
Value of Minerals:	\$			
Value of Fruit:	\$			
Value of Timber:	\$			
Value of Wood:	\$ 10.00			
Value per acre for tract:	\$ 86.56			

Incidental damages arising from the taking of this tract: \$ NONE.

*Geo. S. Pennington* CLERK.

NAME OF CLAIMANT

IMPROVEMENTS: Dwelling: Log and frame, 18x26', kitchen 11x18x8', 4 rooms, porch 6x17', metal roof, brick flues, 1 1/2 story, ceiled, fair condition, occupied by owner, spring, solid foundation.  
 Barn: Frame 26x35x15', paper roof, good condition.  
 Granary: Log, 12x15x12', shingle roof, fair condition.  
 Hog pen: Log 6x12x4', metal roof.  
 Hen house: Frame, 8x12x8', shingle roof, fair condition.  
 Corn house: Log, 7x10x8', shingle roof.

Roads: One and one-half mile to Swift Run; thence four miles to Nixton.

Soil: Sandy clay, deep and fertile in the cultivated portions; moderate to gentle slopes; southeast and southwest exposure.

History of Tract and condition of timber: A large portion of the tract was cleared many years ago, grazed and cultivated since. The wooded area has been cut over repeatedly in the past. The present stand consists of mixed oaks and white pine.

Improvements:

(See reverse side)

Acreage and value of types:

Types	Acreage	Value per acre	Total Value
Ridge:			
Slope:	2	\$5.00	\$10.00
Cove:			
Grazing Land:	14/18	\$25.00	490.00
Fields Restocking:			500.00
Cultivated Land:			
Orchard:			800.00
Minerals:			75.00
Value of Land:			10.00
Value of Improvements:			800.00
Value of Orchard:			75.00
Value of Minerals:			
Value of Fruit:			
Value of Timber:			
Value of Wood:			10.00
Value per acre for tract:			\$25.55

Incidental damages arising from the taking of this tract: \$ NONE.

5-3

County: Rockingham  
District: Stonewall

#139 - H. A. Williams & Mary V. Lam.

Acreage Claimed: Assessed 15 A. 96 P. Deed 15 A. 136 P.

Value Claimed: " \$360.00 " (1922) \$1188.95

Location: Along Beldor road.

Incumbrances, counter claims or laps: None known.

Soil: Sandy clay, deep and fertile in the cultivated portions; moderate to gentle slopes; southeast and southwest exposure.

Roads: One and one-half mile to Swift Run; thence four miles to Elkton.

History of tract and condition of timber: A large portion of the tract was cleared many years ago, grazed and cultivated since. The wooded area has been cut over repeatedly in the past. The present stand consists of mixed oaks and white pine. Estimate to cut 12 cords of fuelwood per acre valued @ 50¢ per cord. 24 cords of fuelwood valued @ 50¢ -- \$12.00.

Improvements:

<u>Dwelling:</u> Log and frame 18x26', kitchen 11x18x8', 4 rooms, porch 6x17', metal roof, brick flues, 1½ story, ceiled, fair condition, occupied by owner, spring, solid foundation -	\$500.00
<u>Barn:</u> Frame 26x35x15', paper roof, good condition -	250.00
<u>Granary:</u> Log 12x15x12', shingle roof, fair condition-	75.00
<u>Hog pen:</u> Log 6x12x4', metal roof, ----	5.00
<u>Hen house:</u> Frame 8x12x8', shingle roof, fair condition-	20.00
<u>Corn house:</u> Log 7x10x8', shingle roof, --	5.00
<u>Orchard:</u> 22 fruit trees, fair condition, valued @ \$1.50 per tree, for trees only ---	33.00
	<u>\$888.00</u>

Value of land by types:

Type	Acreage	Value per acre	Total Value
Slope	2	\$3.00	\$6.00
Fg	14	40.00	560.00
	<u>16</u>		<u>566.00</u>

Total value of land	\$566.00
Total value of improve ments	888.00
Total value of timber	12.00
Total value of tract	<u>1466.00</u>
Average value per acre	91.62

53

#139 H. A. Williams & Mary V. Williams

County: Rockingham  
District: Stonewall

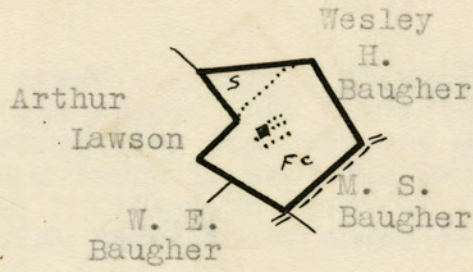
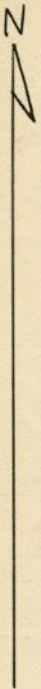

LEGEND  
 Slope - Grazing  
 Scale - 1" = 20 chains