

NAME OF CLAIMANT

#262 - Gibson, J. J. & F.

Number of Acres: 10

Location: One mile south of Big Run on Port Republic Road.

Roads: This tract is entirely within the Park area.  
Four miles to Island Ford over county road.

Soil: Sandy loam of medium depth and fertility.

History of Tract and condition of timber: This tract of land is all in cultivation and appears to be an average type of soil for this locality.

Improvements: Dwelling: Frame, 14x20', 3 rooms, kitchen 12x12', paper roof, brick flues, 1 1/2 story, ceiled, fair condition, occupied by owner, well water supply, solid foundation, cellar 7x7', stone wall.  
Stable: Frame, 11x13', paper roof, fair condition.  
Corn house: Frame, 6x7', paper roof, poor condition.  
Hen house: Frame, 7x11', paper roof, fair condition.  
Buggy shed: 14x14', poor condition.

Acreage and value of types:

Types	Acreage	Value per acre	Total Value
Ridge:			
Slope:			
Cove:			
Grazing Land:			
Fields Restocking:			
Cultivated Land:	10 @	\$25.00	\$250.00
Orchard:			
Minerals:			
Value of Land:	\$ 250.00		265.00
Value of Improvements:	\$ 265.00		
Value of Orchard:	\$ 25.00		25.00
Value of Minerals:	\$		\$540.00
Value of Fruit:	\$		
Value of Timber:	\$		
Value of Wood:	\$		
Value per acre for tract:	\$ 54.00		

Incidental damages arising from the taking of this tract: \$ None.

*Geo. H. Pen*: CLERK



Claim of James J. Gibson

In the Circuit Court of Rockingham County, Virginia, No. 1829, At Law.  
The State Commission on Conservation and Development of the State of Virginia, Petitioner, vs. Bassandra Lawson Adkins, et als, and 52,561 acres

more or less, of land in Rockingham County, Virginia, Defendants.  
The undersigned, in answer to the petition of the State Commission on Conservation and Development of the State of Virginia, and in response to the notice of condemnation awarded upon the filing of said petition and published in accordance with the order of the Circuit Court of Rockingham County, Virginia, asks leave of the Court to file this as his answer to said petition and to said notice.

My name is James J. Gibson

My post office address is Elkton Va RFD

I claim a right, title, estate or interest in a tract or parcel of land within the area sought to be condemned, containing about 10 acres, on which there are the following buildings and improvements: Dwelling 30' x 20' with 4 rooms  
1 stable, 1 poultry house & excellent never failing well. All  
of 10 A under fence

This land is located about 4 miles from Island Ford Virginia, in the Stonewall Magisterial District of said County.

I claim the following right, title, estate or interest in the tract or parcel of land described above: (In this space claimant should say whether he is sole owner or joint owner, and if joint owner give names of the joint owners. If claimant is not sole or joint owner, he should set out exactly what right, title, estate or interest he has in or to the tract or parcel of land described above.)

I am sole owner along with my wife with fee simple title

The land owners adjacent to the above described tract or parcel of land are as follows:

North Clarene Cupp

South Big survey

East Big survey

West Clarene Gibson

I acquired my right, title, estate or interest to this property about the year 1920 in the following manner:

By purchase from Frank Greyer & wife

I claim that the total value of this tract or parcel of land with the improvements thereon is \$1500. I claim that the total value of my right, title, estate or interest, in and to this tract or parcel of land with the improvements thereon is \$1500.

I am the owner of none acres of land adjoining the above described tract or parcel of land but lying outside the Park area, which I claim will be damaged by the proposed condemnation of lands within the Park area, to the extent of \$none.

(In the space below should be set out any additional statements or information as to this claim which claimant desires to make; and if practicable he should also insert here a description of the tract or parcel of land by metes and bounds).

Remarks: I think that I am entitled to an amount of money if invested would yield in interest an amount I am annually receiving from said property.

(Continue remarks if necessary on the back).

Witness my signature (or my name and mark attached hereto) this 11th day of Feb, 1930.

STATE OF VIRGINIA, COUNTY OF Rockingham, To-wit:

The undersigned hereby certifies that James J. Gibson the above named claimant personally appeared before him and made oath that the matters and things appearing in his above answer are true to the best of his knowledge and belief, this 11th day of Feb, 1930.

[Signature]  
Clerk of the Court, or Special Investigator or Notary Public, or Justice of the Peace.

2/11/31







County: Rockingham  
District: Stonewall

#262- J. J. & F. Gibson

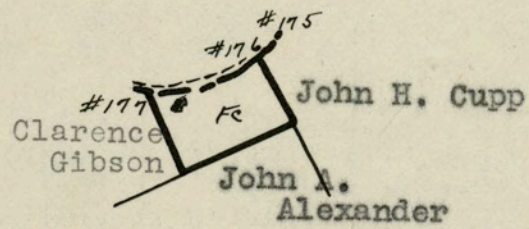

LEGEND:

Tillable  
Scale - 1" = 20 chains