

#268 J. P. Jenkins et al.

Acreage Claimed: Assessed 10 DEED 10

Value Claimed: " "

Examined by: W. H. S.

Location: On west side of Broad Run about one mile south of Hazel River. Partly within the Park area.

Incumbrances, counter claims or laps: None so far as known.

Soil: Sandy loam of medium depth and fertility. Surface rocky and steep. Cannot be cultivated under present economic condition.

Roads: Approximately three miles to F. T. Valley. Pass over an unimproved dirt road.

History of tract and condition of timber: This area has been covered with forest growth for many years. All merchantable saw timber and tanbark has been removed. Nothing remains but an uneven stand of hardwoods suitable only for fuel wood which is estimated at 15 cords for the entire tract.

Improvements: None.

Value of land by type:



<u>Type</u>	<u>Acreage</u>	<u>Value per acre</u>	<u>Total Value</u>
Cove	1.5	8.00 8.33	12.00 12.50
Total value of land		12.50 12.00	
Total value of improvements			
Total value of timber 15 cds. @ 50¢		7.50	
Total value of tract		20.00	
Average value per acre		10.00	

County: Rappahannock
District: Hampton

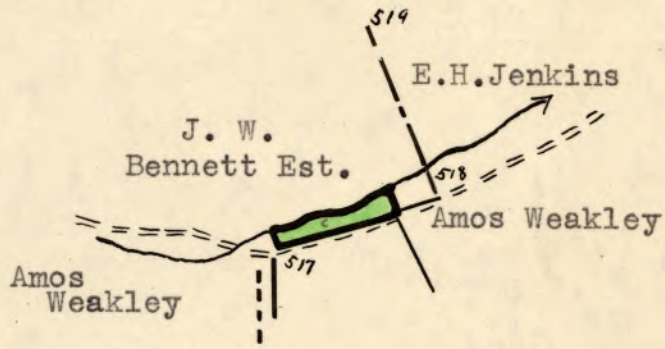
#268 Jenkins, J. P. - et al



LEGEND:

Cove  Orchard
Slope  Grazing Land
Ridge  Tillable Land
Scale - 1" = 20 chains

NAME OF CLAIMANT

268 - Jenkins, J. P. Et al

Number of Acres: $1\frac{1}{2}$

Location: On west side of Broad Run about one mile south of Hazel River.
Partly within the Park area.

Roads: Approximately three miles to F. T. Valley. Pass over an unimproved dirt road.

Soil: Sandy loam of medium depth and fertility. Surface rocky and steep.
Cannot be cultivated under present economic condition.

History of Tract and condition of timber: This area has been covered with forest growth for many years. All merchantable saw timber and tanbark has been removed. Nothing remains but an uneven stand of hardwoods suitable only for fuel wood which is estimated at 13 cords for the entire tract.

Improvements: None.

Acreage and value of types:

Types	Acreage	Value per acre	Total Value
-------	---------	----------------	-------------

Slope:

Cove:	$1\frac{1}{2}$	\$5.00	\$7.50
-------	----------------	--------	--------

Grazing Land:

Cultivated Land:

Orchard:

Minerals:

Value of Land: \$7.50

Value of Improvements: \$

Value of Orchard: \$

Value of Minerals: \$

Value of Timber: \$12.50

Value of Wood: \$

Value per acre for tract: \$ 13.33

Total value \$20.00

Incidental damages arising from the taking of this tract: \$ NONE

Geo. H. Pen

CLERK